

Quick Sharing Device

- 1 Invite friends to register & login by installing the App “DophiGo”.
- 2 The device owner can share it by choosing “Account invitation” or “QR code invitation” when clicking the sharing button in the App.

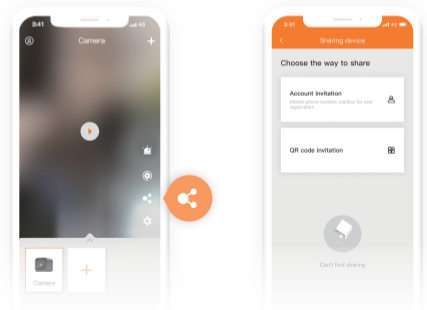

Installation Instruction

If you need to install the device, please make sure the wall is thick enough beforehand.

- 1 **Install the installation base**
Choose a clean flat surface, ensure the front part of installation base facing up towards you and then fix it to the wall with a screw.
- 2 **Install Device**
Put the device to be attached on the installation base and adjust its angle by driving the device upwards with the installation base.



Note

- Only supports 2.4 GHz Wifi, please make sure the wifi is 2.4 GHz WiFi on your phone’s connection before adding camera.
 - Max support TF card with 128G of FAT32 file system.
 - Under the recording cycle, camera will overwrite the earliest video automatically when TF card is full.
 - Please do not expose the device to high temperature/high humidity or lots of dust/smoke and other harsh environment on your installation, otherwise it is likely to be damaged.
 - The App of “DophiGo” and firmware will upgrade occasionally, please update it yourself online if you get a notice from the system.
- Please refer to the “Help and Feedback” of the App for more reference.

Limited Material or Element Identification table

Limited Material or Element Identification	Name of Parts			
	Shell	Circuit board	Package	Accessories
(Pb)	o	o	o	x
(Hg)	o	o	o	o
(Cd)	o	o	o	o
(Cr(VI))	o	o	o	o
(PBB)	o	o	o	o
(PBDE)	o	o	o	o

“o” indicates that the content of the toxic and hazardous substance in all homogeneous materials of the component is below the limit specified in the SJ/T11364 standard.
 “X” indicates that the content of the toxic and hazardous substance in at least one homogeneous material of the component exceeds the limit specified in the SJ/T11364 standard.
 The “x” shown in this table indicates that it has used EU RoHS exemptions for certain hazardous substances in specific applications.

After-Sale Support

- I. Warranty term**
The camera warranty applies only to product failure due to non-human causes during the warranty period.
It covers as below:
- 1.7 Days Return Policy**
we offer a full refund or replacement upon receipt of the invoice if any quality problems are found within 7 days after purchase.
- 2.15 Days Replacement Policy**
we offer replacement with a similar product due to quality problems found within 15 days after purchase.
- 3.1 Year Manufacture’s Warranties**
we offer maintenance services on any product for quality problems found within 1 year after purchase.

- II .Non-Warranty Policies**
THESE WARRANTIES DO NOT APPLY TO:
- 1.Products with no warranty certificate sold by third parties or products that exceed the valid warranty period.
 - 2.Damages caused by improper usage,improper maintenance or disassembly without manufacturer’s authority.
 - 3.Damages caused by force majeure.
 - 4.Color fading and cosmetic wear during usage of the product.
 - 5.Products with missing or unmatchable barcode.