

Operation Manual

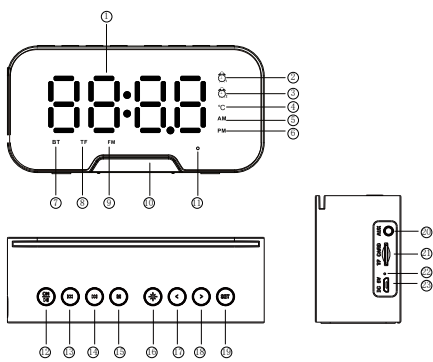

Bluetooth Speaker With Clock FM

FUNCTIONAL BUTTONS OPERATION



- ① LED Screen
- ② Alarm clock 1
- ③ Alarm clock 2
- ④ °C: Temperature Indicator
- ⑤ AM:AM = morning
- ⑥ PM: PM=afternoon
- ⑦ Bluetooth Music Playing Indicator
- ⑧ TF:TF Card Music Playing Indicator
- ⑨ FM:FM radio Playing Indicator
- ⑩ Phone Holder
- ⑪ MIC for Hands Free Phone Call
- ⑫ : Pause/Play/ON/OFF
- ⑬ : Previous / Volume down
- ⑭ : Next / Volume up
- ⑮ M: Mode
- ⑯ : Adjust Screen Brightness
- ⑰ <:Decreasing
- ⑱ >:Increasing
- ⑲ SET:Set
- ⑳ AUX:AUX in /line in Socket
- ㉑ TF CARD: TF Card Slot
- ㉒ Battery Charge Indicator
- ㉓ DC 5V:Micro USB Charging Port

1

- Button “ ” (Play/Pause/Power on/off):Press to play or pause the music while it is playing; Press and hold the button to start or switch off the speaker. Under FM mode, press it for FM automatic station search.
- Button “ ” (Last Song/Volume Down): Under Music mode:press for last song , press and hold for volume down. Under FM mode, press it for previous station.
- Button “ ” (Next Song/Volume UP):Under Music mode:press for next song , press and hold for volume up. Under FM mode, press for next station.
- Button “ M ” :For playing mode: Bluetooth mode,music mode for Micro SD card audio playing, FM mode, AUX mode and clock mode. Press for different modes playing. Under clock mode, press for switching the clock in 12 H or 24 H format. And under 12-hour mode, PM or AM indicator will be lit. AM = morning, PM=afternoon. For example: 8 PM.
- Button “ ” : press to adjust the 3-levels screen brightness, press and hold to turn on or turn off the screen.
- Button “ < ” :press to adjust the time for clock and alarm clock.
- Button “ > ” :press to adjust the time for clock and alarm clock.
- Button “ SET ” :press to switch the clock/alarm clock display, press and hold to enter clock/alarm clock setting mode.
- Micro USB Charging Port: Plug the USB charge cable included into the charge port and connect the adapter or other power sources to charge the speaker. Before use the speaker, please fully charge it.
- Battery Charge Indicator: Use the Micro USB charge cable to recharge the speaker, when it is charging, the red LED indicator will light on. Once charging completed, red light off.
- Phone Holder:Pull out the holder and put your mobile phone on it, then you can enjoy music or movie.

BLUETOOTH AUDIO PLAYING

- Press and hold the button “ ” to turn on the speaker and it will enter the Bluetooth mode.
- Check your Bluetooth devices like mobile phone and make sure Bluetooth ready for connection.
- Search the device listed on your phone, find device name: D-88 or G-10 and then connect it. Once paired, then you can play music on your phone.

Hand free call: Under the Bluetooth mode, press the button “ ” to answer or hang up, press and hold the button “ ” to reject calls.

2

PHONE HOLDER

Pull out the holder and put your mobile phone on it, then you can enjoy music or movie.

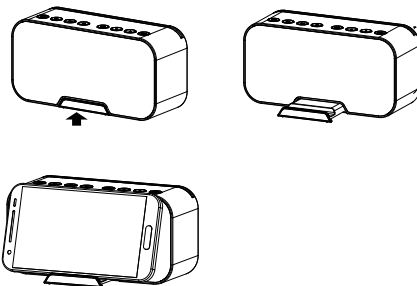

SPECIFICATIONS

Bluetooth version: 5.0	Output Power: 3W THD=10%
Frequency Response: 80Hz-20KHz	SNR: ≥65dB
Radio Frequency: 87.5MHz-108MHz	Distortion: <0.5%
Temperature range: -30°C—50°C	Speaker: 4Ω/3W
Display Dimmer: 3-Level	Item Weight: 0.32kg

Battery: 3.7V 1400mAh lithium battery

Size W x D x H:131*46*69mm

Battery Life

Built-in Rechargeable Battery: 3.7V 1400mAh lithium battery

Playing Time: Approx. 3-6 hours(Playing volume)

Charging Time: Approx. 3-4 hours

Stand by : Approx. 200 hours

6

TF CARD MODE

- Use a micro SD card and copy MP3 music or other audio files into the card, and insert to the slot of speaker.
- Press and hold the button “ ” to turn on the speaker.
- Press the button “ M ” for TF card mode to enjoy the music.

FM RADIO

- Press and hold the button “ ” to turn on the speaker.
- Press the button “ M ” for the FM Radio mode.
- Press the button “ ” for FM auto searching, FM icon flashes during searching, and saved in channels sequence P01, P02, P03..... If the search channels is in progress, press the “ ” to stop.
- After the search is completed, it automatically jumps to channel P01, FM icon lights on. Press the button “ ” or “ ” to switch channels, press and hold the button “ ” or “ ” to decrease or increase the volume.

Note: Before use the FM function, please insert the micro USB charge cable into the speaker charging socket, as the cable serve as FM radio antenna, if not plug in the cable, FM will be without signal.

AUX IN

- Press and hold the button “ ” to turn on the speaker.
- Press the button “ M ” for the AUX mode.
- Plug into the 3.5mm audio cable (Aux Cable not include) and connect to other audio players to play music or other audio files.

3

CLOCK SETTING

- When the clock is displayed, press the button “ SET ” to cancel “ ” 1 icon and “ ” 2 icon.
- Press and hold the button “ SET ” and enter clock setting. When the hour number flashes, press the button “ < ” or “ > ” to adjust the hour number.
- Continue to press the button “ SET ”, the minutes number flashes, press the button “ < ” or “ > ” to adjust the minute number.
- Finally, press the button “ SET ”, exit setting and save it.

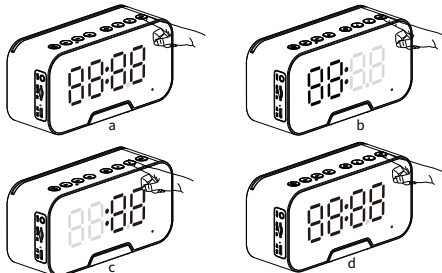

ALARM CLOCK SETTING

- Turn ON/OFF Alarm Clock:** Press the button “ SET ”, “ ” 1 icon always bright means only turn on the alarm clock 1. Continue press the button “ SET ”, “ ” 2 icon always bright means only turn on the alarm clock 2. Continue press the button “ SET ”, “ ” 1 icon and “ ” 2 icon always bright means turn on the alarm clock 1 and alarm clock 2. Finally, press the button “ SET ” to turn off these two alarm clocks, there will no “ ” on screen.
- Alarm Clock 1 Setting**
 - Press the button “ SET ”, “ ” 1 icon indicator lights on and time display is in static state press.
 - Hold the the button “ SET ” enter alarm clock 1 setting. When the hour number flashes, press the button “ < ” or “ > ” to adjust the hour number.
 - Continue to press the button “ SET ”, the minutes number flashes, press the button “ < ” or “ > ” to adjust the minute number.
 - Continue to press the button “ SET ” and then press the button “ < ” or “ > ” to choose ringing from L-1 to L-5.
 - Finally, press the button “ SET ” to exit setting and save it.

4

3. Alarm Clock 2 Setting

- Alarm Clock 2 Setting : Press the button “ SET ”, “ ” 2 icon indicator lights on and time display is in static state press.
- Hold the the button “ SET ” enter alarm clock 2 setting. When the hour number flashes, press the button “ < ” or “ > ” to adjust the hour number.
- Continue to press the button “ SET ”, the minutes number flashes, press the button “ < ” or “ > ” to adjust the minute number.
- Continue to press the button “ SET ” and then press the button “ < ” or “ > ” to choose ringing from L-1 to L-5.
- Finally, press the button “ SET ” to exit setting and save it.

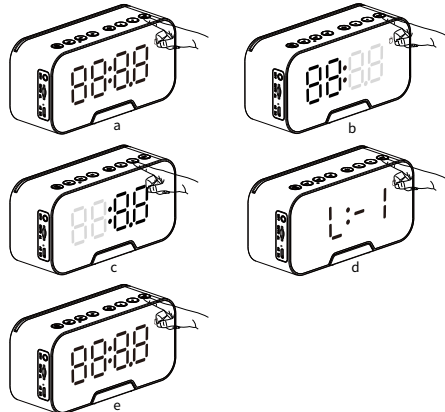

TEMPERATURE DISPLAY

Under the clock mode, the temperature is displayed every 10 seconds.



5

ACCESSORIES

- 1 x Speaker
- 1 x User Manual
- 1 x Micro USB Charging Cable

NOTES

- Please READ the user manual carefully before using this product and keep the it for future reference.
- Please wipe the LED screen with lens cloth gently to avoid scratching the surface.
- Connection: Bluetooth, up to 16G Micro SD card, 3.5 line-in Aux Cable, 87.5-108MHz.
- Built-in rechargeable battery, this device can be charged from mobile phone adaptor or computer. When the speaker prompts tone battery low, please charge the speaker. If do not use it, please turn it off. If you do not use it for a long time, please charge it within 2-3 months to protect the battery.
- When the speaker is malfunction, please insert and press the “RESET” button built in the AUX socket, use some tools like straighten clip.

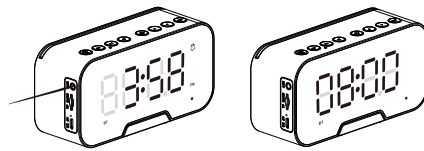

7