

# R6

## 用户手册 User Manual

V 1.0

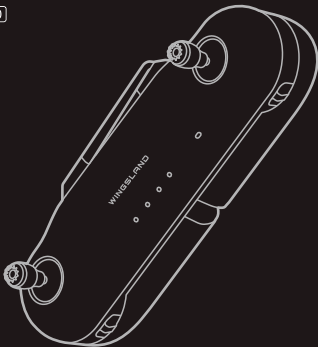

## WINGSLAND

本手册主要介绍R6遥控器的各项功能和如何控制飞行器  
The R6 remote controller user manual includes main functions  
and brief operation introduction.

# 1. 概述

R6采用了手柄可收纳设计,轻巧便携,手柄折叠后体积为:165x58x70mm(长x宽x高),圆弧流线型外观,圆润舒适,拉伸式手柄可固定移动设备。内置1500mAh容量的高聚合物锂电池,最长工作时间约为90分钟。

## 1.1 遥控器部件名称

闭合状态

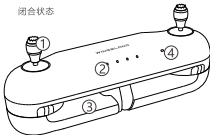

### ① 左摇杆/右摇杆

默认情况下为美国手操控模式,可在APP通用设置选项里切换成日本手控制模式。

### ② 电源指示灯

显示当前遥控器电量。

### ③ 手柄

拉伸后安装移动设备。

### ④ WiFi连接状态指示灯

提示WiFi信号连接状态。

### ⑤ 天线

传输飞行控制信号和图传信号。

### ⑥ 拍照/视频(右键)

实现拍照或视频录制功能。

### ⑦ USB接口

用于给遥控器进行充电。

### ⑧ 自动起飞/降落(左键)

控制飞行器进行自动起飞、降落操作。

### ⑨ 复位键

遥控器开机,等待约30秒,WiFi自动完成启动后,利用尖细工具按压此复位按键,待遥控器WiFi指示灯慢闪4到6次熄灭后,再重启遥控器即可完成遥控器WiFi复位。

展开状态

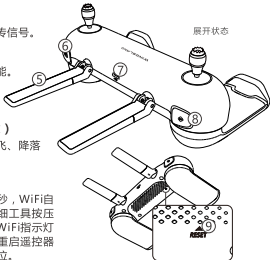

## 1.2 遥控器充电

按照下图连接方式连接遥控器和电源。请确保遥控器在关机状态下进行充电。充电过程中，遥控器面板上最左边的电量指示灯常亮表示正在充电。电池充满电后，该指示灯熄灭。请拔下电源和Micro-USB线。

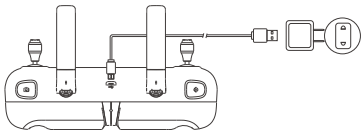

遥控器充电时的标准输入电压为5V---1A，请选择合适的电源适配器。遥控器完成充满电需要约120分钟。（可以使用相应规格的移动电源充电）

## 1.3 查看遥控器电量

电量指示灯	当前电量
● ○ ○ ○ ○	电量非常低，请及时充电
● ● ○ ○ ○	电量低，请注意使用时间
● ● ● ○ ○	电量足
● ● ● ● ○	电量充足

## 2. 操作使用

### 2.1 开机/关机

当遥控器处于收纳状态下，将两个手柄向外掰开至90°位置，即可开启遥控器电源。遥控器发出短震，表示正常启动。

开机状态下，将一个或两个手柄折叠收回遥控器底部，可关闭遥控器电源。

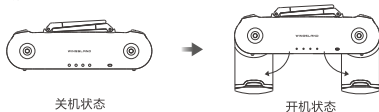

### 2.2 安装移动设备

用移动设备的边框，顶住拉伸手柄握柄处，向外推动握柄至合适位置，确保移动设备已稳定放置。

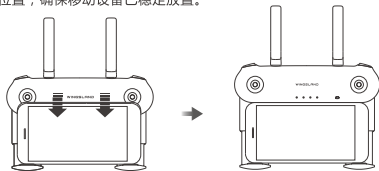

## 2.3 遥控器天线

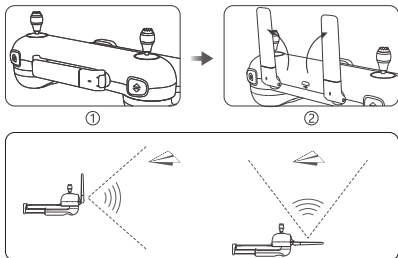

飞行过程中可调整天线，确保飞行器处于最佳通信范围

### 2.4.1 R6遥控器与S6飞行器对频连接操作说明：

#### 1. 移动设备与R6遥控器WiFi连接

开启遥控器电源和飞行器电源，在移动设备上选择R6遥控器上对应的WiFi网络，默认的WiFi名称格式为：wingslandR6\_rc\_XXXXXX，密码为：wingsland。连接成功后，在移动设备端打开S6 APP。



- ❶ 如移动设备未找到R6遥控器WiFi网络，请在遥控器开机，等待约30秒，WiFi自动完成启动后，利用尖细工具按压复位按键，待遥控器WiFi指示灯慢闪4到6次熄灭后，再重启遥控器即可完成遥控器WiFi复位，再进行WiFi连接。

## 2. APP与飞行器连接

点击"GO开始航拍"进入主界面。在“通用设置”选项，选择“连接设置”选项，选择对应飞行器的WiFi名称，输入密码：wingsland，点击"设置"按钮。设置成功后APP提示重启遥控器，按提示要求重启遥控器。

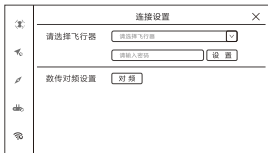

## 3. 重启后WiFi自动对频

遥控器重启后，一分钟左右遥控器会自动与飞行器进行对频。连接成功后，遥控器“WiFi连接状态指示灯”常亮，APP界面出现画面，即可用遥控器对飞行器进行操作控制，此后不需要再次对频即可使用。

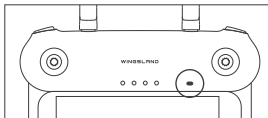

WiFi连接状态指示灯

## 2.4.2 R6遥控器与M5飞行器对频连接操作说明：

### 1. 移动设备与R6遥控器WiFi连接

开启遥控器电源和飞行器电源，在移动设备上选择R6遥控器上对应的WiFi网络，默认的WiFi名称格式为:wingslandR6\_rc\_XXXXXX，密码为:wingsland。连接成功后，在移动设备端打开M5 APP。



- ❗ 如移动设备未找到R6遥控器WiFi网络，请在遥控器开机，等待约30秒，WiFi自动完成启动后，利用尖细工具按压复位按键，待遥控器WiFi指示灯慢闪4到6次熄灭后，再重启遥控器即可完成遥控器WiFi复位，再进行WiFi连接。

### 2. APP与飞行器连接

点击“GO开始航拍”进入主界面。在“通用设置”选项，选择“连接设置”选项，选择对应飞行器的WiFi名称，输入密码:wingsland，点击“设置”按钮。设置成功后APP提示重启遥控器，按提示要求重启遥控器。

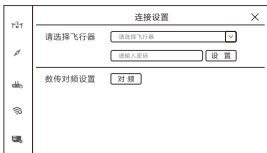

### 3. 重启后WiFi自动对频

遥控器重启后，一分钟左右遥控器会自动与飞行器进行对频。连接成功后，遥控器“WiFi连接状态指示灯”常亮，APP界面出现画面，即可用遥控器对飞行器进行操作控制，此后不需要再次对频即可使用。

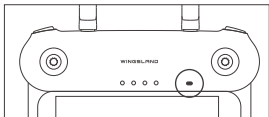

WiFi连接状态指示灯

### 4 遥控器数传对频

当需要进行遥控器和飞行器的对频操作时，请按照以下步骤进行操作：

1. 先开启遥控器，再开启飞行器。
2. 等待初始化完成后，同时按住遥控器顶部的左右按键，长按3秒，WiFi连接状态指示灯快速闪烁，表示正在进行自动对频。
3. 对频成功后，飞行器尾灯由交替快闪转变成交替慢闪状态。如对频失败，请重复上述操作。



### 2.4.3 R6遥控器与X1飞行器对频连接操作说明：

#### 1 遥控器数传对频

当需要进行遥控器和X1飞行器的对频操作时，请按照以下步骤进行操作：

1. 先开启遥控器，再开启飞行器。
2. 等待初始化完成后，同时按住遥控器顶部的左右按键，长按3秒，WiFi连接状态指示灯快速闪烁，表示正在进行自动对频。
3. 对频成功后，飞行器前置蓝色信号灯长亮。如对频失败，请重复上述操作。

### 2.5 起飞/降落

#### 起飞：

长按左键3秒，飞行器自动起飞到一定高度悬停待命。

---

① 室内环境自动起飞高度为1.2米，室外环境自动起飞高度为2.5米。

---

#### 降落：

飞行器准备降落后，长按左键3秒，飞行器开始自动降落。降落前，请确保飞行器下方无障碍物遮挡。

也可使用APP上的起飞/降落图标实现一键起飞/降落功能。

### 2.6 一键返航(仅支持S6.M5)

按住遥控器右键3秒，飞行器将根据设定的返航高度，朝返航点返航降落。不同飞行器的返航高度设定不一样，可查看对应飞行器用户手册进行了解。

## 2.7 拍照/视频

### 拍照：

短按右键，拍摄一张照片，APP界面会出现“拍照”提示。

### 视频：

连续短按两次右键，开始视频录制，APP界面上会显示录制时长，再次连续短按两次右键，停止录制。

## 2.8 校准遥控器

如果飞行过程中，摇杆控制方向时总是出现偏移，导致飞行器无法定点悬停，可以尝试通过以下方式进行摇杆校准：

1. 校准前，请确保所有摇杆处于中间位置。同时按住遥控器的左、右按键，然后开启遥控器，遥控器面板上的4个电量指示灯同时慢闪，表示遥控器进入到校准状态，此时松开左右按键。
2. 沿着一个方向将摇杆来回旋转，推动所有通道的摇杆达到最大电量位置。直至电量指示灯常亮，表示校准完成。

还可连接移动设备，在APP界面上选择摇杆校准功能，遥控器进入到校准状态。按照上述方法进行校准。

---

 如果电量指示灯快速闪烁，表示校准失败，请按照上述方式重新进行校准。

---

### 电池安全使用注意事项

1. 遥控器为内置锂电池供电，请勿将遥控器放置于高温场所，充电时请远离可燃物。
2. 请勿过度放电，电池电量过低时请及时充电，防止电池过放。
3. 遥控器适宜室温存储，干燥环境最佳。确保剩余30%-50%电量保存。

4. 如果因电池漏液，并接触眼睛和皮肤，请立刻用大量清水冲洗，并寻求医疗帮助。
5. 在低温和高温环境中，电池的电量将受到一定影响。请谨慎使用。

## 遥控器规格参数

工作频率	图传：2.4GHz(数字)，遥控：5.8GHz
等效全向辐射功率(EIRP)	FCC：≤26 dBm CE：≤20 dBm
遥控器尺寸	折叠：165x58x70mm（长x宽x高）
	展开：165x97x70mm（长x宽x高）
可搭载移动设备尺寸	最小：130x60x9mm（长x宽x高）
	最大：165x84x9mm（长x宽x高）
重 量	220g
电池容量	1500mAh
工作时间	约90分钟
最佳工作环境温度	5°C-40°C
工作电流/电压	5V---1A
接口类型	Micro USB

# 1 Overview

R6 is a portable and practical remote controller with folding design and extended mobile device holder. The top standard joysticks and ergonomic handle design will make your remote precise and mastered. R6 remote controller equips with a capacity of 1500 mAh Li-Po battery and max operating time is 90 minutes.

## 1.1 Diagram

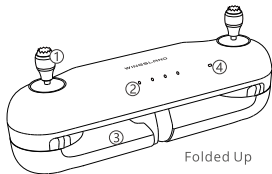

### ① Left/Right Joystick

The default control mode is Mode 2. Mode 1 and Mode 2 can be switched under general setting in wingsland fly APP.

### ② Battery Indicator

Real-time battery level indicating.

### ③ Handle

Extended grip for mounting mobile devices.

### ④ WiFi Indicator

Real-time WiFi signal level indicating.

Extended

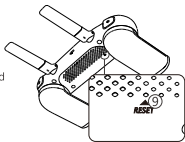
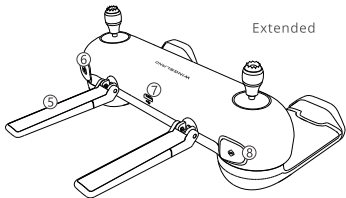

**⑤ Antenna**

Transmit flight control signal and WiFi live-view signal.

**⑥ Photo/Video (right button)**

Shutter for taking photo/video.

**⑦ USB Port**

Powering the remote controller.

**⑧ AutoTakeoff/Landing (left button)**

Command the aircraft auto takeoff/landing.

**⑨ Reset Button**

Power on the remote controller, wait for 30 seconds and after the WiFi is linked up, use a pin tool to press the reset key. The WiFi indicator will flash 4 to 6 times, then restart the remote controller to finish the reset of the WiFi.

## 1.2 Charging the Battery

Power the remote controller by using the Micro-USB and connect to a suitable power source. Ensure that the Remote controller is power off when charging. The indicator which locates in the leftmost will light on as the remote controller is charging. The remote controller is fully charged when this indicator turn off. Then detach the Micro-USB cable from the port.

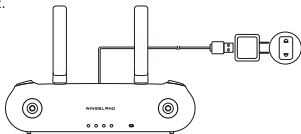

Please connect to a 5V $\overline{\text{---}}$ 1A standard voltage power source to charge the R6. A fully charging takes around 120 minutes. ( You can use the potable source for charging. )

## 1.3 Battery Indicator

Indicator	Current Battery Level
● ○ ○ ○	Please Recharge the Battery
● ● ○ ○	Attention to Battery Level
● ● ● ○	High Battery Level
● ● ● ●	Fully Charged

## 2 Operation

### 2.1 Power On/Off

#### Power off:

Fold one or two holder arms to powering off the remote controller.

#### Power on:

Unfold two holder arms out to 90 degrees to powering on the remote controller. A short vibrations indicates the remote controller is powered on.

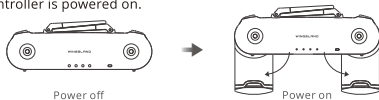

### 2.2 Mounting your Mobile Device

After unfold two holder arms out, extend the holder grips and adjust the position. Place and make sure the entire mobile device is seated in the mobile device holder.

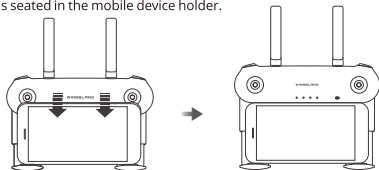

- ! Maximum mobile device size supported: 165x84x9(mm). Minimum mobile device size supported: 130x60x9(mm).

## 2.3 Remote Controller Antenna

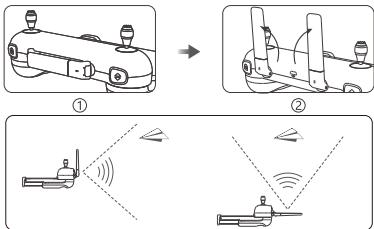

Make sure the aircraft and the remote are in the optimal transmission range by adjust the antennas.

### 2.4.1 Instructions of connecting the R6 to S6:

#### 1. Connect the R6 with your mobile device

Power on the R6 and aircraft, choose the R6 WiFi name: wingslandR6\_rc\_XXXXXX, connect with the password: wingsland. Open the S6 App after linked up.

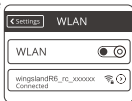

- ❗ If cannot find the R6 WiFi name on your device, wait for 30 seconds after R6 powered on, then use a pin tool to press the reset key at the bottom of it. The blue indicator will flash 4 to 6 times, then restart the R6 to finish the reset of the WiFi.



## 2. Connect the App with the aircraft

Go the General Settings, find the WiFi Settings, choose your S6 drone WiFi name, type in the correct password: wingsland, tap the setting button to finish. Then restart the R6 as instructed.

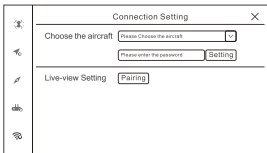

## 3. Automatically connect the R6 to the aircraft.

After restart the R6, wait for about 60 seconds for automatic pairing to the aircraft. The blue indication will shine up after successful pairing, and the live view come out on App. Then you could control the drone by R6. Afterward, you don't need to repeat pairing.

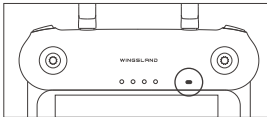

WiFi Indicator

## 2.4.2 Instructions of connecting the R6 to M5:

### 1. Connect the R6 with your mobile device

Power on the R6 and aircraft, choose the R6 WiFi name: wingslandR6\_rc\_XXXXXX, connect with the password: wingsland. Open the M5 App after linked up.

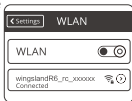

- ❗ If cannot find the R6 WiFi name on your device, wait for 30 seconds after R6 powered on, then use a pin tool to press the reset key at the bottom of it. The blue indicator will flash 4 to 6 times, then restart the R6 to finish the reset of the WiFi.

### 2. Connect the App with the aircraft

Go the General Settings, find the WiFi Settings, choose your M5 drone WiFi name, type in the correct password: wingsland, tap the setting button to finish. Then restart the R6 as instructed.

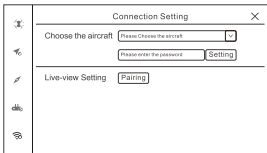

### 3. Automatically connect the R6 to the aircraft.

After restart the R6, wait for about 60 seconds for automatic pairing to the aircraft. The blue indication will shine up after successful pairing, and the live view come out on App. Then you could control the drone by R6. Afterward, you don't need to repeat pairing.

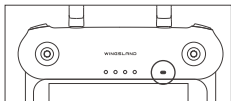

WiFi Indicator

### 4. Connect the Remote Controller

Perform the following steps for connecting the R6 and your aircraft:

1. Power on the R6 first, then power on the aircraft.
2. Hold the two buttons on the R6 at same time for 3 seconds, when the WiFi indicator is blinking shows the R6 is connecting to the aircraft.
3. The taillight of the aircraft from alternating flash into alternating slowly flashing shows the connection is successful, if fail, please repeat the above steps.

#### **2.4.3 Instructions of connecting the R6 to X1:**

Connect the Remote Controller

Perform the following steps for connect the R6 and your aircraft:

1. Power on the R6 first, then power on the x1 aircraft.

2. Hold the two buttons on the R6 at same time for 3 seconds, when the WiFi indicator is blinking shows the R6 is connecting to the aircraft.
3. Two blue solid LED lights on the forearms of aircraft indicates the connection is successful, if fail, please repeat the above operations.

## 2.5 Takeoff/Landing

### Takeoff:

Hold the left button for 3 seconds to active the feature. The aircraft will automatically hover up and stabilize.

---

 Takeoff altitude: Indoor 1.2m, Outdoor 2.5m.

---

### Landing:

Hold the left button for 3 seconds, the aircraft will automatically perform the landing. Check the landing area condition and make sure no obstacle under the aircraft. Also can tap take off/Landing on the App to auto take off/landing.

## 2.6 Auto Return-to-Home (only support for S6&M5)

Hold the right button for 3 seconds, the aircraft will fly back to the home point at a preset altitude. Different aircrafts have different preset RTH altitude, for more information please refers to the aircraft user manual.

## 2.7 Photo / Video

### Photo:

Click the right button once to take one photo. A successful prompt will be displayed in wingsland FLY flying interface.

## Video:

Double-click the right button to start taking a video. Double-click the right button again to complete a video taking.

## 2.8 Remote Controller Calibration

During the flight, if joysticks are offset from the directions and the aircraft cannot hover in place, you can calibrate the joysticks by following steps:

1. Before the calibration, please make sure all joysticks are in the middle position. Hold the left and right button at once, then power on the remote controller. If the 4 battery indicators are all flashing, that means the remote controller is in the calibration mode, and release the left and right button.
2. Keep rotate the joysticks in one direction and to maximum position. After the battery indicators are solid on, it means the calibration is successful.

You can also calibrate the remote controller through the app. Choose the remote controller calibration feature in the main interface of the app, and then follow the above step 2 to finish the calibration.

- 
- ❗ If the battery indicators flash rapidly, it means the calibration is failed, please recalibrate again follow the above steps.
- 

## Battery Usage Safety Notice

1. The R6 is powered by integrated lithium battery, please do not store the R6 in a high temperature environment. Keep the R6 away from the inflammable during the charging.
2. Please charge the R6 when the battery level is low, and avoid to over discharge the battery.

3. The R6 should be stored in normal room temperature and dry environment, make sure the battery have 30%-50% power level when you store the R6.
4. If found the battery leakage, do not contact with skins and eyes. If you do contact, immediately rinse with plenty of water and seek medical help.
5. Avoid to use the R6 in a too low or too high temperature, the battery level will be affected.

## Specifications

Operating Frequency	Live-View: 2.4GHz(Digital),Remote: 5.8GHz
Transmitter Power(EIRP)	FCC: ≤26 dBm CE: ≤20 dBm
Dimensions	Folded: 165x58x70(mm)
	Unfolded: 165x97x70(mm)
Adapted Mobile Device Size	Minimum: 130x60x9(mm)
	Maximum: 165x84x9 (mm)
Weight	220g
Battery Capacity	1500mAh
Operating Time	≈90 minutes
Operating Temperature	5℃-40℃
Battery Voltage	5V----1A
Port	Micro USB

# 产品保修卡

## 购买信息

序列号：\_\_\_\_\_

购买日期：\_\_\_\_\_

发票号：\_\_\_\_\_

产品型号：\_\_\_\_\_

经销商(公章)：\_\_\_\_\_

联系电话：\_\_\_\_\_

联系地址：\_\_\_\_\_

用户姓名：\_\_\_\_\_

联系电话：\_\_\_\_\_

联系地址：\_\_\_\_\_

## 维修记录

维修日期	故障及维修情况

## 保修条例

尊敬的客户，使用产品前，请您认真阅读以下内容，更多最新售后服务政策，保修条例，请以我司官方网站公布内容为准：

1. 本产品保修期为六个月。
2. 当产品在保修有效期内，按照使用说明书正常使用的情况下产生的故障，经我司检测为产品本身问题，我司将提供免费修理服务；反之，若因未按说明书正确使用、私自改装拆解、进水、摔毁等操作不当、人为损坏、不可抗力因素造成的，或超出保修有效期的，我司将收取费用进行修理。产品外观，易损易耗品不在保修范围内。
3. 因入液、摔毁、私自改装拆解等人为损坏的，产品已存在隐藏或未即时发现的功能故障和结构问题，经检测或维修后，有可能无法将机器恢复处理前的原样，我司不承担任何责任。
4. 使用方式不当导致电池过放而产生的损坏不在保修范围内。
5. 请妥善保管发票、机身码、保修卡等售后服务保障的相关依据，且请勿涂改。建议保存包装材料（寄修时可用于包装）以便日后使用。
6. 以邮寄的方式寄至我公司进行售后服务前，请先拨打热线：4000805969进行咨询后再寄出。
7. 本保修手册上的相关信息，如有任何变动，恕不另行通知，请拨打热线：4000805969或登录官方网站：[www.wingsland.com](http://www.wingsland.com) 进行咨询。
8. 本条款的解释权归深圳曼塔智能科技有限公司。



# 合 格 证

名 称： 曼塔智能S6遥控器 \_\_\_\_\_

型 号： WINGSLAND R6 \_\_\_\_\_

检 验 员： \_\_\_\_\_

检验结果： \_\_\_\_\_



售后热线：400-0805-969

网址：www.wingsland.com

售后邮箱：service@wingsland.com

★ 本包装内容物如有更新或替换，恕不另行通知。请到“深圳曼塔智能科技有限公司”官网（www.wingsland.com）技术支持页面，下载最新的《R6用户手册》。 中国制造

Tech Support: +86-(0)755-23123450      service@wingsland.com

Website : www.wingsland.com

★ Information in this User Manual could be amended without notice. Please download the latest version from the technical support page on our website: www.wingsland.com.

MADE IN CHINA