

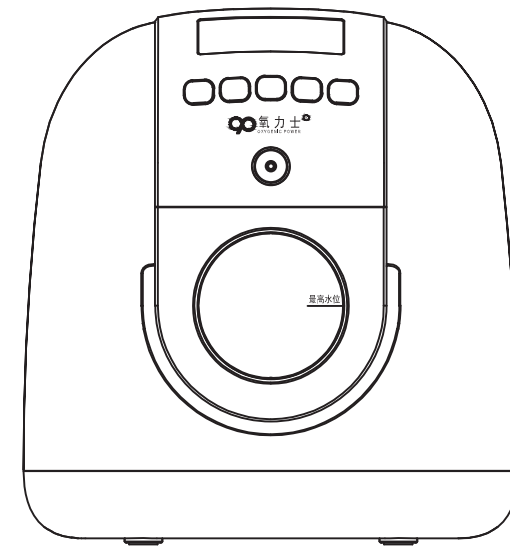

新一代家用氧气机

New-type oxygen concentrator



MODEL NO:XY-3/3C/3S/3M

使用手册
User manual

在使用本产品之前请务必仔细阅读该本使用说明
Be sure to read the instructions before using

CONTENTS

ENGLISH

SAFETY CAUTION	2
PRODUCT FEATURE	3
TECHNICAL INDEXES	4
INSTALL AND USE	5-9
MAINTENANCE	10
TROUBLESHOOTING GUIDE	11
WORKING PRINCIPLE	12



SAFETY PRECAUTIONS

In order to prevent power failure or oxygen concentrator failure, the person in need of oxygen must be equipped with other oxygen supply equipment (such as: oxygen cylinder, oxygen bag, etc.)!

The device is not considered for life support or life extension !

BEFORE INSTALLATION

Do not lie upside down the machine.

If the power supply voltage is unstable,beyond the voltage range of plus or minus 10%,please connect the regulator before use.

Please use a safe and qualified socket or a safe electrician certified terminal. Non-professionals are not allowed to open the case.

PLACEMENT

The machine should be placed in the room, ventilated place, avoid direct sunlight, away from walls and other objects more than 10cm.

Do not place sundries, water and oil containers on the machine. Do not stack sundries in the ventilator at the back and bottom of the machine to prevent the exhaust from being blocked, which may cause shutdown or decrease of oxygen concentration due to excessive temperature.

IN SERVE

SCOPE OF APPLICATION: The product is designed according to the standard of household appliances and can supply oxygen for families

HEALTH CARE FUNCTION: Oxygen intake can improve the condition of oxygen supply to the body and achieve the purpose of health care. It is suitable for people with different physiological hypoxia, such as middle and old people, people with poor physical fitness, pregnant women, students, etc. Also can eliminate fatigue after heavy physical or mental work, restore bodily function.

THE WORKING PRINCIPLE

The machine is powered by AC220V power supply, takes air as raw material, adopts high-efficiency molecular sieve to makes high-purity oxygen by PSA (Pressure Swing Adsorption) method at room temperature.

FUNCTIONAL FEATURES

INTELLIGENT CONTROL: LED display, timing function, easy to use.

OVERHEATING PROTECTION: There is overheat protector in the oil-free compressor, which will automatically stop working when the temperature of the compressor is too high, better protect the safety of the compressor and the machine.

NORMAL WORKING CONDITIONS

Ambient temperature range: 0°C-40°C

Relative humidity range: <80%

Atmospheric pressure range: 86Kpa -106Kpa

When the temperature is lower than 0 °C, the equipment should be placed in the normal ambient temperature for more than 4 hours before use.

MAIN TECHNO-INDEX PARAMETER

Model No.: XY-3/3C/3S/3M

Oxygen Generation Method: PSA

Input Power: 110W(XY-3/3C/3S)
140W (XY-3M)

Nominal Voltage: 220V ± 15V, 50±1Hz

Rated Current: 0.5A

Oxygen Purity: 26%-90% Adjustable

Oxygen Flow: 1L-7L/min Adjustable(XY-3/3C/3S)
2L-7L/min Adjustable (XY-3M)

Oxygen Pressure: 0.02-0.03 Mpa

Carbon Dioxide: qualified

Carbon Monoxide: qualified

Alkalinity Acidity: qualified

Shape Identification: No color or odor. It is flame retardant.

Product Size: 325×180×350mm

Net Weight : 6.0KG±5%

Electrical classification: II

Display control: Touch button, LED timing display,

Intelligent chip control, Infrared remote control.

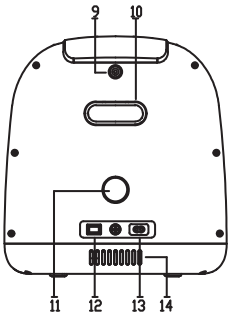
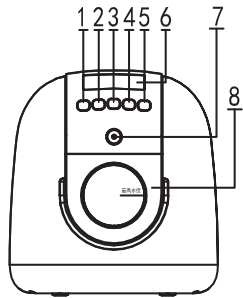

INSTALLATION AND USE:

UNPACKING INSPECTION

Before operating the product, the user shall first check whether the appearance of the product is good and whether the variety and quantity of accessories are consistent with the list of accessories in the manual. If there is any defect, please contact the distributor or manufacturer in time.

APPEARANCE SKETCH

- (1) Switch Button
- (2) Mode
- (3) Anion
- (4) Timing +
- (5) Timing -
- (6) LED Display
- (7) Oxygen Outlet
- (8) Water Tank
- (9) Nebulizer Outlet (Atomzation Model Contains)
- (10) Handle
- (11) Filter
- (12) Power Switch
- (13) Power Cord Socket
- (14) Heat-sink window

PREPARATORY WORK:

ADD WATER TO THE WATER TANK:

Grab the left and right sides of the water tank with both hands and pull evenly out of the water tank.

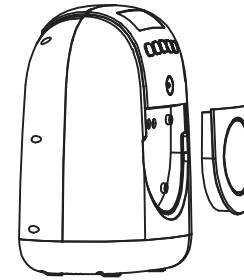

SILICONE STOPPER

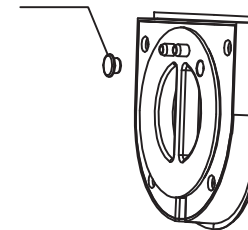

MAX LINE

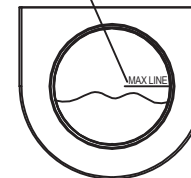

Open the silicone stopper on the back of the water tank and add purified water to the Max water level.

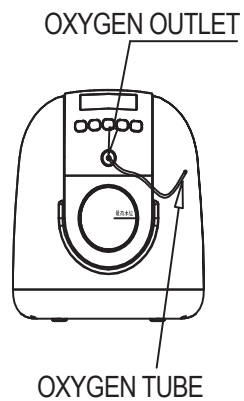
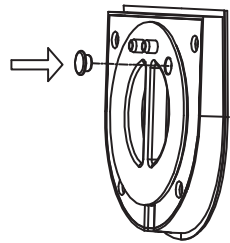

PREPARATORY WORK:

CONNECTING OXYGEN TUBE

Connect one end of the oxygen tube with the oxygen outlet and the other end with the oxygen inhaler.

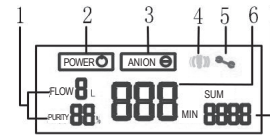

OPERATION OF INHALING OXYGEN:

LED DISPLAY SCREEN

- 1, Oxygen flow and Purity
- 2, Power pilot lamp
- 3, Anion pilot lamp
- 4, Hypoxia alarm Pilot lamp
- 5, Fault alarm Pilot lamp
- 6, Setting time
- 7, Cumulative usage time

1. POWER ON

When the oxygen machine is powered on, turn on the power switch of the rear case, and the buzzer will sound for a long time. All the lights on the LED screen will be on for 3 seconds, and will go out after automatic fault detection with only the power indicator lights up and the machine enters standby mode.

2. SWITCH

Switch between standby mode and operation of the machine; the display screen will be on after starting, the machine will have a slight nitrogen exhaust sound, and the oxygen outlet will have oxygen exhaust.

3. ADD TIME

Adjust the setting time of the machine; after starting up, it runs continuously by default; When the button is pressed for the first time, the setting time is 15 minutes; when the button is pressed continuously, the setting time is accumulated in units of 15 minutes, and the maximum setting time is 180 minutes.

4. REDUCE TIME

Adjust the setting time of the machine; after starting up, it runs continuously by default; When the button is pressed for the first time, the setting time is 180 minutes; when the button is pressed continuously, the setting time is reduced in units of 15 minutes, and the minimum setting time is 15 minutes.

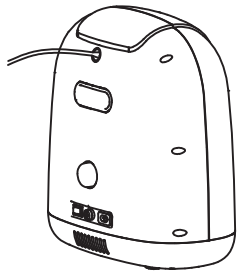

5.MODE ADJUST

Control oxygen flow and purity through mode button, the larger the oxygen flow, the smaller the purity. Please see technical parameters for detailed flow and purity.

6.ANION

Turn the anion function on or off. When the anion is turned on, the corresponding anion icon on the display lights up at the same time

7.NEBULIZER OUTLIET (Atomzation Model Contains)

As shown on the left picture, rotate the nebulizer outlet nut counterclockwise with your finger, connect one end of the nebulizer tube with the nebulizer outlet.

8.REMOTE CONTROL

Remote control button function and control panel button function consistent

ENVIRONMENTAL REQUIREMENTS

USE AND STORAGE ENVIRONMENT

It is recommended that the temperature of this machine is between 0°C to 40 °C , environment humidity less than 80%.The machine can be transported and stored in an environment with a temperature of-20°C to -55°C and humidity less than 93%.

ELECTROMAGNETIC ENVIRONMENT

In order to avoid interference from strong electromagnetic environment or other electrical appliances, please keep the machine at least 30CM apart from other household appliances during use.

Symbol of safety requirements of this machine and its meaning.



ENVIRONMENTAL REQUIREMENTS

CLEAN THE SHELL

Clean the machine shell at least once a month, first cut off the power, wipe with a clean soft cloth and prevent the liquid from flowing into the shell gap.

CLEAN THE WATER TANK

- 1,In order to keep the tank clean, should be filled with pure water and replaced as much as possible every day.
- 2,As shown in the left picture, the tank is an integral tank, which needs to be replaced every year to ensure health oxygen.
- 3After the water tank is loaded with pure water, remember to put the water tank rubber plug back and wipe clean water beads on the outside surface to ensure that the water tank is clean and tidy

CLEAN OXYGEN TUBE AND INHALER

Should clean everyday commonly.The outlet of the nasal inhaler should be cleaned after each use.It is recommended to replace the oxygen tube once a year.The oxygen tube should be kept dry

HOW TO DEAL WITH LONG-TERM DISUSE

When preparing to not use this machine for a long time, please follow the following steps:

1. Take out the humidification water tank, pour out the water in the water tank, and then replace the water tank to its original position.
 2. Cut off the power supply and put away the power cord.
 3. Oxygen tube and oxygen inhaler should be kept in a dry environment to avoid direct sunlight and pollution.
 4. Store the battery after it is fully charged. It is recommended to charge and discharge it once a month to keep the battery active.
- After long-term use, please follow the following steps:
1. Check the power cord.
 2. Clean oxygen tube and oxygen inhalers and check if they are broken, if so, please change them.

COMMON FAULTS AND TROUBLESHOOTING

No.	Faults	Cause Analysis	Troubleshooting
1	There is a smell in the air stream.	During the initial use of the machine, the connecting pipes and other plastic parts will emit odor, which is a normal phenomenon.	This smell is the normal smell from silicone hose and ABS plastic. After inspection, it is non-toxic and harmless. As the machine is used, the smell will slowly disappear.
		Whether the humidification water tank has not been cleaned for a long time or the water has not been replaced for a long time, resulting in peculiar smell in the water tank.	Clean the oxygen delivery tube and humidifying water tank.
2	Water comes out of the oxygen outlet.	The water added in the humidification water tank exceeds the highest water level line, and the air flow presses the bubble into the air delivery tube.	Reduce the water in the humidifying water tank below the maximum water level.
		When the machine is used for a long time, the water vapor in the airflow condenses on the tube wall.	Pour out the water from the water tank, and add water to the water tank when no water emerges from the oxygen outlet.
3	The machine makes a "beep" sound every few seconds.	This is the sound of discharging nitrogen when the machine is working normally and is a sign of good operation of the machine.	
4	After start up, the machine operates normally, but the flow rate is shown as 0 or small.	Flow rate is off or small.	Increase the flow rate.
		Kink or blockage of oxygen tube.	Adjust the oxygen delivery tube.
		The connecting tube inside the machine falls off or breaks.	Cut off the power supply. Professional maintenance personnel shall carry out the maintenance.
5	After start up, the water tank bubbled and the oxygen outlet had no oxygen output.	The rubber plug of the humidifying water tank is not plugged properly.	Take out the humidifying water tank and plug the rubber plug again.
6	After startup, the indicator lamp is normal, and the machine is not working normally (the working sound is not normal).	Compressor failure.	Cut off the power supply. Professional maintenance personnel shall carry out the maintenance.
		If the ambient temperature is too high and there is no oil in the compressor, the compressor starts the self-protection program.	This is a normal phenomenon. After the temperature drops, the machine will restart automatically.
		Isolation solenoid valve failure.	Cut off the power supply. Professional maintenance personnel shall carry out the maintenance.
		The connecting tube inside the machine falls off or breaks.	Cut off the power supply. Professional maintenance personnel shall carry out the maintenance.

SCHEMATIC DIAGRAM OF GAS CIRCUIT OPERATION

Air first enters the compressor through the air inlet filtering silencer, and then enters the molecular sieve tower to separate oxygen and nitrogen. Oxygen smoothly enters the fine screening tower through the molecular sieve tower, and nitrogen is adsorbed by molecules and then discharged into the atmosphere through the separation valve. Oxygen passes through the fine screening tower to further increase the concentration and then enters the solenoid valve flow system, and the amount of oxygen flow is controlled by the adjusting the solenoid valve. After passing through the solenoid valve flow control system, oxygen enters the humidifying water tank for wetting, and finally oxygen is supplied to the user through the oxygen delivery tube for supplementing oxygen.

