



Electric Bike

## L2 User's Manual & folding instructions

**SHENZHEN QLHX TECHNOLOGY CO., LTD.**

No. 60, Dawei area 1, Longxin Community, Baolong street, Longgang District, Shenzhen

Made in China

# FIIDO Electric Bicycle Catalog

I . Important Note

II . Product components

III . Unfolding instructions

IV . Folding instructions

V . Product parameters

# I . Important Note

- a) This manual include important safety performance information and service information. Please make sure you have read the following warning content before the first time you use our product.
- b) If you borrow your electric bicycle to other people, please let the user read this manual, it could help to decrease the risk of accident.
- c) Please wear a suitable and safe helmet before riding, please wear the clothes with fluorescent and reflective stripes when you ride at night. Don't exceed speed limit, it is a main reason of traffic accident, we should abide by the traffic rule, we shouldn't exceed the speed limit. Don't touch the charging hole on the bike, or use metal touch it, otherwise, the accident will be caused by the transient short circuit of the current.
- d) Zero starting, braking frequent, driving against the wind, carrying people or anything, insufficient air pressure on the tires. All of these will use much electric energy, and then reduce the endurance mileage. If you want the best endurance mileage, please do something as follows:
  - 1. please use assist mode.
  - 2. on the premise of safety, don't brake frequently or use zero starting.
  - 3. Don't overload.
  - 4. Before riding, please check the pressure of the tire, and supply enough pressure.
- e) Our Ebike should avoid prolonged exposure to the sun or rain , avoid storage in places with high temperature or corrosive gas, so as to avoid electroplating parts and paint surface by chemical corrosion and electrical parts damage, resulting in operational failure and accidents
- f) Your current insurance business may not cover the situation you may encounter when riding a electric bike, please contact your insurance company or insurance broker for relevant consultation
- j) According to the law in China, riding an electric bicycle or a three-wheeled Electric bike must reach the age of 16. If you use this product in other countries, please refer to the local laws and regulations.
- h) Bicycles are vehicles with certain risk factor , please be sure to abide by the traffic rules. At the same time, when emergency braking , brake the rear wheel first, then brake the front wheel, when cycling speed is too fast. There is a danger of tipping over if you brake the front wheel suddenly, please ride carefully .

## II . Product components

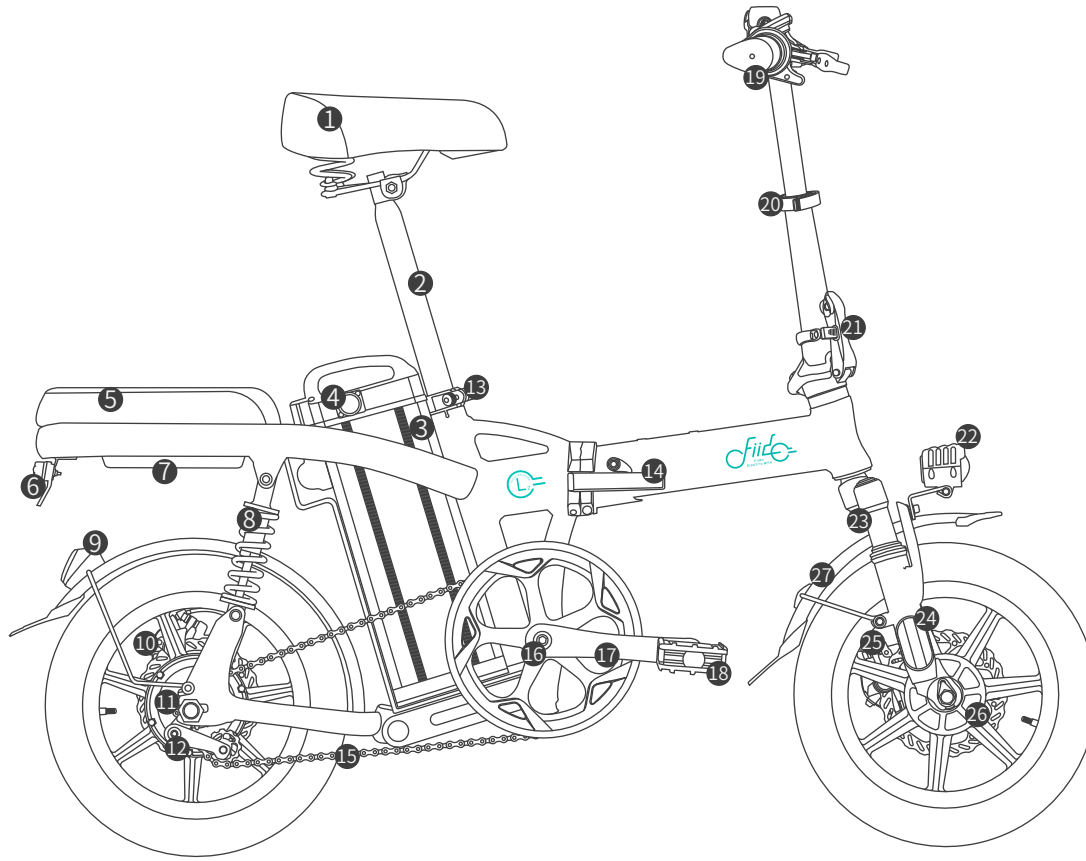

- 1、Saddle 2、Seat tube 3、Battery box 4、Charge port 5、Saddle 6、taillight 7、Controller box 8、Rear Suspension 9、Reflector 10、Brake disc 11、Motor 12、Chain extender 13、Quick lock 14、Folding system 15、Chain 16、Chain wheel 17、Crank 18、Pedal 19、Handle bar 20、Quick lock 21、Stem 22、Headlight 23、Suspension Fork 24、Reflector 25、Brake disc

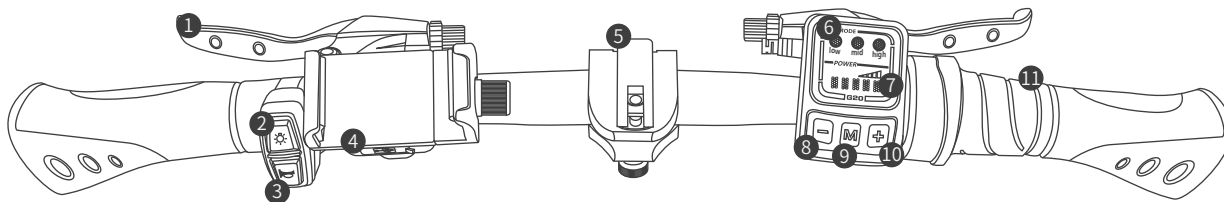

- 1.Brake power off system 2.Light button 3.horn button 4.Mobile phone bracket &USB Port 5.Quick lock 6.Assistance Gears light  
7.Power light 8.Assistance Gears 9.Power on/off button(Long press on or off) 10.Assistance Gears 11.Speed handlebar  
(Note:After the car is stationary, it does not run for 10 minutes to enter the sleep mode and automatically shut down)

Battery charging port  
(The charging port is located on the left side of the controller box.)

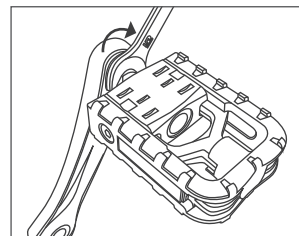
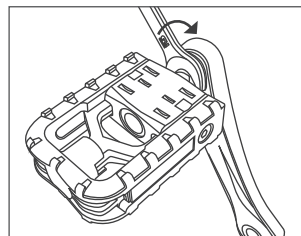
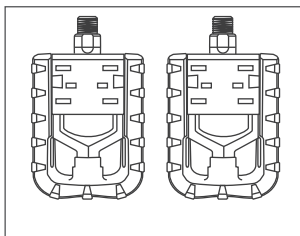
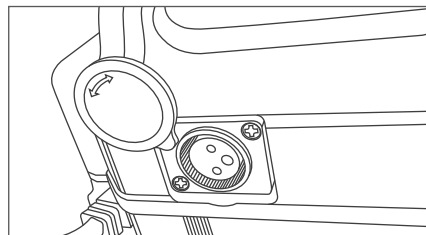

Use a 15mm open spanner to clamp the pedal shaft core  
and tighten it in the direction of the arrow (left counterclockwise, right clockwise, as shown).  
(Note:When installing the pedal, be aware of the left and right, align the installation horizontally to prevent the pedal or crank slip)

# III. Unfolding instructions

- 1.Unfold the frame,lock the frame folding handle,and lock the frame folder safety clasp.
- 2.Fold the riser to the upper end,lock the riser folding handle,adjust the riser safety hook to the tightening state,and adjust the position of the T handle.
- 3.Open the clip on the seat tube clamp and insert the seat tube into the position within the marking line on the seat tube. Adjust the seat to the comfortable height according to individual needs, and fasten the seat tube clip.

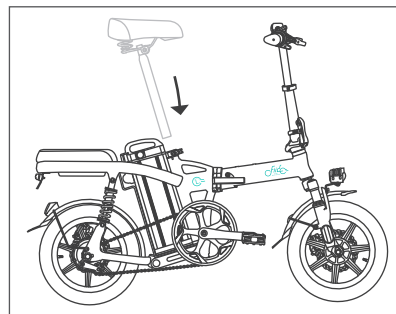
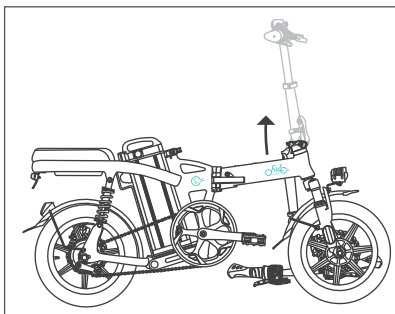
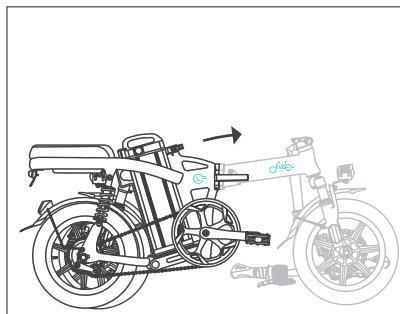

- 4.Please confirm the following items before riding: frame lock, standpipe lock and seat tube lock are locked.
- 5.Brake system is normal. Tires are adequately inflated. All these are important for a safe and comfortable riding.

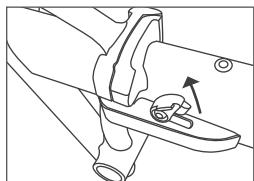

opened

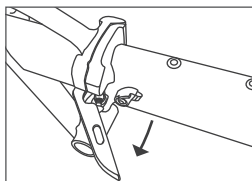

locked

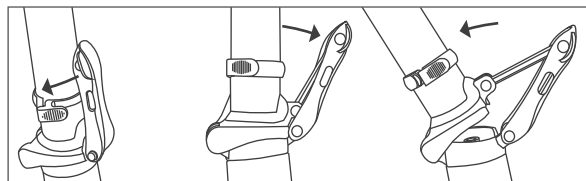

opened

locked

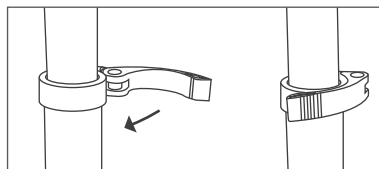

The insertion depth must be higher than the tick mark

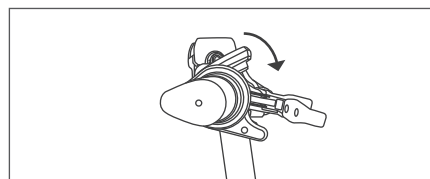

Adjusting the handle

## IV. Folding instructions

Step 1. Open the quick lock on the head end, to let the handle be perpendicular to the care frame.

Step 2. Open the quick lock on the Stem, lower the riser,as well as locking the quick lock.

Step 3. Open the Seat Tube quick lock, decentralized seats, as well as locking the quick the quick

Note:Both the Rise and the Seat Tube are marked with a safe (MAX or MIN). For safety reasons, please use them in a safe range.

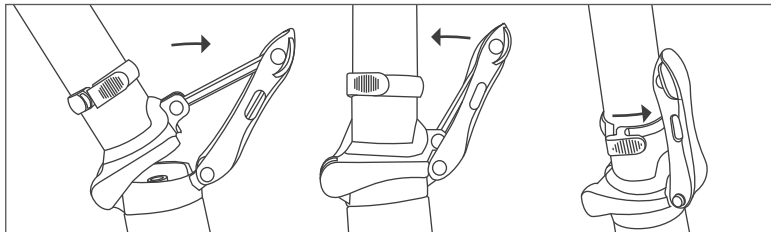
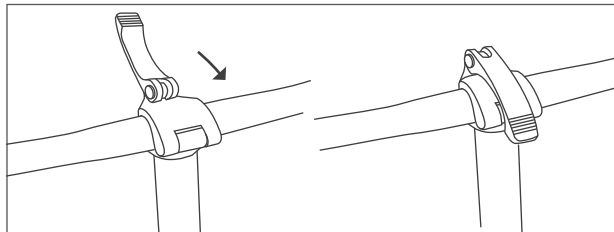

Step 4. Turn the buckle on the Standpipe clockwise and pull down the fold and fold down the front.

Step 5. Open the frame holder of the fuse buckle, pull the fold, and the frame.

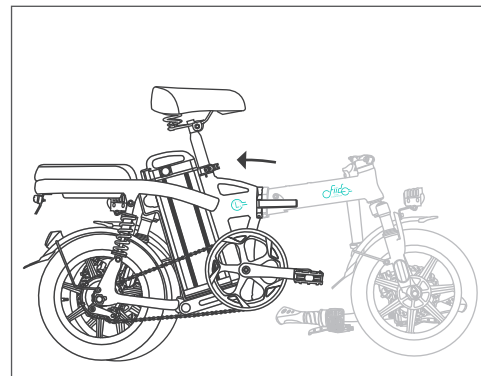
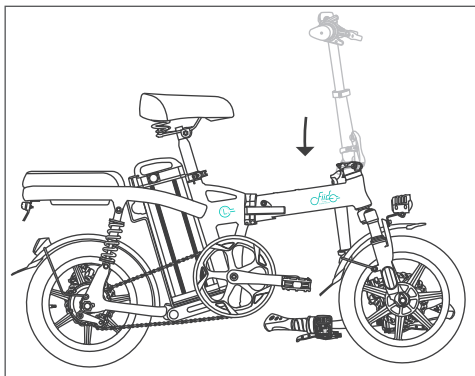
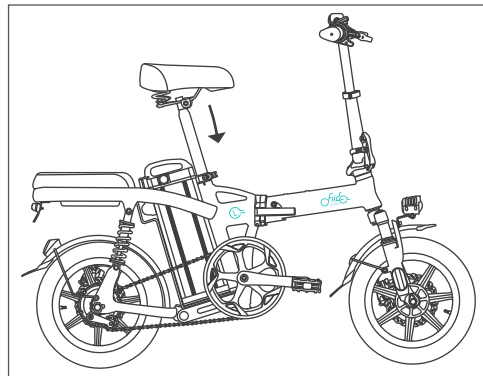

## V . Product parameters

Name	Specification
Electric Bike System	FIIDO System
Electric Motorcycle	Support
Power Assist System	Support
Power Assist System	3 Gears Assist
Max Load weight	120kg
Maximum Speed	25km/h
Maximum Range	Up to 60km
Battery High quality lion battery	48V 12.5Ah/20Ah/25Ah
Battery adaptation	DC 54V3A
Recharge Time	7 hours
Drive Type	Rear Drive
Frame Material	Aluminum Alloy
Front Brake	Mechanical Disc Brakes
Brake Type	Mechanical Disc Brakes
Chainset	Prowheel Steel 52 Tooth
Gears	16 Tooth
Chain	KMC S1 RB
Rear Brake	Mechanical Disc Brakes
Rear Hub/Rated Power	XiongDa Motor/350W
Rims	Alloy
Wheel Size	14"
Tyre Size	14×2.125 inch
Tyres	Cheng Shin Tire
Net Weight	18kg
Folded Size	77cm×43cm×57cm
Size	130cm×45cm×104cm

\* The above data allow for 5% manufacturing tolerances.

\* After receiving the goods, there may be some differences between individual accessories and display drawings, which are different due to the different batches, and do not affect the use.