

The logo for Fiido Electric Bike features the word "Fiido" in a stylized, teal-colored font. Below "Fiido" are the words "Fiido" and "Electric Bike" in a smaller, teal-colored font. To the right of the text is a teal-colored graphic of a bicycle wheel and a chain link. A small "TM" trademark symbol is located to the upper right of the graphic.

# Electric Bike

## D4s User Manual

**SHENZHEN QLHX TECHNOLOGY CO., LTD.**

No. 60, Dawei area 1, Longxin Community, Baolong street, Longgang District, Shenzhen



Made in China

## FIIDO Electric Bicycle Catalogue

1. Note
2. Instruction Illustration
3. Installation Instruction
4. Folding instructions
5. Specifications

# 1. Note

This manual includes important safety performance and service information. Please make sure you have read the following warnings before the first time you use our product.

- a) If you lend your electric bicycle to other people, please let the user read this manual, it could be helpful to decrease the risk of accident.
- b) Please wear the suitable and safe helmet before riding, please wear the clothes with fluorescent and reflective stripes when you ride at night. Don't exceed speed limit, it is a main reason of traffic accident, we should abide by the traffic rules.
- c) Don't touch the charging hole on the bike, or use metal touch it, otherwise, it will cause short circuit.
- d) Zero starting, frequent braking, riding against the wind, carry people or anything when tire pressure is insufficient, insufficient air pressure on the tires, all of these will consume much electric energy, and then reduce the endurance mileage. if you want to achieve the longest endurance mileage:
  - 1. power assist mode.
  - 2. For your safety, please don't brake frequently or use zero starting.
  - 3. Don't overload.
  - 4. Before riding, please check the pressure of the tire, and supply enough pressure.
- e) Our Ebike should avoid prolonged exposure to the sun or rain, avoid storage in places with high temperature or corrosive gas, so as to avoid electroplating parts and paint surface by chemical corrosion and electrical parts damage, resulting in operational failure and accidents.
- f) Our e-bike should avoid long-term exposure to sunlight or rain, and avoid storing them in places with high temperature or corrosive gas, so as not to avoid chemical corrosion and electrical component damage to electroplated parts and painted surfaces, which may lead to operational failure and accident.
- g) When the electric bicycle is not used for a long time, please turn off the main switch in time and charge it. Keep the battery fully charged, please don't store the battery when power off to avoid severe power failure.
- h) Your current insurance business may not cover the situation you may encounter when riding a electric bike, please contact your insurance company or insurance broker for relevant consultation.
- i) According to the law, people must reach the age of 16 to ride e-bike or three-wheeled electric bike. If you use this product in other countries, please refer to the local laws and regulations.
- j) Bicycles are vehicles with certain risk factor, please be sure to abide by the traffic rules. At the same time, When emergency braking, brake the rear wheel firstly then the front wheel if cycling speed is too high. If the front wheel is suddenly braked, you may fall over, please ride carefully.

## 2. Instruction Illustration

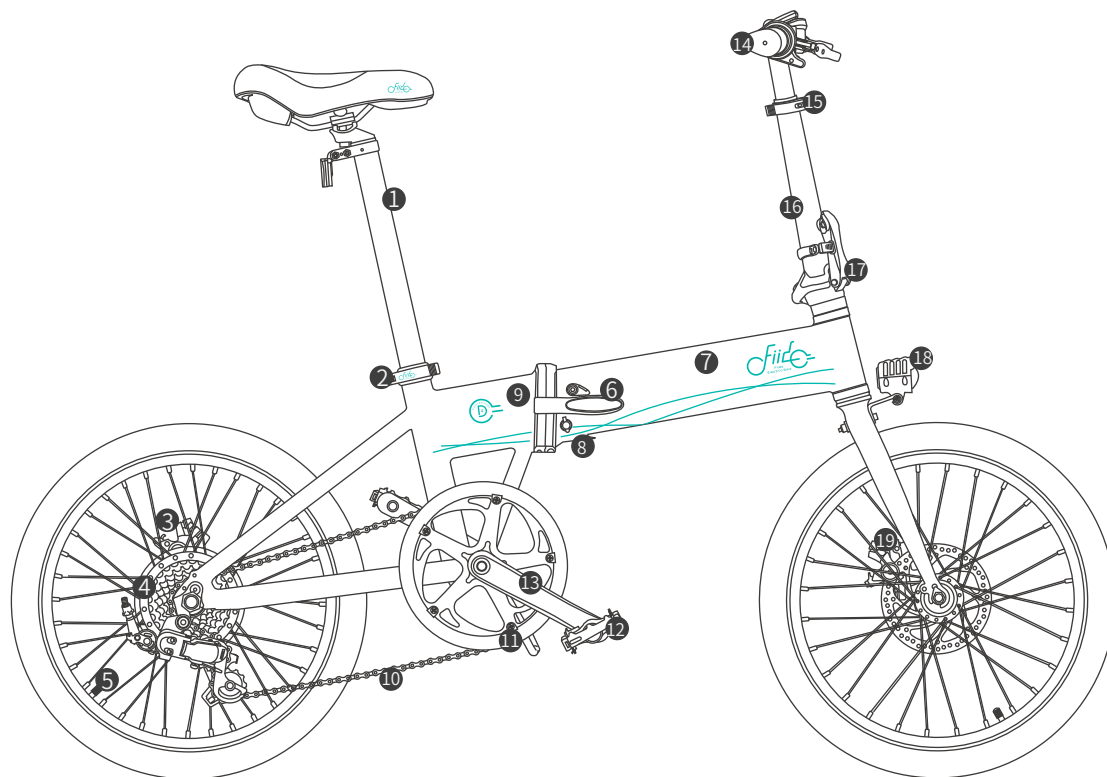

1.Seat tube  
2.Quick lock  
3.Brake disc  
4.Motor

5.Valve  
6.Folding system  
7.Battery box  
8.Charge port

9.Controller box  
10.Chain  
11.Chain wheel  
12.Pedal

13.Crank  
14.Handle bar  
15.Quick lock  
16.Stem

17.Folding system  
18.Headlight  
19.Brake disc

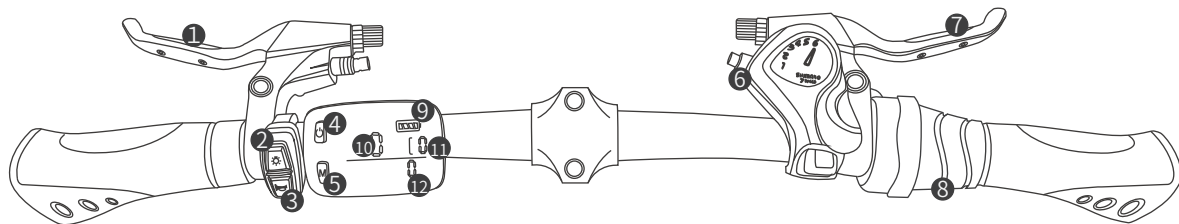

- |                          |   |   |                         |
|--------------------------|---|---|-------------------------|
| 1.Brake power off system | 4.Power on/off button(Long press on or off) | 7.Power off brake   | 10.Speed                |
| 2.Light/horn button      | 5.Power adjustment                          | 8.Speed-up rotating handle (Do not use the torque above 9 to operate the lever) | 11.Electric assist gear |
| 3.Horn                   | 6. Speed regulation                         | 9.Battery Level   | 12.Use mileage          |

(Note:After the car is stationary, it does not run for 10 minutes to enter the sleep mode and automatically shut down)

13.Battery charging port  
(located below the main beam of the frame)

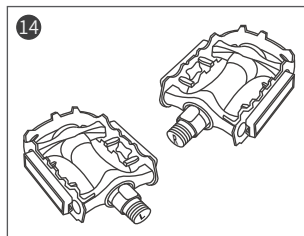
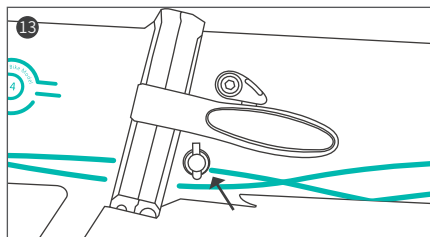

14.Pedal

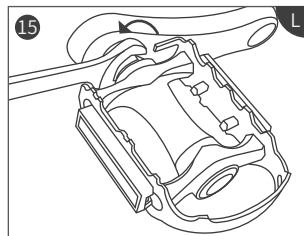

15.Left

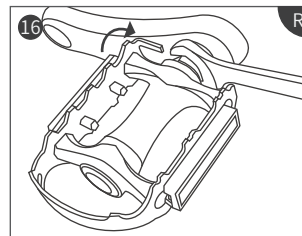

16.Right

Use a 15mm open spanner to clamp the pedal shaft core and tighten it in the direction of the arrow (left counterclockwise, right clockwise, as shown).

(Note:When installing the pedal, be aware of the left and right, align the installation horizontally to prevent the pedal or crank slip)

### 3. Installation Instruction

- 1.Unfold the frame,lock the frame folding handle,and lock the frame folder safety clasp.
- 2.Fold the riser to the upper end,lock the riser folding handle,adjust the riser safety hook to the tightening state,and adjust the position of the T handle.
- 3.Open the clip on the seat tube clamp and insert the seat tube into the position within the marking line on the seat tube. Adjust the seat to the comfortable height according to individual needs, and fasten the seat tube clip.

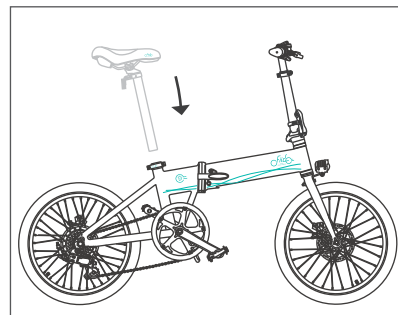
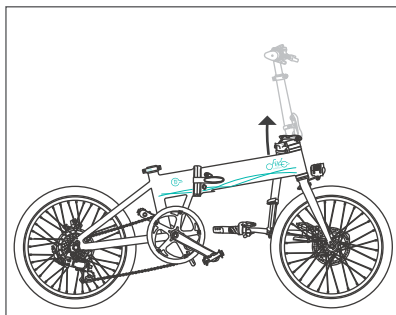
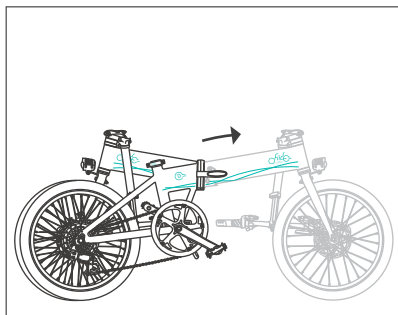

- 4.Please confirm the following items before riding: frame lock, standpipe lock and seat tube lock are locked.
- 5.Brake system is normal. Tires are adequately inflated. All these are important for a safe and comfortable riding.

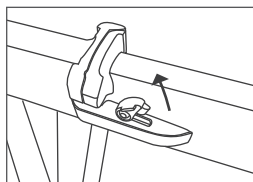

opened

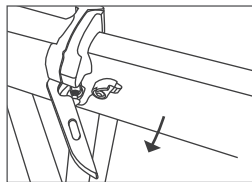

locked

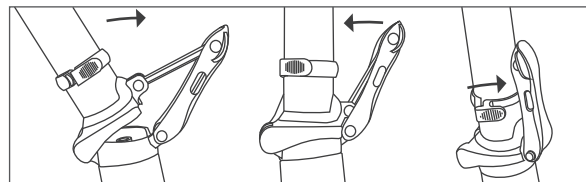

opened

locked

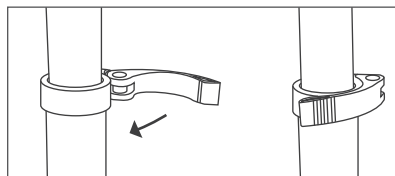

The insertion depth must be higher than the tick mark

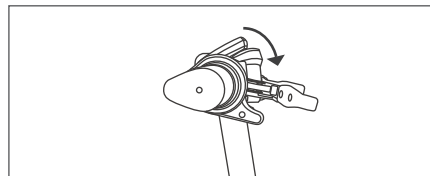

Adjusting the handle

## 4. Folding instructions

Step 1. Open the quick lock on the head end, to let the handle be perpendicular to the care frame.

Step 2. Open the quick lock on the Stem, lower the riser,as well as locking the quick lock.

Step 3. Open the Seat Tube quick lock, decentralized seats, as well as locking the quick lock .

Note:Both the Rise and the Seat Tube are marked with a safe (MAX or MIN). For safety reasons, please use them in a safe range.

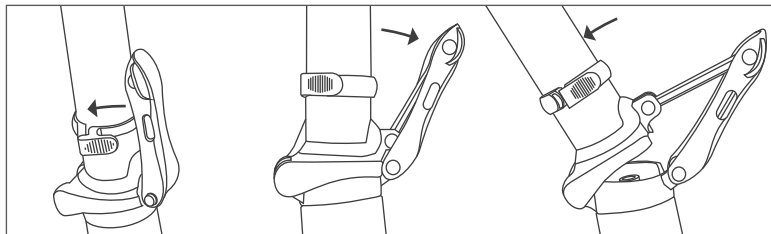
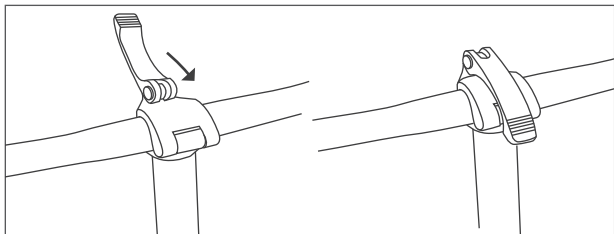

Step 4. Turn the buckle on the Standpipe clockwise and pull down the fold and fold down the front.

Step 5. Open the frame holder of the fuse buckle, pull the fold, and the frame.

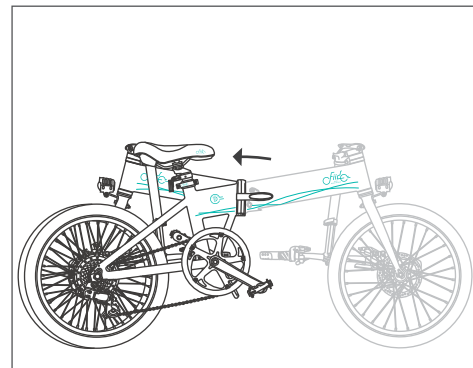
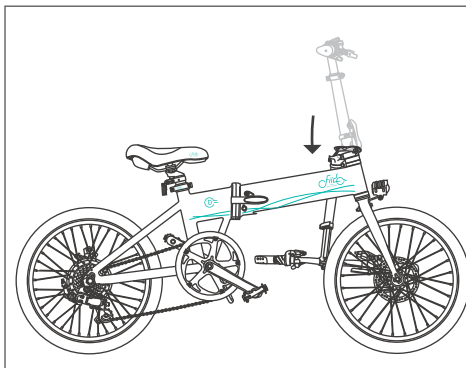
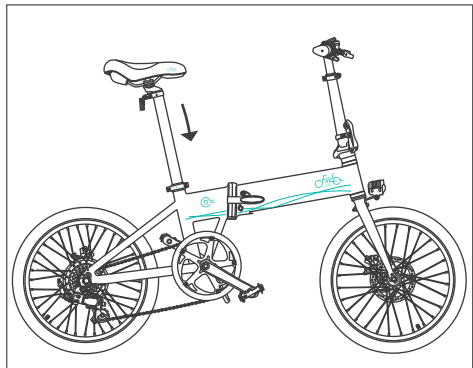

## 5. Specifications

Name	Specification
Electric Bike System	FIIDO System
Electric Motorcycle	Support
Power Assist System	Support
Max Load weight	120kg
Maximum Speed	25km/h
Maximum Range	Power assisted models up to 80KM
Battery	High quality lion battery 36V 10.4Ah
Battery adaptation	DC 42V 2A
Recharge Time	7 hours
Display	LCE Display
Drive Type	Rear Drive
Frame Material	Aluminum Alloy
Front Brake	Mechanical Disc Brakes
Brake Type	Mechanical Disc Brakes
Chainset	Prowheel Steel 52 Tooth
Gears	Shimano
Chain	KMC Z7
Rear Brake	Mechanical Disc Brakes
Rear Hub/Rated Power	XiongDa Motor/250W
Rims	Alloy
Wheel Size	20"
Tyre Size	20" × 1.75 inch
Tyres	Cheng Shin Tire
Net Weight	18.8kg
Folded Size	85cm × 45cm × 64cm
Size	150cm × 26cm × 108cm

\* The above data allow for 5% manufacturing tolerances.

\* After receiving the goods, there may be some differences between individual accessories and display drawings, which are different due to the different batches, and do not affect the use.