

# USER GUIDE

THE ONE LIGHT



A piano that can teach to play.

# COMPONENTS LIST

Thanks for purchasing The ONE Light. Please check your box for the following items:

- Keyboard body

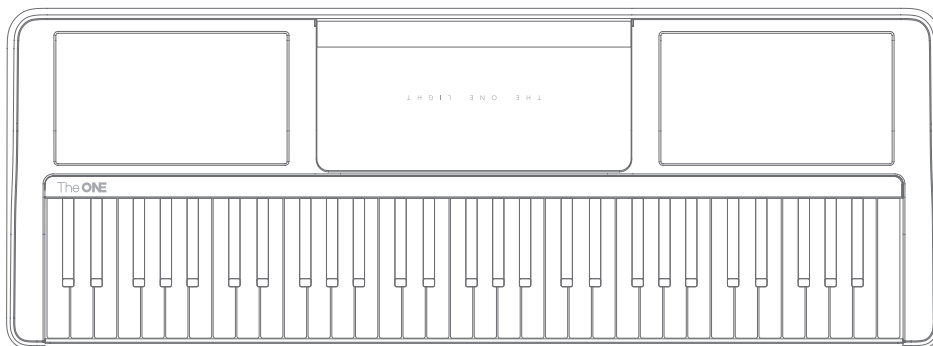

- DC 12V power cord

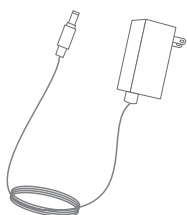

- User manual

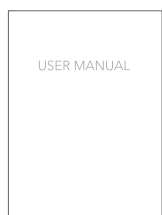

- Data cables

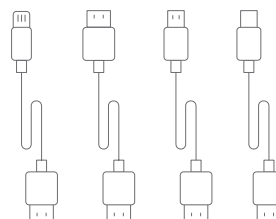

The power cord is hidden on the side plastic foam.

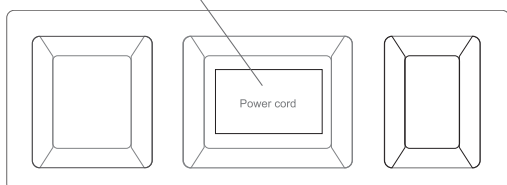

- Search "The ONE Smart Piano" on App Store or Google Play

For more information, visit:

<http://www.smartpiano.com/pages/sheet-music>

# INTRODUCTION

---

FRONT VIEW



BACK VIEW

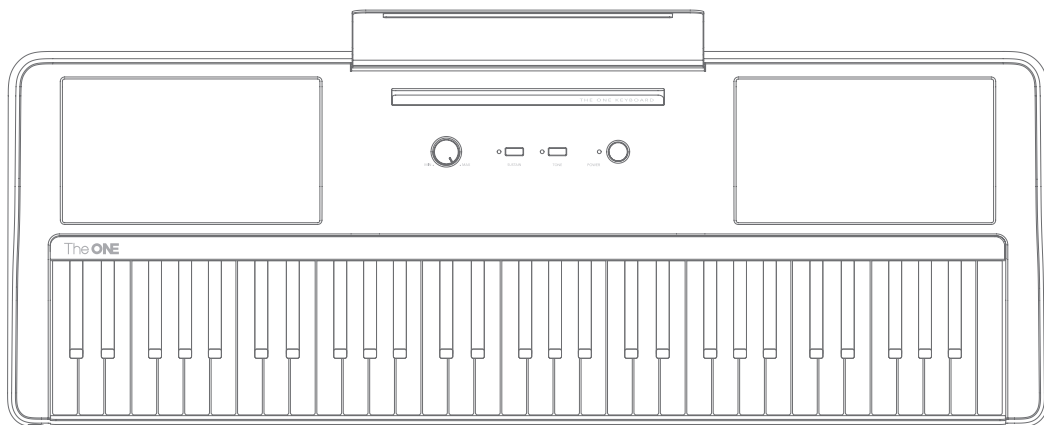

The ONE Light is a new way to learn piano. It's made for music hobbyists and those who are learning music for the first time. When you use the piano with your mobile device, you'll unlock additional features. Supported devices include Android 4.4+ and iOS 9.0+ (excluding iPad 1).

# SETUP

This guide will help you set up and play your new instrument. Before turning on the power, please read the following instructions carefully.

## POWER SUPPLY

Before turning on the instrument, adjust the volume to the lowest level both on the device and on any other connected systems.

1. Connect the AC/DC power cord to a 110V/220V outlet.  
( The power supply can be found in a white box within the styrofoam of the keyboard packagin. )
2. Connect the AC/DC power adaptor to the DC socket on the back of the keyboard.
3. Press the power button and see that the corresponding red light has been turned on to indicate that the instrument is on.
4. Press the power button twice to turn off the power.

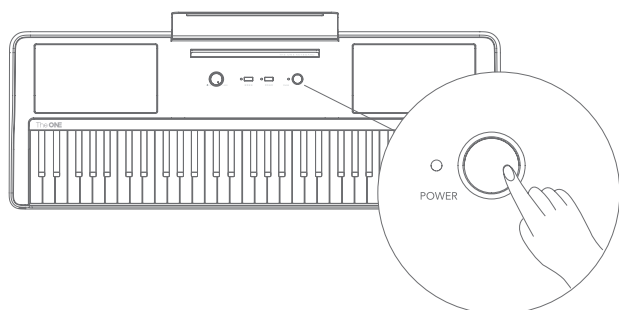
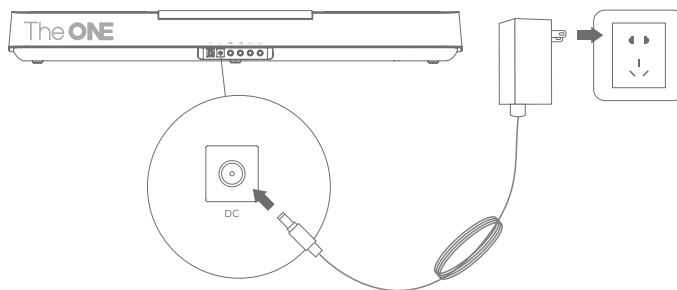

### ! WARNING:

1. The instrument has an auto-power off feature. To conserve electricity, the keyboard will turn off by itself after 30 minutes. You can use The ONE Smart Piano app to control this feature if needed.
2. For safety reasons, do not use the instrument during thunderstorms and turn off the power.

## USING THE PIANO STAND

The piano stand is flat, versatile, and doesn't need to be separately installed. When using the stand, just lift the cover to stand it up. You can use it to hold your mobile devices.

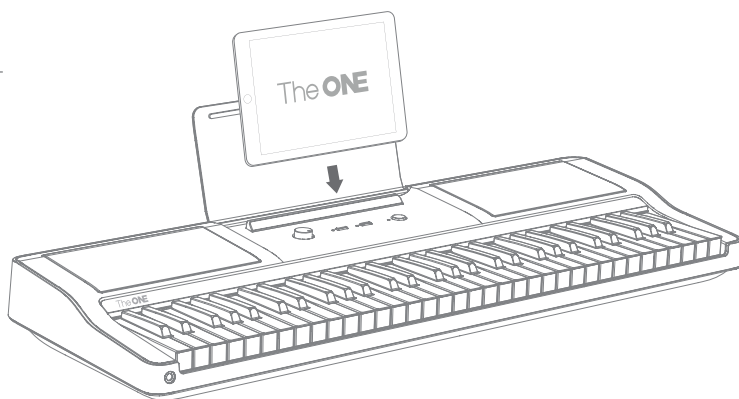

# PANEL CONTROLS & SCREEN DISPLAY

## MAIN PANEL

### 1 MASTER VOLUME CONTROL

Use the Master Volume Control to adjust the volume to an appropriate level. Rotate clockwise to increase, or counter-clockwise to decrease.

### 2 SUSTAIN BUTTON

Turn on/off the Sustain feature. When it is turned on, the indication light next to it will light up and a fixed sustain will be added to the Keyboard voices.

### 3 TONE SETTING

Select from 20 built-in tones by pressing the [Tone] button repeatedly. The indication light next to it will light up when a tone different than the default grand piano tone is selected.

### 4 POWER SWITCH

Turn on/off the power. When the power is on, the indication light next to it will light up.

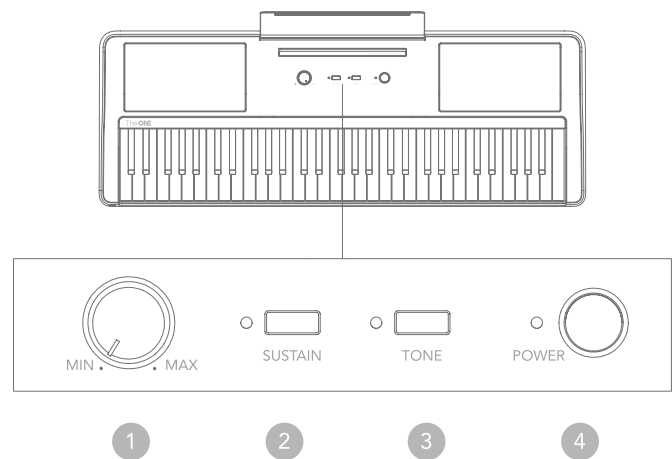

## REAR PANEL

### 5 iOS / ANDROID SOCKET

Connects to iOS devices (with iOS 9 and newer, except iPad 1) and Android devices (which supports USB Host/OTG) through the connecting cables which come with the keyboard.

### 6 DC POWER SUPPLY SOCKET

Connects to 12V DC power adaptor.

### 7 MIC IN SOCKET

Connects to 1/4" microphone so you can sing as playing.

### 8 1/4" AUX IN SOCKET

Connects to external audio source, to play the audio through the keyboard's speakers.

### 9 1/4" AUX OUT SOCKET

Connects to external audio output devices, to stream audio from the keyboard.

### 10 1/4" PEDAL SOCKET

Connects to external pedal to add pedal effect to your play.

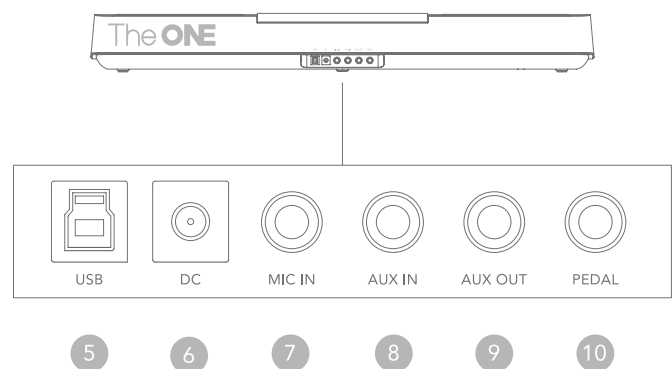

# EXTERNAL EQUIPMENT

## CONNECTING SMART DEVICES

To bring endless fun to music playing, we are integrating smart devices, entertainment and music learning into this revolutionary instrument. You can plug iOS 9.0 or newer Apple devices (iPad 1 is not supported) and Android 4.4 or newer USB Host/OTG Android device to discover more fun surprises.

### TWO-WAY MIDI COMMUNICATION THROUGH USB

Once this instrument is connected with your smart device, you can record sounds from it into a sequencer on your smart device. You can also use this instrument as a speaker for your smart device to play MIDI files stored there.

### AUDIO DISPLAY THROUGH USB

Use this instrument as a high quality external speakers to stream music from your smart devices, by simply connecting them.

### MOBILE APPLICATIONS FOR MORE FEATURES

There are free applications for your iOS and Android devices, providing various additional features.

#### CAUTION:

Before connecting the instrument to other electronic equipment, please set all volume levels to the minimum, then turn off the power for all components. various additional features.

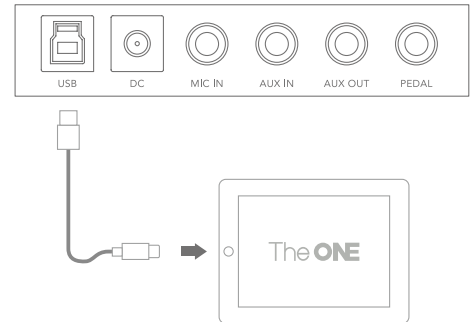

## CONNECTING HEADPHONES

When you need to practice in silence, a pair of headphones can be plugged in as illustrated.

Once plugged in, the instrument sound can only be heard through the headphone instead of the speaker.

#### CAUTION:

1. Do not use headphones for a long period of time at a high volume level, since this can cause auditory fatigue or even permanent hearing loss.
2. The headphone socket is a standard 3.5mm (1/8") size.

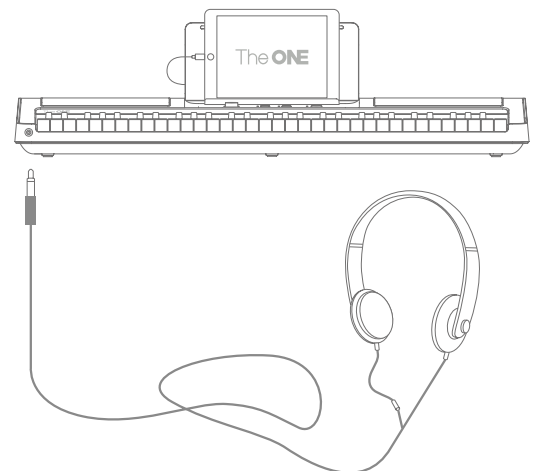



# EXTERNAL EQUIPMENT

## CONNECTING MICROPHONE

Sing and play the keyboard at the same time! Just plug in a microphone to make it your own concert.

To protect the speaker/headphone, please set the volume to the minimum before plugging in the microphone.

1. Plug a 1/4" microphone in the MIC IN jack.
2. Sing to the microphone and adjust the volume to an appropriate level using the Master Volume Control.

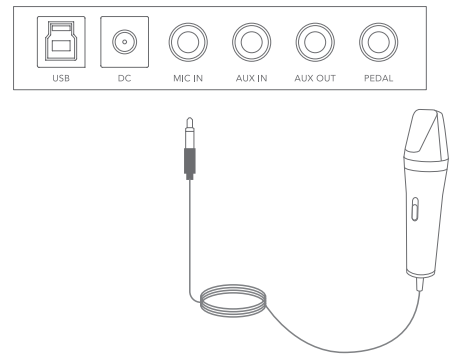

## CONNECTING AUDIO EQUIPMENT

You can connect the 1/4" AUX OUT jack to a keyboard amplifier, stereo system, mixer, recorder, or other line-level audio device.

### CAUTION:

Before connecting the instrument to other electronic equipment, please set all volume levels to the minimum, then turn off the power for all components.

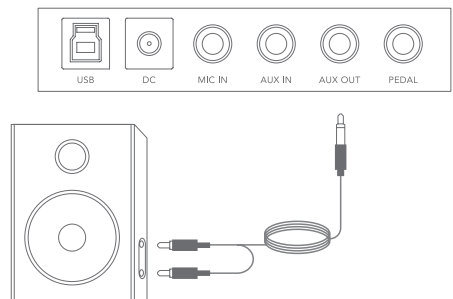

## CONNECTING MP3/CD PLAYER

You can connect the 1/4" AUX IN jack to a MP3/CD player or other audio output.

Plug the MP3/CD player in the 1/4" AUX IN jack to enjoy the full, natural sound of your favorite music from the keyboard speaker.

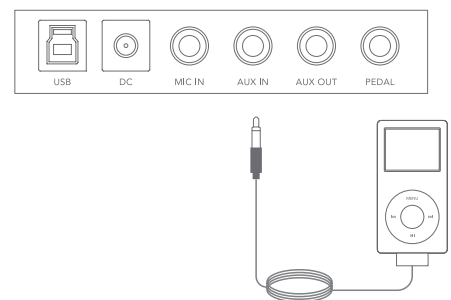

## CONNECTING A SUSTAIN PEDAL / FOOTSWITCH

You can produce a natural sustain as you play by pressing an optional sustain pedal/footswitch.

Plug the sustain pedal in the SUSTAIN jack as illustrated in the figure. Press/release the pedal to turn on/off the sustain effect.

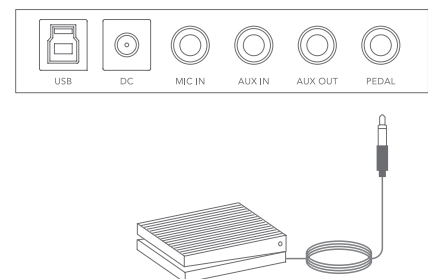

# BASIC OPERATION

## POWER SWITCH

### POWER ADAPTOR:

1. First of all, please make sure you have connected the power adaptor to the DC power supply jack and plug the DC adaptor into a power outlet.
2. Press the [POWER] switch, the LED light on the left will light up, indicating power has been turned on.

### NOTICE:

If the LED light on the left doesn't light up after pressing the [POWER] switch, please check whether the power adaptor has been plugged in correctly.

### USING BATTERIES:

This instrument requires 6 "AA" size batteries.

1. Open the battery compartment cover located on the instrument's bottom panel.
2. Insert the 6 new batteries, following the polarity markings on the compartment.
3. Replace the compartment cover, making sure it locks firmly.

### ! WARNING:

1. Please don't mix old and new batteries.
2. Please don't mix battery types.
3. If the instrument will not be used for an extended period, please take out all the batteries.

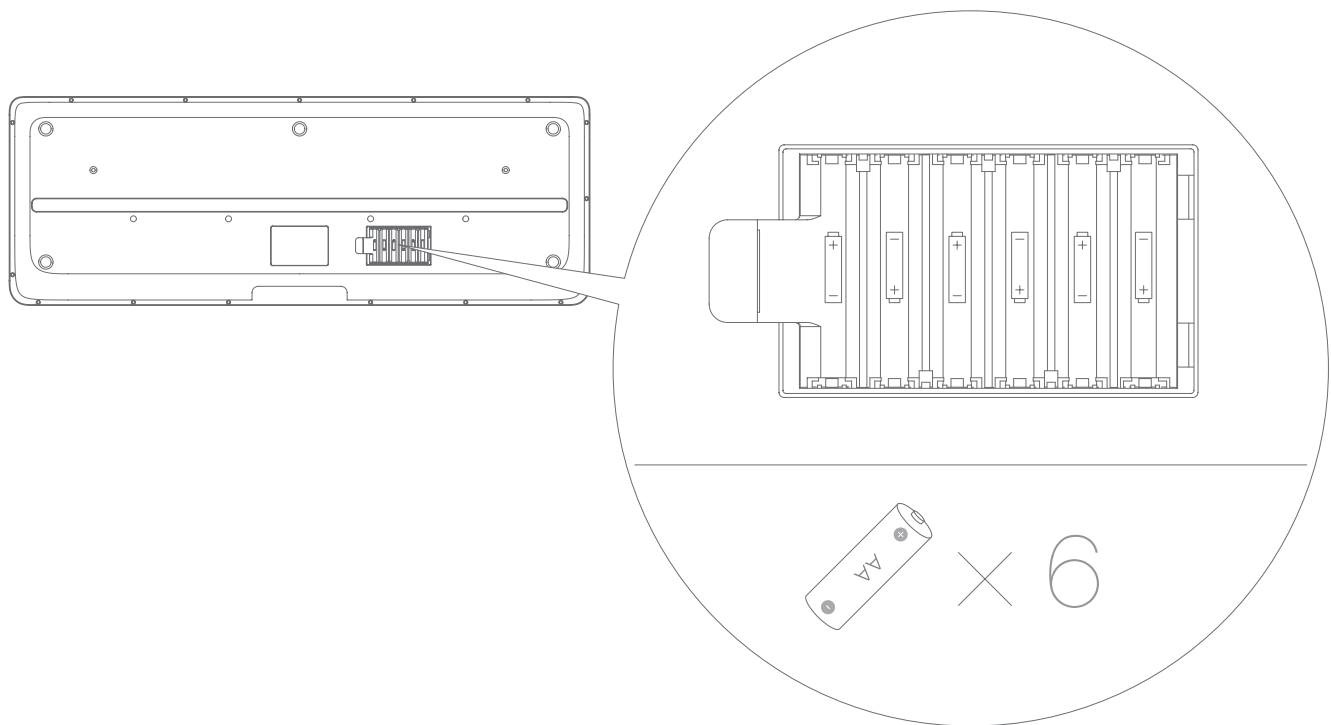

# EXTRA FEATURES

---

## NOTE:

This only lists the features on the piano. For specific instructions, refer to the app.

## SELECTING DIFFERENT TIMBRES

When connected to the app, you can choose from 417 different timbres, including 16 folk instruments, 9 types of percussion, 256 MIDI tones and more. There is a sound for every type of performance.

## ! TIPS:

1. For specific instructions for using the device settings, please refer to the software.
2. When the piano is being used without the app, the sound will be the acoustic grand piano sound by default.

## SETTING THE RANGE

Using the piano's transpose function, you don't need to readjust your own notes. Use the piano to move up half semitones for the whole keyboard. You can adjust up or down 12 semitones.

## SETTING THE OCTAVE

Through the piano, you can change the pitch of the entire keyboard up or down 1 full octave.

## AUTO-OFF

The device will automatically shut off when it is timed to 30 or 60 minutes. The default is set to 30 minutes.

## ! TIP:

When you're not using the app, the piano will shut down after 30 minutes of no activity.

# IMPORTANT SAFETY INFORMATION

---

Before you use this product, read the instructions carefully. Keep this manual to refer back to later.

## WARNING

The functions of this product may be affected by strong electromagnetic interference. If this happens, simply follow the instructions to restart the system. If the functions still cannot work after rebooting, try to use the product in another location.

## POWER CORD

When you unplug the power cord from the outlet, please grasp it by the head to take it out.

Don't pull the cord out or it will risk getting damaged. Avoid using with a power strip, as it may overheat the socket.

If you're using a different power adaptor with this product, you may risk causing a fire or electric shock. For safety, disconnect the power plug when not in use or during a thunderstorm.

## CONNECTION

Before connecting the product to other devices, turn off the power on all devices. This will prevent equipment failure and damage.

## PLACEMENT

In order to avoid deformation, discoloration, and other damages to the product, do not use under the following conditions:

- Under direct sunlight or heat
- Places that are dusty, hot, humid, or have strong vibrations.
- Close to magnetic fields.

## INTERFERENCE TO OTHER DEVICES

When this product is placed around TV's, radios, or cellphones, it can cause interference. When using this product, please keep a distance from TV's, radios, and cellphones.

## PRODUCT CARE

To clean the device, use a soft and dry cloth. Do not use paint thinners, solvents, cleaning fluids, or chemicals on the cleaning cloth. Do not apply too much force on the On/Off button.

The piano is best stored in the following conditions: 59-95 degrees fahrenheit, and a humidity level of 75%.

## DISPOSAL

Avoid getting paper, metal, and other debris into the device. If it happens, unplug the power cord from the wall. Follow up with a professional to inspect the equipment. Before moving the product around, please disconnect the power supply.

# SPECIFICATIONS

---

NAME	SPECIFICATIONS
Appearance	Portable smart piano
Keyboard	61 non-weighted keys, standard piano keyboard texture
Polyphony	128 Polyphony. Same note.
Sound	417 timbres, 16 folk instruments, 9 percussion sets, 603 drum sounds, 256 GM2 tones. When used alone, the piano preset with 20 instruments.
LED	61 red back-lit LEDs
Pedals	Note sustain function
Device Connection	iOS 9.0 + iPhone 5S/6/6Plus/SE/7/7Plus/8/X iPad 2/4, New Pad, iPad mini 1/2/3/4, iPad Air 1/2, iPad Pro
Audio socket	One 1/8" headphone socket
Mic socket	One 1/4" external microphone socket
Auxiliary input	One 1/4" auxiliary input socket
Auxiliary output	One 1/4" auxiliary output socket

NOTE: When specifications are subject to change, refer to the actual product.

# TROUBLESHOOTING

---

ISSUE	HOW TO FIX IT
There is noise when the instrument is turned on or off.	This is normal, there is nothing that needs to be fixed.
The piano makes no sound when playing the keyboard.	Check that the volume isn't too set too low, and check if the headphone jack is in.

# CONTACT US

---

**Email:** [support@smartpiano.com](mailto:support@smartpiano.com)

**Facebook:** [facebook.com/onesmartpiano](https://facebook.com/onesmartpiano)

**Skype:** smartpiano



The**ONE**  
— MUSIC GROUP —

NO.1805030