

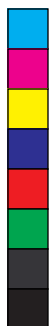

USER GUIDE
The ONE Keyboard Pro

www.smartpiano.com





Parts List

Thanks for purchasing The ONE Keyboard Pro. First, please unpack the shipping carton and check all items carefully. If any item contained is damaged or missing, please contact <support@smartpiano.com>. Also, you may want to keep the packing materials in case you need to ship the unit in the future.

The package should contain the following items:

- Piano body

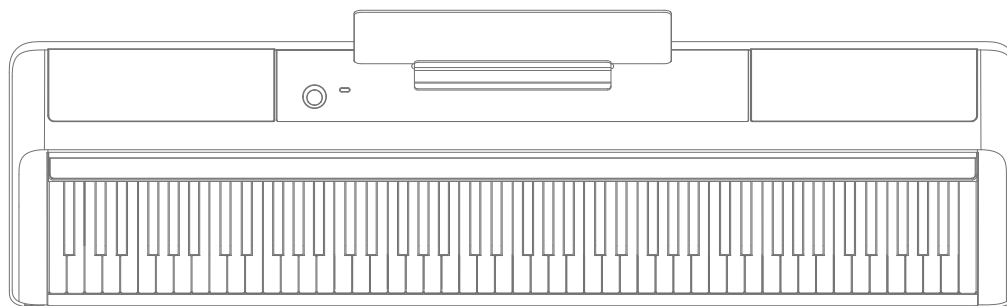

- Power source DC 15V

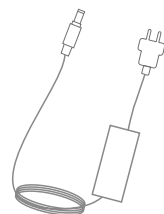

- User guide



- Cables

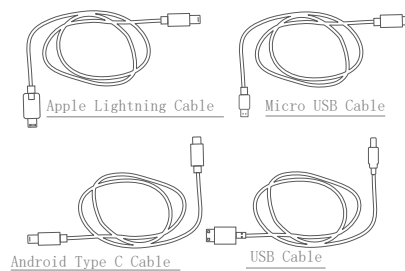

- Search "The ONE Smart Piano_by The ONE" on App Store or Google Play

For more information, please visit:
<https://www.smartpiano.com/pages/app>

Product Introduction

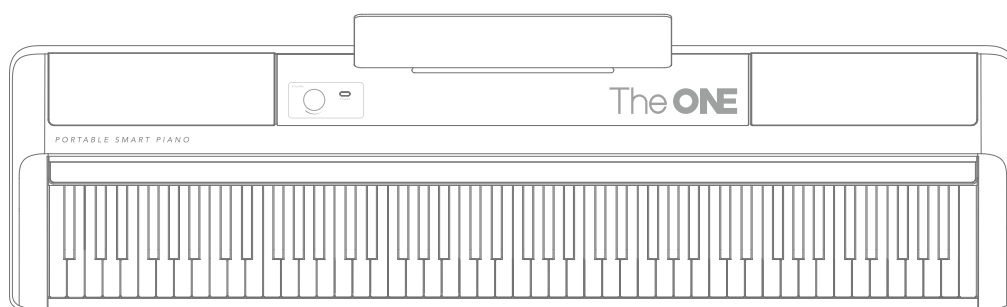
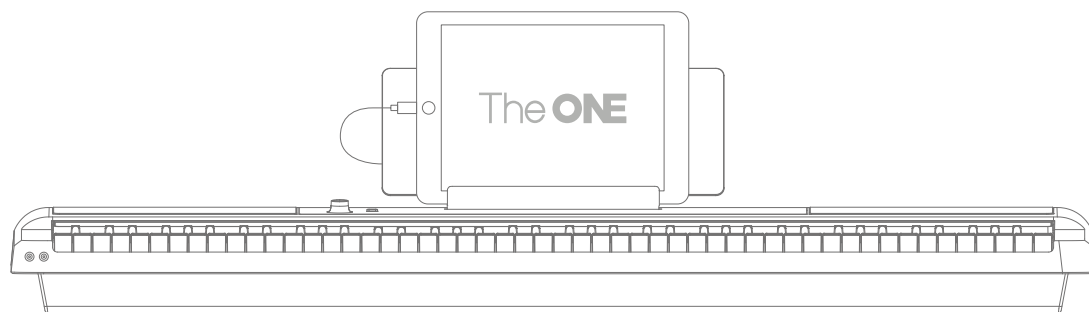

The ONE Keyboard Pro is an 88-key portable keyboard instrument that can teach you to play. It is designed for both beginners and experienced players. By using the dedicated cables, you can connect the keyboard to Android or Apple smart devices using the cables included in this package (Android 4.4+ with USB Host or iOS 9.0+ is required, iPad 1 is not supported). With "The ONE Smart Piano_by The ONE" APP, you can extend more functions.

Setup

This section contains information about setting up your instrument and preparing to play. Please read through this carefully before turning the power on.

Power Supply

Before turning the power on or off, please set the volume level of instrument and connected audio device to the minimum volume.

1. Connect the AC/DC power adaptor to the DC jack.
2. Plug the AC/DC power adaptor into an appropriate AC outlet (100–240V).
3. Press the [POWER] button. The indicator of volume knob is lighted indicating the instrument is powered on.
4. Press the [POWER] button again. The power will be turned off.

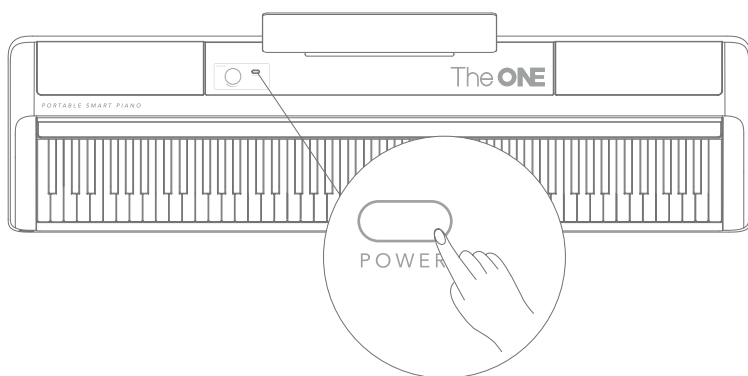
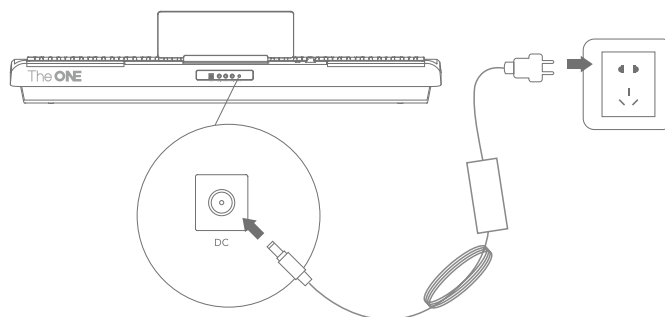

! Note:

For your safety, please unplug the instrument when it is not in use or during the thunderstorm.

Using the Music Stand

Simply insert the music stand into the base and put the base into the slot on the keyboard. You can use this stand to place smart device or sheet music.

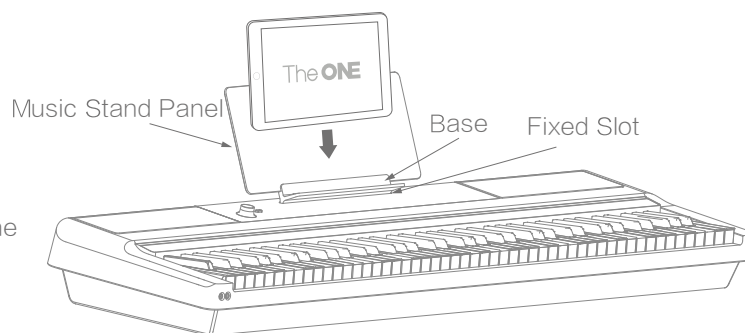

Panel Control

Main Panel

- 1** Master Volume/ Sound Selection Button
Pressing the button can switch two modes: Master volume control and Sound selection.

The initial state is Master volume control. Turn the knob to the right to increase and to the left to decrease the volume.

In the Sound selection mode, 88 timbres can be switched by rotating the button. The LED light corresponding to each timbre on the keyboard will light up.

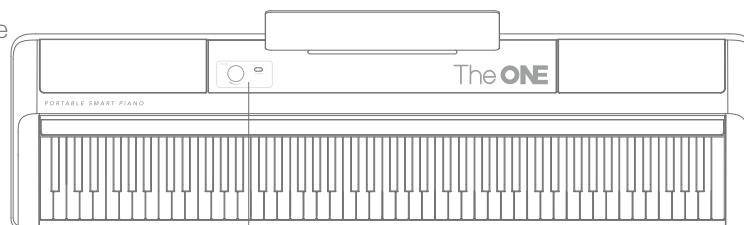

- 2** Power Button

Turn the power on or off. When the power is on, the volume indicator will light up.



Rear panel

- 3** iOS/Android Device Jack

iOS/Android smart devices can be connected via dedicated cables.

- 4** Sustain Pedal Jack

Add the pedal effect by connecting to an external pedal.

- 5** 6.35mm AUX OUT Jack

Connect to external audio output devices, to stream audio from the keyboard.

- 6** 6.35mm AUX IN Jack

Connect to external audio source, to play the audio through the keyboard's speakers.

- 7** DC IN (15V)

Connect the DC 15V power.

- 8** Pedal Jack

Soft, sostenuto and sustain (with half pedal) can be used by connecting pedals.

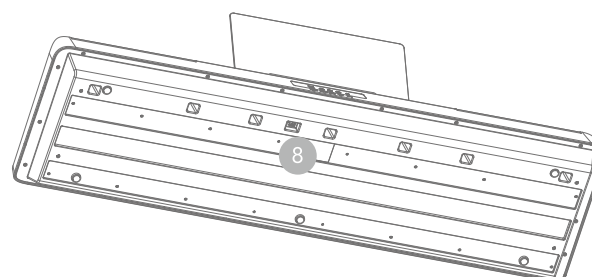
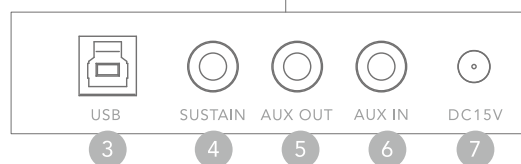
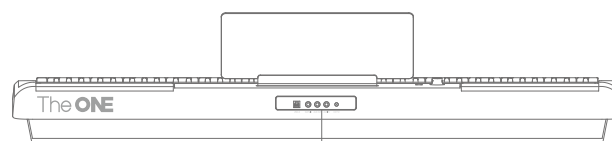

External Connectivity

Connecting the Smart Devices

To bring endless fun to music playing, we are integrating smart devices, entertainment, and music learning into The ONE Keyboard Pro. You can plug iOS 9.0 or later Apple devices (iPad 1 is not supported) and Android 4.4 or later USB Host/OTG Android devices to discover more fun surprises.

Two-way USB MIDI Data Transmission

Once The ONE Keyboard Pro is connected to your smart device, you can record sounds from your smart device. You can also use it as a speaker for your smart device to play stored MIDI files.

USB Audio Playback

Use The ONE Keyboard Pro as a high quality external speaker to stream music from your smart device by simply connecting it.

Download APP to get more functions

We created "The ONE Smart Piano_by The ONE" to provide various additional features.

! Note:

Before connecting other devices, please make sure that all the power is off. And set all the volume level to the minimum volume before turning the power on.

Connecting Headphones

When you need to practice in silence, a pair of headphone can be plugged in as illustrated.

Once plugged in, the instrument sound can only be heard through the headphone instead of the speaker.

! Note:

1. Please avoid using the headphone in high volume for a long time, since it may cause the auditory fatigue, even permanent hearing loss.
2. The headphone jack is standard 3.5mm size.

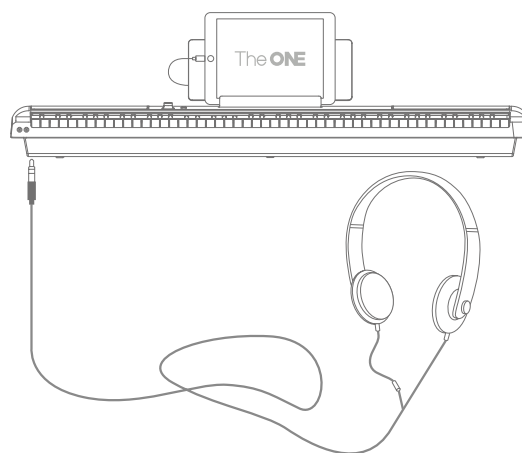
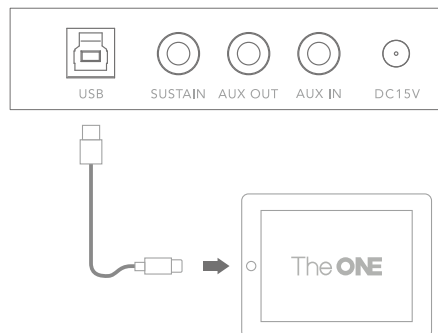

External Connectivity

Connecting to Audio Equipment

The keyboard amplifier, stereo sound system, mixing console, or other audio devices can be connected via 6.35mm AUX OUT jack.

Note:

Before connecting other devices, please make sure that all the power is off. And set all the volume level to the minimum volume before turning the power on.

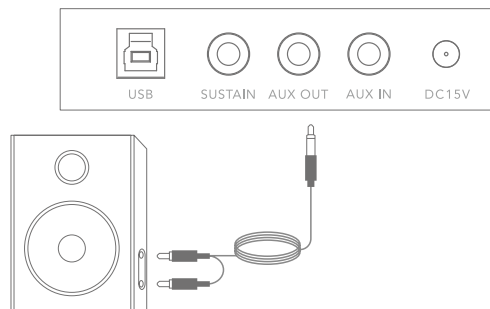

Connecting the MP3/CD Player

MP3/CD player or other audio source can be connected to your instrument via the 6.35mm AUX IN jack on the rear panel.

Connect one end of the audio cable to the 6.35mm AUX IN jack, the other end to the MP3/CD player. Then you can enjoy your favorite music played from the keyboard speaker.

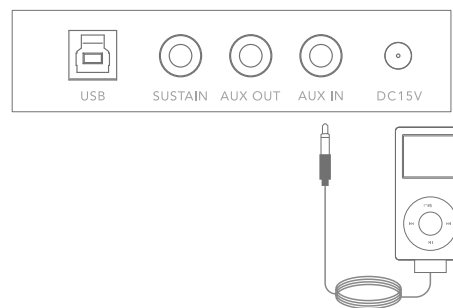

Connecting the Sustain Pedal

The sustain pedal can make the notes sustain more naturally and enrich the ambiance, which is available as an optional purchase.

Insert the pedal plug into the jack as shown, and use it to turn on or off the sustain effect.

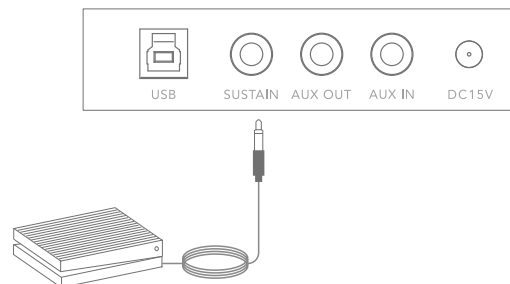

Connecting the Pedal

The pedal is not included in the package. However, you may purchase the keyboard pedal to produce sustain effects.

Insert the pedal plug into the jack as shown, and use its sustain effect.

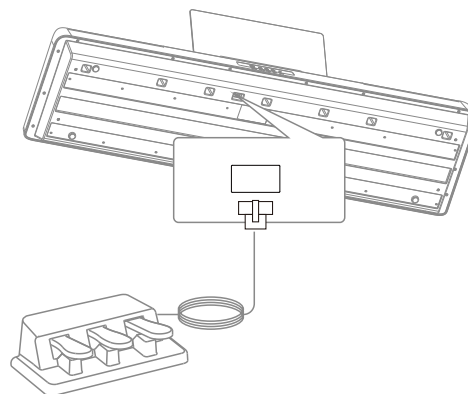

Basic Operations

Power switch

Use the Power Adapter

1. First, make sure the AC adapter is correctly connected.
2. Press [POWER] button. The indicator around the volume button will light up, and enter the Master volume control mode in the initial value, which means the power is on.
3. Press the button to enter the 88 timbres selection mode and rotate the button to switch. After selecting the timbre, press the button to switch to Master volume control mode.

Note:

If the indicator is not lighted after you press [POWER] button, please check whether the adapter is correctly connected.



Function Extension

Note:

This page only lists the function your instrument can achieve. Please refer to the instruction of APP for more details.

Selecting More Sounds

691 timbres ,11 drum sets and 256 MIDI timbres can be selected in "The ONE Smart Piano_by The ONE" APP.

Note:

1. Please refer to the instruction of APP to get the information of setting up the smart device.
- 2.The instrument will switch to grand piano sound when it works independently.

Transpose

You can set the tune in semitone via smart devices without changing the way you play. The adjustable range is ± 12 .
Go to My Account > Sound settings > Sound setting > Transpose settings

Octave

You can set the entire keyboard sound in octave via smart devices. The adjustable range is ± 1 .
Go to My Account > Sound settings > Sound setting

SAFETY & MAINTENANCE

Please read carefully before proceeding.
Please keep this manual for future reference.

Warning

Functions of the product may be subject to strong electromagnetic interference. If it happens, simply follow the user manual to restore the initial settings. If the functions still cannot work after rebooting, try to use the product in another location.

Power

Please don't pull the cord directly when pulling the plug from outlet, otherwise the cord may get damaged. Please don't connect the device to the outlet through multiple connectors, otherwise, it may result in outlet overheating. Using other adaptor may cause the fire or electric shock. Please unplug the power during the thunderstorm.

Connection

To prevent unexpected damage, please turn off the power before connecting other devices.

Location

In order to prevent deformation, discoloration or more serious damage, avoid exposing the instrument to the following conditions:

- Direct sunlight
- Extreme temperature or humidity
- Excessive dust or dirt
- Strong vibrations or shocks
- Strong magnetic fields

Interference with other electrical devices

Radios or televisions placed nearby may experience reception interference. Please place the instrument at a suitable distance from radios or televisions.

Cleaning

Clean only with a soft, dry cloth. Please do not use the cloth soaked with paint thinners, solvents, cleaning solutions or chemicals.

Please do not use excessive force on the buttons or switches.

The best environment for use is:

Temperature: 15 °C ~ 35 °C Humidity: 75%

Handing caution

Avoid getting paper, liquid, metal or other things into the instrument. If this happens, unplug the power adaptor and have the instrument inspected by qualified maintenance personnel.

Turn all the power off before moving the instrument.

Specifications

Keyboard	88-key graded hammer action piano keyboard
Polyphony	128
Timbres	88 preset timbres in the keyboard. 691 timbres, 11 drum sets, 256 GM2 imbres can be selected when connected to "The One Smart Piano" App.
LED	88 full color LED lights
Pedal	Sustain pedal
Supported devices	Android 4.4+, support USB host/OTG iOS 9.0+, excluding iPad 1
Headphones	Two 3.5mm headphone jacks
AUX IN	6.35mm AUX IN jack
AUX OUT	6.35mm AUX OUT jack
Pedals	Sustain (with half pedal), Sostenuto, Soft

* Note: Specifications are subject to change.
Please refer to the machine for actual data.

Trouble shooting

Problem	Possible cause and solution
A noise is heard when tuning on or off the keyboard	A slight humming noise is normal when start or turn off the keyboard.
Speakers do no work when playing the keyboard	Check if the volume is too low or completely turned off. Then check if anything is plugged into the headphone jack.

Please contact <support@smartpiano.com> if you have more questions.





The ONE[®]
— MUSIC GROUP —

NO.1806004

改编号: NO 1805029

