



User Manual

E129



Important Note

Please read the manual to learn the function of the this product before operation.

Damage to the product and potential personal injury may occur if you make an operational error.

This is a RC helicopter, not a toy. You should not only have a prudent operation, but also to have an operational basis. All children using it should be under adult supervision. The manual includes safety, operation and maintenance. In order to avoid causing damage or serious injury, please obey the instructions and warnings before you using this product.

Additional safety precautions and warnings

- 1.Recommended age of users: Not suitable for children under 14 years old.
- 2.Operate it in an open space, away from the traffic and people.
- 3.Obey the instructions and warnings, includes the use of optional equipment.
- 4.It has to stay away from chemicals. Small parts and electric equipment must be out of the reach of children.
- 5.Keep away from water because this product has no waterproof function.
- 6.Do not put any parts in the mouth, it will cause injury or death.
- 7.Don't operate the model if the transmitter's battery is in low voltage.
- 8.Don't view the beam of the light emitting diodes, it would effect the eyesight.
- 9.The motor and electric equipment will be heat after flight. Please do not touch them to avoid scald.
- 10.In order to avoid causing damage, please do not touch the high-speed.

Warning And The Guide Of Using Battery



Note: Using the original factory USB charger can ensure charging safety. Suggest you use the original factory USB charger part, other chargers may cause battery damage and property damage.

Warnings! The battery will fire, explode or leak if not strictly observing this item described below. :

1. Do not immerse the battery in water or seawater, and keep the battery in a cool dry environment during stands by period.
2. Keep all batteries out of the reach of little children. Consult a doctor immediately if a battery is swallowed.
3. Do not use or leave the battery near a heat source such as fire or heater.
4. Use the battery charger specifically for that purpose when recharging.
5. Do not reverse the positive (+) and negative (–) terminals.
6. Do not connect the battery to an electrical outlet.
7. Do not dispose the battery in fire or heat.
8. Do not short–circuit the battery by directly connecting the positive (+) and negative (–) terminals with metal objects such as wire.
9. Do not transport or store the battery together with metal objects such as necklaces, hairpins etc.
10. Do not strike or throw the battery against hard surface.
11. Do not directly solder the battery.
12. Do not unpack the battery with a nail or other sharp object.
13. Never disassembling the battery in any way.

Note: The battery can not be placed for a long time under full power and low power.

Otherwise, the battery will not be charged or the battery will be wrapped. For long–term storage, please charge the battery to 3.7V and store it in a dry and safe place.

Helicopter parameters

length	268 mm
Height	80 mm
Weight	52G
Propeller length	249 mm
Tail rotor blade diameter	37 mm
Battery specification	300mAh
Fight time	About 15 min
Main motor	8520
Tail motor	0615
Charge time	About 75 min

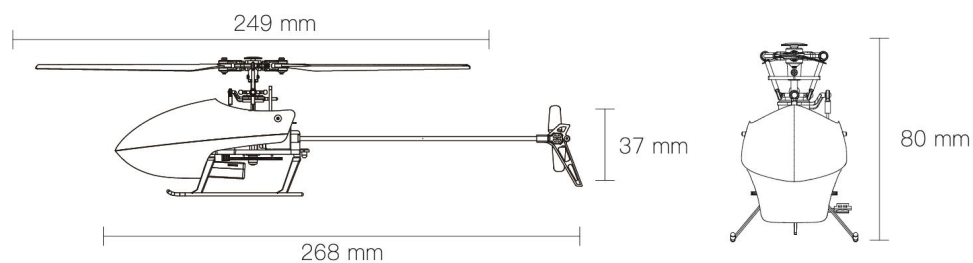

packaging list

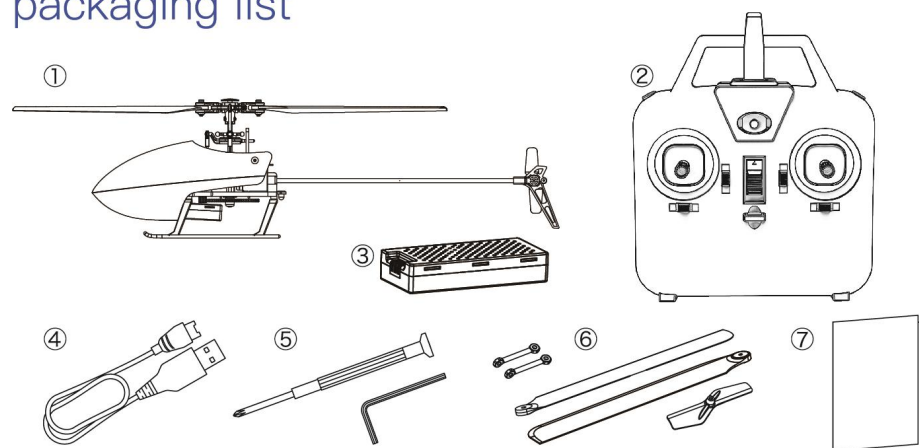

- ① Helicopter ② Remote Control ③ Lipo battery ④ USB charger
⑤ Phillips screwdriver+hex wrench ⑥ Upper connecting rod / Propeller / tail rotor ⑦ Instruction manual

Introduction of transmitter function

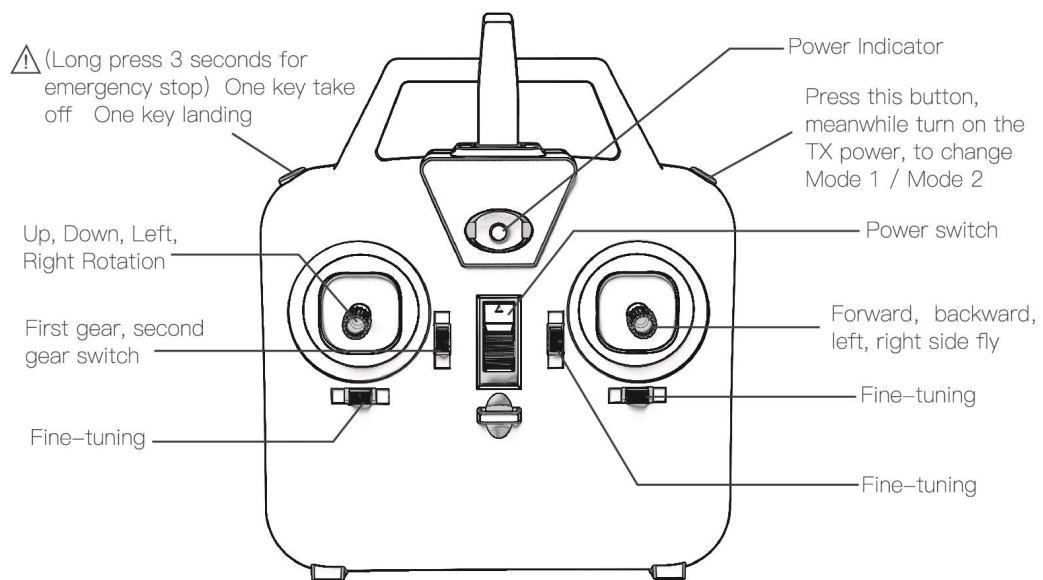

PARTS

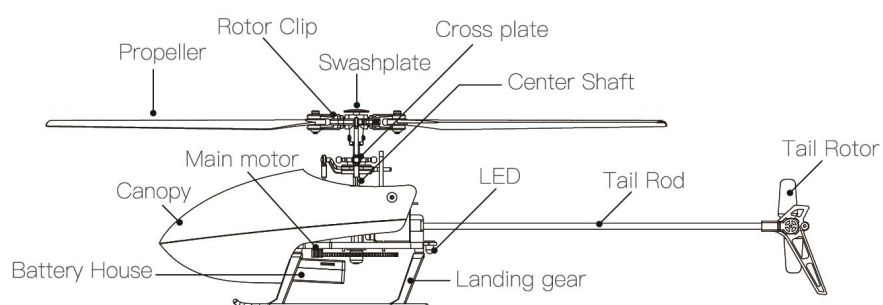

Batteries Charging Method

Charging method 1:

Charging battery by the USB port on a computer.

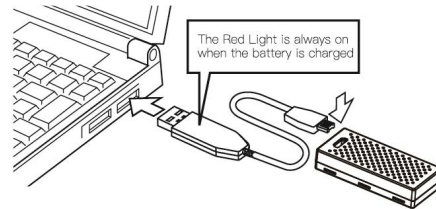

Description:

1. Connect the USB charger with USB port.
2. Connect the battery with USB charger: red light means it is charging, red light out means charging complete.

Charging method 2: Charging battery by power supply adapter.

1. Connect the USB charger with power supply adapter.
2. Connect the battery with USB charger: red light means it is charging, red light out means charging complete.

Charging method 3: Charging battery by power bank

1. Connect the USB charger with power bank .
2. Connect the battery with USB charger: red light means it is charging, red light out means charging complete.

First flight preparation caution

1. ensure sufficient power supply of the transmitter and helicopter.
2. Keep a flight in a suitable space which away from the traffic, people, electricity pylons and pool.
3. Do not lock the main rotor screws too tightly to keep folding smoothly. If the main rotor screws are too tight, the helicopter will shake when flying.
4. Under emergency situation, you can press "sharp stop" button for 3" to land the helicopter without rotating.
(Note: this action may cause helicopter crash.)

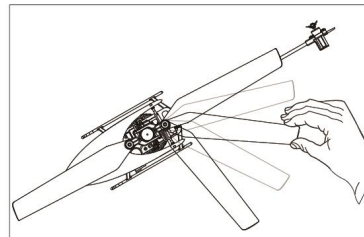

Installation method of remote controller battery

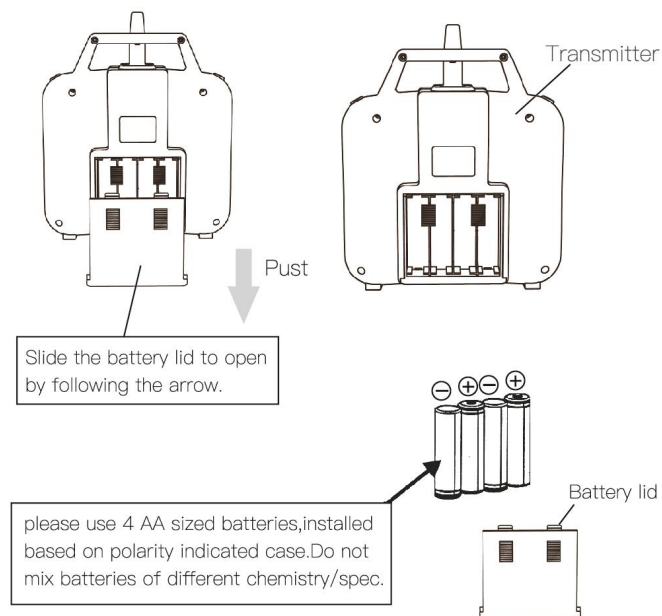

Direction of operation

If you are unfamiliar with the control of the E129, take time to familiarize it before your first flight.

Throttle

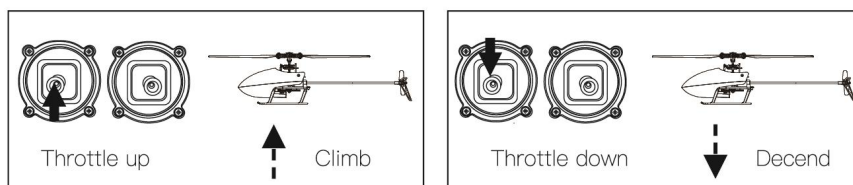

Rudder

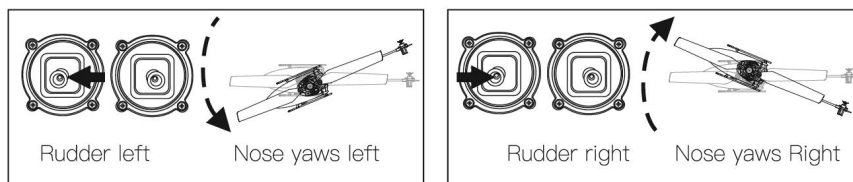

Elevator

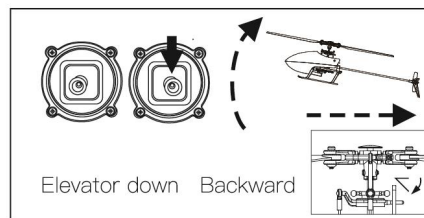
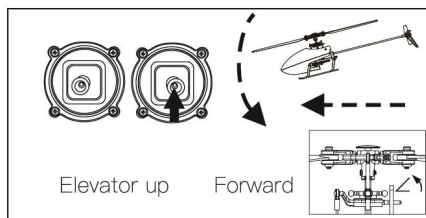

Aileron

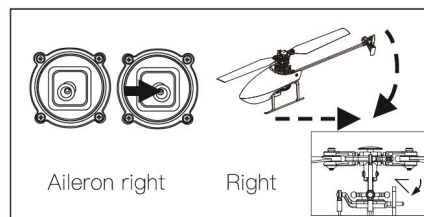
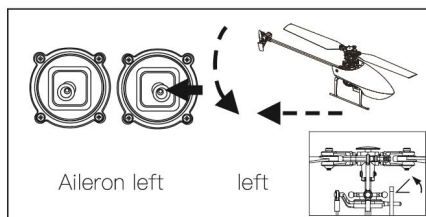

Flight Operation Steps

1. Turn on the transmitter and let helicopter stay near to transmitter.
2. Connect the battery with helicopter.
3. The lights of the helicopter and the remote control flash at the same time. Then push the throttle stick from top to bottom quickly. The remote control makes a 'DI' sound, and the indicator lights of the helicopter and remote control are always on, which means binding successful.
4. Pull the two joysticks to outer eight angles to start the helicopter. (You can also press the one-key takeoff button to take off the helicopter directly.)
5. Keep the helicopter head forward, and keep safe distance with the helicopter.
6. When manually operating the aircraft to land, please keep the throttle stick at the bottom for 2-3 seconds, and then release it after the propeller has completely stopped rotating. (This operation is not required when using the one-key landing function)

△ Note: 1. In order to avoid hitting, do not look at the helicopter at hip level when it fly.
2. In order to avoid distractions, please confirm without other transmitters at work around.

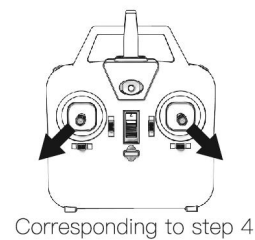
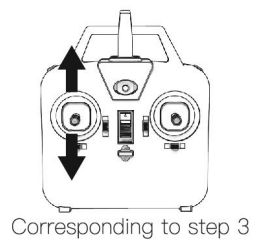
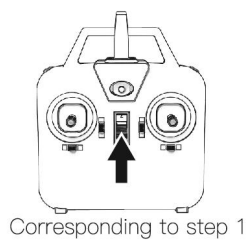

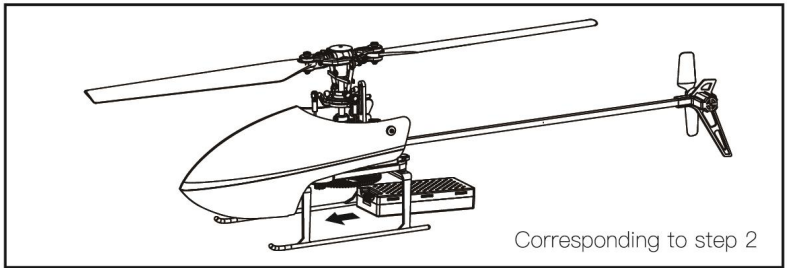

Note: Beginner should pay attention to the direction of flight. Keep the head forward to avoid causing injury .

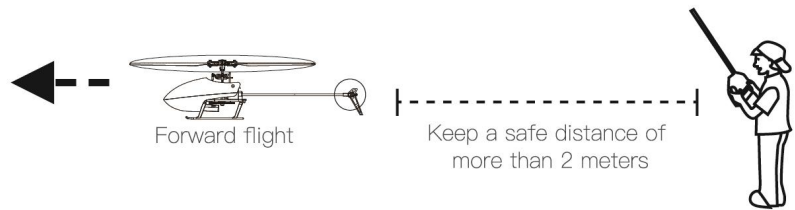

Flight Yaw correction method

Press the trimming button when helicopter has yaw problems.

The helicopter has set up hovering. If you are dissatisfied with hovering or the helicopter have a yaw, please follow there steps to adjust.

Take off with the throttle joystick. According the direction of yaw, press the fine-tuning button in the opposite direction until the plane hovering.

Forward/ backward Yaw			Fine-tune according to the direction of the arrow
Left/right Yaw			Fine-tune according to the direction of the arrow
Side fly Yaw			Fine-tune according to the direction of the arrow

Trimming Notes

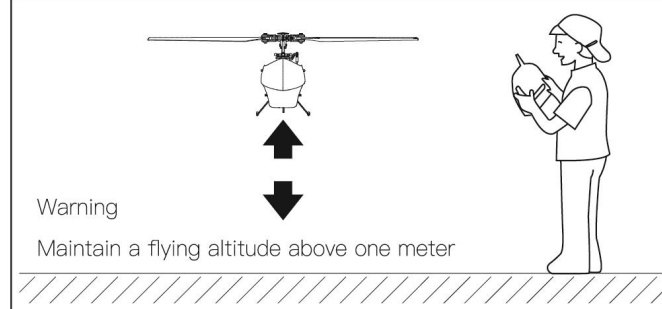

Introduction of the corresponding socket of receiver

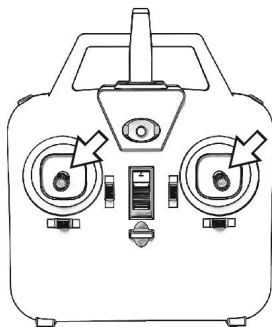
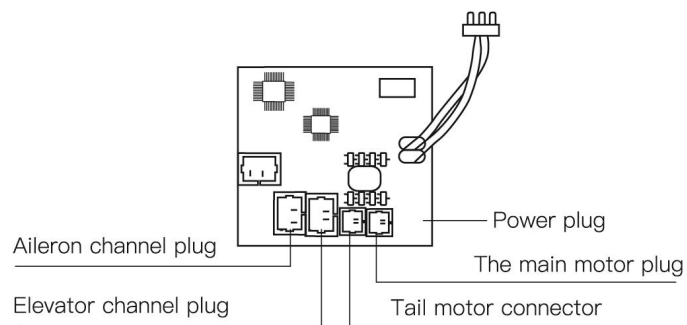

Gyro calibration method

1. When flying yaw, first land and calibrate the gyroscope.
2. When calibrating the gyroscope, the aircraft must be placed on a level ground.
3. The indicator light will flash quickly during the calibration process, the indicator light stops flashing to take off.

Parts replacement instructions

Remove the propeller with a hex wrench,
Be careful not to be too tight when installing
the new propeller

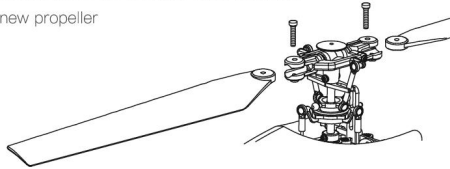

When replacing the tail rod, pull the plug backwards
forcefully, pay attention to the direction when installing,
and align the power cord with the hole.

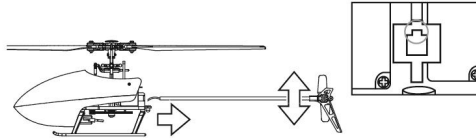

Unplug the plug, then twist the motor
left and right to pull out

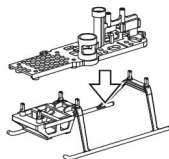

Pull out the landing gear downwards,
and press the corresponding holes when installing.

Pay attention to the connecting rod direction when
disassembling and replacing the servo, as shown:

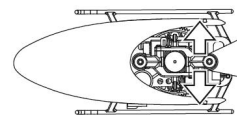
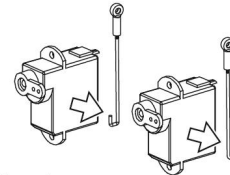

When replacing the receiver, remove the double-sided tape together,
align the new receiver with the edge of the rack and stick it tightly
without skewing, and then connect the servo and the motor in the order of the plugs.

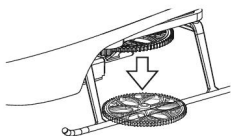
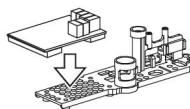

Pull out the big gear straight down, pay attention to the
direction when installing the new gear, and the axis plane
should be aligned with the plane of the inner hole of the gear.

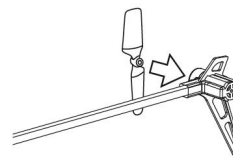

When removing and replacing the tail rotor, please
pay attention to the direction, align the motor shaft
and press it slowly to ensure smooth rotation.



Company: Lotus NL B.V.
Address: Koningin Julianaplein 10, 1e Verd, 2595AA, The Hague,
Netherlands.
E-mail: peter@lotusnl.com
Tel: +31644168999

