



掌上云台相机2使用说明书

使用本产品前请仔细阅读本说明书

PALM 2 Gimbal Camera User Manual

Please read this manual carefully before use

一、产品及部件

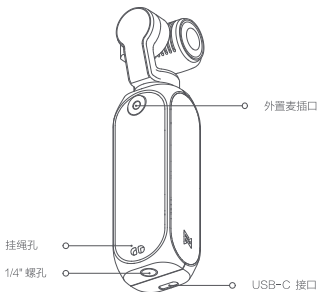
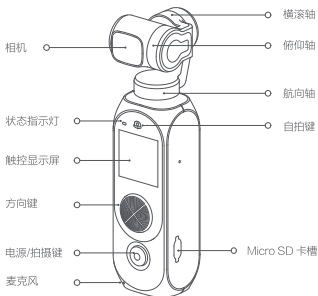

二、充电

使用配送的5V  2A USB-C数据线给云台相机充电,充电过程中,指示灯长亮,充完后,指示灯熄灭(关机状态)

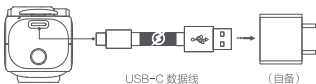

三、外置麦克风的安装

请按下图示意,连接外置麦克风

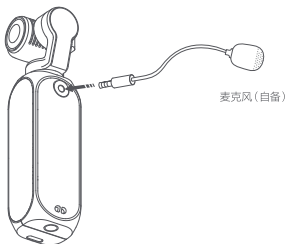

四、安装 Micro SD 卡

请按图示方向安装 Micro SD 卡,推荐使用传输速度等级为U3及以上规格TF卡,最大支持256G,支持格式化操作(需要自备)

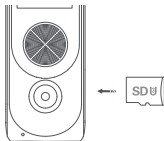

五、操作指南

1. 电源/拍摄键

电源/拍摄键

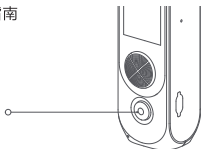

状态	说明
长按	控制云台相机开机或关机
短按	执行拍摄/停止拍摄/在非预览界面时跳转至预览界面
双击	云台恢复中位

2. 方向键

方向键

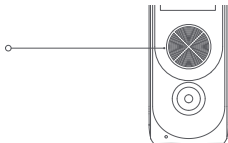

状态	说明	备注
上推	控制相机镜头向上转动	模式 1
下推	控制相机镜头向下转动	模式 1
左推	控制相机镜头向左转动	模式 1
右推	控制相机镜头向右转动	模式 1
上推	数码变焦 (ZOOM) +	模式 2
下推	数码变焦 (ZOOM) -	模式 2
左推	曝光补偿 (EV) -	模式 2
右推	曝光补偿 (EV) +	模式 2
左推+电源键	开机前同时左推方向键和按电源键持续5秒后, 先松开电源键, 再松开方向键, 触发固件强烧模式	模式 1

注: 点击屏幕右上方的 *  * 即可在模式1/模式2中相互切换

3.触控显示屏

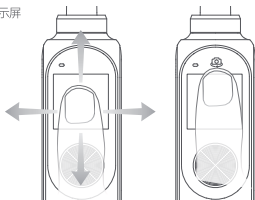

状态	说明
左/右滑	切换相机拍摄模式
下滑	进入设置相关操作
上滑	进入媒体库
双击	开启或关闭人脸跟随
双击自拍键	切换前后置摄像头
长按自拍键	云台恢复中位

4.状态指示灯

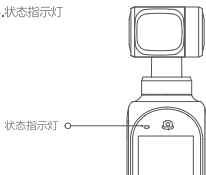

状态	说明
绿灯常亮	正常工作状态
绿灯闪烁	处于拍摄状态
红灯常亮	低电或云台异常状态
红灯闪烁	系统工作异常状态
红、绿灯交替闪烁	固件升级状态

六、安装 APP

请扫描二维码或在应用商店搜索下载安装 FIMI PLAY APP



七、维护与校准

- 1.云台相机在每次开机通电时都会进入自检, 如果自检失败, 请按相关提示进行校准
- 2.云台相机属于精密控制装置, 使用期间请勿摔落或受外力碰撞, 确保云台转动不收外力阻挡, 否则可能使产品损坏无法正常工作
- 3.请勿将电池投入火中; 锂电池在低温条件下容量会大幅度缩减, 请不要在低于零摄氏度下的环境中使用

八、产品中有害物质的名称及含量

部件名称	有害物质					
	铅 (Pb)	汞 (Hg)	镉 (Cd)	六价铬 (Cr(VI))	多溴联苯 (PBB)	多溴二苯醚 (PBDE)
塑料壳	○	○	○	○	○	○
电路板	○	○	○	○	○	○
金属	X	○	○	○	○	○
线缆	○	○	○	○	○	○

本表格依据 SJ/T 11364 的规定编制

○: 表示该有害物质在该部件所有均质材料中的含量均在 GB/T26572 规定的限量要求以下

X: 表示该有害物质至少在该部件的某一均质材料中的含量超过 GB/T26572规定的限量要求

九、基本参数信息

产品名称: 掌上云台相机2

产品型号: YTXJ06FM

产品尺寸: 32.5*35.5*132.5mm

产品净重: 145g (不含配件)

控制精度: $\pm 0.005^{\circ}$

可控转动范围: 航向: $-240^{\circ} \sim +60^{\circ}$ 横滚: $\pm 45^{\circ}$ 俯仰: $\pm 90^{\circ}$

电池容量: 2600 mAh

额定功率: 9.62 W

额定电压: 3.7V

工作温度: $0^{\circ}\text{C} \sim 40^{\circ}\text{C}$

无线连接: Wi-Fi IEEE 802.11 b/g/n

执行标准: Q/BJFMK0006-2017

更多认证信息, 请在该产品设置中的设备信息里查看

十、三包凭证

掌上云台相机产品售后服务严格依据《中华人民共和国消费者权益保护法》《中华人民共和国产品质量法》实行售后三包服务，服务内容如下：

保修政策

- 1.自您签收次日起7日内,本产品出现《掌上云台相机2性能故障表》所列性能故障的情况，经由飞米售后服务中心检测确定，可免费享受退货或换货服务
- 2.自您签收次日起 8 日-15 日内, 本产品出现《掌上云台相机2性能故障表》所列性能故障的情况，经由飞米售后服务中心检测确定，可免费享受换货或者维修服务
- 3.自您签收次日起 12 个月内, 本产品出现《掌上云台相机2性能故障表》所列性能故障的情况，经由飞米售后服务中心检测确定，可免费享受维修服务

掌上云台相机2性能故障表

名称	性能故障表
掌上云台相机2	无法开机，按键无响应
	无法执行拍照录像
	云台不能工作，不能平衡
	电池不能充电
	USB-C 接口连接充电器无反应，不充电
	手柄不能控制云台做出动作
	手柄使用时间、充电时间明显变短
	状态指示灯不能正常点亮
	在产品未使用情况下，发现明显制造缺陷

非保修条例：

- 1.未经授权的维修、误用、碰撞、疏忽、滥用、进液、事故、改动、不正确的使用非本产品配件，或撕毁、涂改标贴、防伪标记
- 2.已超过三包有效期
- 3.因不可抗力造成的损坏
- 4.不符合《产品性能故障表》所列性能故障的情况
- 5.因人为原因导致本产品及其配件产生《产品性能故障表》所列性能故障

制造商：深圳市飞米机器人科技有限公司

地址：深圳市南山区西丽桃源街道学苑路1133号田寮大厦东座2楼

官方网站：www.fimi.com

在线客服：support@fimi.com

服务热线：400-661-0908

1.Product Introduction

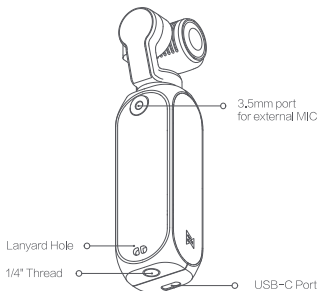
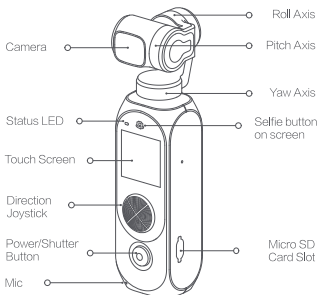

2. Charging

To charge PALM2, please use the included USB cable to connect it with the USB-C port. While charging, the status LED is always on. When the battery is fully charged, the status LED is off.

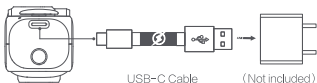

3. The equipment of external MIC

Please equip the MIC as shown.

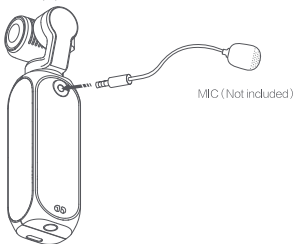

4. Inserting the MicroSD Card

Please insert the MicroSD Card as shown. It is recommended to use a microSD card with or over a UHS-III Speed Grade 3 rating(not included). The PALM 2 supports atmost SD card with 256G, and you can format the SD card on PALM 2.

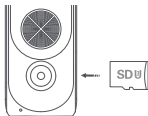

5. Operations

1. Power/Shutter Button

Power/Shutter Button

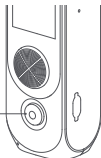

Status	Instruction
Long press	Turn on or turn off the PALM
Short press	Take a capture according to current shooting mode
Double click	To recenter the gimbal

2. Direction joystick

Direction joystick

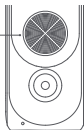

Status	Instruction	Remarks
Move up	To control the gimbal camera move up	Mode 1
Move down	To control the gimbal camera move down	Mode 1
Move left	To control the gimbal camera move left	Mode 1
Move right	To control the gimbal camera move right	Mode 1
Move up	ZOOM +	Mode 2
Move down	ZOOM -	Mode 2
Move left	EV -	Mode 2
Move right	EV+	Mode 2
To flash the PALM 2	When the PALM 2 is off, move the direction joystick to the left and press the power button simultaneously for 5 seconds. Let go of the power button first, then to the direction joystick	Mode 1

P.S. Click the "  " on the top right of screen to switch mode 1 and mode 2.

3. Touch Screen

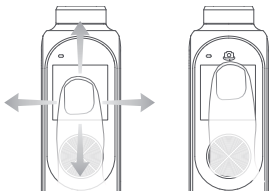

Status	Instruction
Swipe right/left	To switch shooting mode
Swipe down	To enter setting mode
Swipe up	To enter media library
Double click	Turn on / turn off Face Tracking
Double click the selfie button	To switch selfie mode
Long click the selfie button	To center the gimbal

4. Status LED

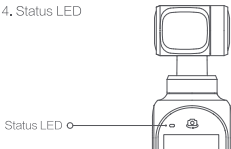

Status	Instruction
Green light is on	Normal
Green light flashes	Recording
Red light is on	Low battery or the gimbal is abnormal
Red light flashes	System is abnormal
Red and green light alternatively flash	Firmware is updating

6. Downloading APP

Please scan the QR code or search for downloading the FIMI PLAY APP in APP Store or Google Play



7. Maintenance and Calibration

1. The PALM 2 enters the self-check when it is powering.
2. Gimbal camera is a high-precision control device. Please do not drop it or have it hit by external force. And please ensure that the gimbal doesn't be blocked by outside forces when it is moving. Otherwise, the machine might be damaged and be led to abnormal operations.
3. Do not place the battery near heat. Lithium battery's capacity reduces significantly in low temperature conditions. Please do not use the PALM 2 if the temperature is below 0 celsius degree.

9. Basic Specification

Name: PALM 2 Gimbal Camera

Model: YTXJ06FM

Dimensions: 32.5*35.5*132.5mm

Net Weight: 145g (accessories are not included)

Precision Control: $\pm 0.005^{\circ}$

Rolling Angle: YAW: $-240^{\circ} \sim +60^{\circ}$ ROLL: $\pm 45^{\circ}$

PITCH: $\pm 90^{\circ}$

Battery Capacity: 2600 mAh

Rated Power: 9.62 W

Rated Voltage: 3.7V

Operating Temperature: $0^{\circ}\text{C} \sim 40^{\circ}\text{C}$

Wireless Connectivity: Wi-Fi IEEE 802.11b/g/n

Product standard: Q/BJFMK0006-2017

Check more detailed information in setting

This device complies with Part 15 of the FCC Rules. Operation is subject to the following two conditions:

- (1) this device may not cause harmful interference, and
- (2) this device must accept any interference received, including interference that may cause undesired operation.

Any Changes or modifications not expressly approved by the party responsible for compliance could void the user's authority to operate the equipment.

Note: This equipment has been tested and found to comply with the limits for a Class B digital device, pursuant to part 15 of the FCC Rules. These limits are designed to provide reasonable protection against harmful interference in a residential installation. This equipment generates uses and can radiate radio frequency energy and, if not installed and used in accordance with the instructions, may cause harmful interference to radio communications. However, there is no guarantee that interference will not occur in a particular installation. If this equipment does cause harmful interference to radio or television reception, which can be determined by turning the equipment off and on, the user is encouraged to try to correct the interference by one or more of the following measures:

- Reorient or relocate the receiving antenna.
 - Increase the separation between the equipment and receiver.
 - Connect the equipment into an outlet on a circuit different from that to which the receiver is connected.
 - Consult the dealer or an experienced radio/TV technician for help.
- The device has been evaluated to meet general RF exposure requirement. The device can be used in portable exposure condition without restriction.

Manufacturer: Shenzhen Fimi Robot Technology Co., Ltd.
(a Mi Ecosystem company)

Address: 2nd Floor, East Block, Tianliao Building, 1133 Xueyuan Avenue, Xili Town, Nanshan District, Shenzhen City, China

Official website: www.fimi.com

Online service: support@fimi.com

TEL: 400-661-0908