

Dreame Cordless V9 Vacuum Cleaner User Manual

Important safety Instructions

Before using dreame vacuum cleaner please read user manual carefully.

Warning

This appliance can be used by children aged from 8 years and above and persons with reduced physical, sensory or mental capabilities or lack of experience and knowledge if they have been given supervision or instruction concerning use of the appliance in a safe way and understand the hazards involved. Children shall not play with the appliance. Cleaning and user maintenance shall not be made by children without supervision.

DO NOT allow young children to operate the appliance or use as a toy. Close supervision is necessary when any appliance is used near children.

DO NOT use outdoors or on wet surfaces. Use only on dry surfaces.

DO NOT handle charger or vacuum cleaner with wet hands.

Inspect Battery Pack and chargers for any damage before use.

DO NOT use vacuum cleaner with a damaged power pack or charger.

DO NOT immerse in water when cleaning, make sure that all filters are thoroughly dry after routine cleaning.

Always turn off this appliance before connecting or disconnecting floor nozzle.

DO NOT use without Soft Roller, dust cup door, and all filters in place.

Use only with YLS0241A-K300080, YLS0241B-K300080 supply unit. **WARNING:** For the purposes of recharging the battery, only use the detachable supply unit provided with this appliance.

DO NOT vacuum up flammable or combustible materials (e.g., lighter fluid, gasoline, or kerosene) or use vacuum in areas where they may be present.

DO NOT vacuum up toxic solutions (e.g., chlorine bleach, ammonia, or drain cleaner).

DO NOT vacuum up drywall dust, fireplace ash, or embers.

DO NOT use as an attachment to power tools for dust collection. DO NOT vacuum up smoking or burning objects such as hot coals, cigarette butts, or matches.

DO NOT vacuum up hard or sharp objects such as glass, nails, screws, or coins that could damage the vacuum cleaner.

Keep floor nozzle and vacuum cleaner away from hair, face, fingers, uncovered feet, or loose clothing.

DO NOT put any objects into openings. DO NOT use with any opening blocked, keep free of dust, lint, hair, and anything that may reduce airflow.

DO NOT place vacuum cleaner on unstable surfaces such as chairs or tables.

Appliance should only be serviced by a qualified repair person using only identical replacement parts. DO NOT modify or attempt to repair the appliance or the power pack yourself, except as indicated in the instructions for use and care.

Follow all charging instructions and DO NOT charge the vacuum cleaner outside of the temperature range (0°C~40°C). Charging improperly or at temperatures outside of the specified range may damage the battery pack and increase the risk of fire.

Do not charge and use vacuum cleaner outdoors, in bathroom or pool, do not use on wet surface or for cleaning rain, water, snow.

This appliance complies with the WEEE-Directive 2012/19/EU on the disposal of electrical and electronic equipment (WEEE).

This marking indicates that this product should not be disposed with other household wastes throughout the EU. To prevent possible harm

to the environment or human health from uncontrolled waste disposal, recycle it responsibly to promote the sustainable reuse of material

sources. To return your used device, please use the return and collection systems or contact the retailer where this product was purchased.

They can take this product for environmental safe recycling.

This appliance complies with the European directives for electromagnetic compatibility (EMC) 2014/30/EU and its revisions, as well as Low Voltage

Directive (LVD) 2014/35/EU and its revisions.

Please read and keep the instructions properly.



Use only with YLS0241u-x300080 supply unit.

Assembly

Getting to know your vacuum cleaner

Product introduction

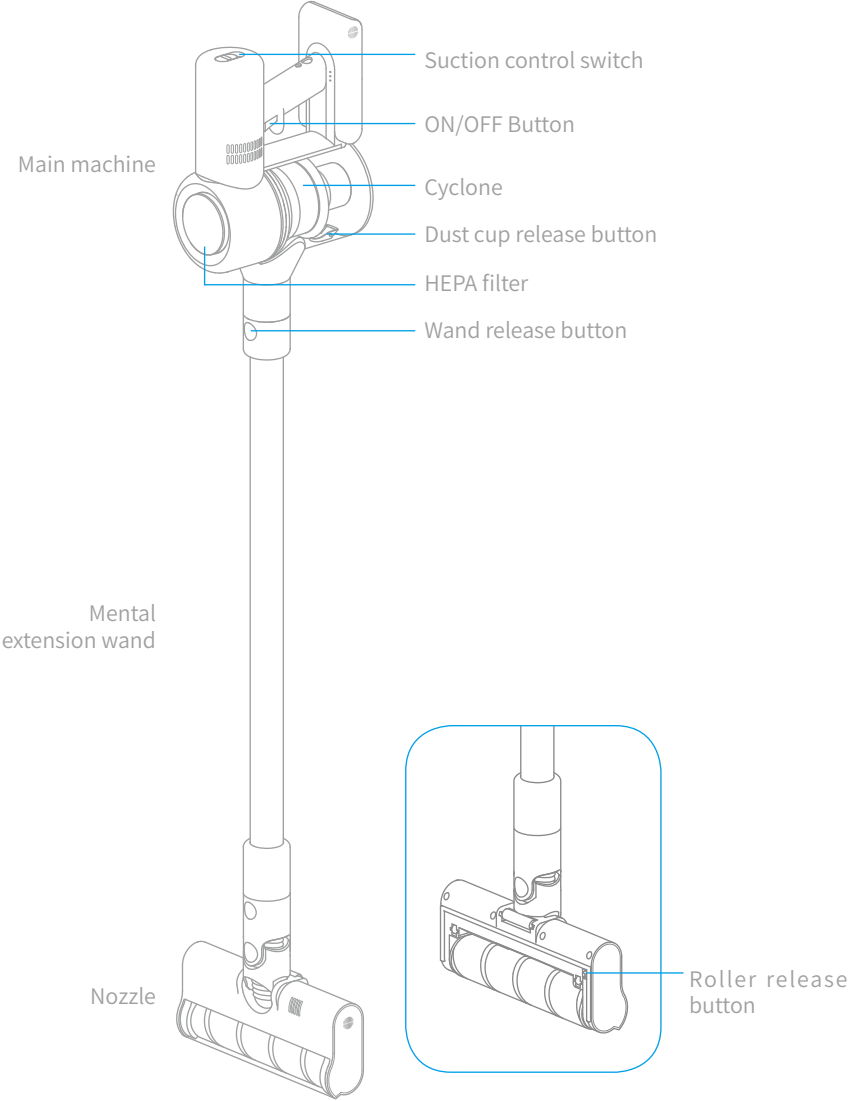

Assembly

Accessories list



2-in-1 Crevice tool

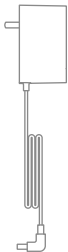

Charger

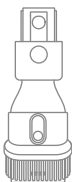

2-in-1 Wide tool

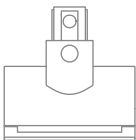

Anti acarids nozzle

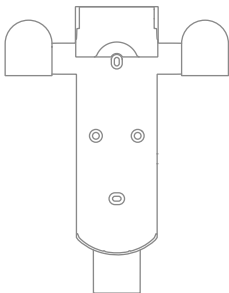

Store base

Assembly

Assembling Procedures

Assembling the nozzle and the wand as picture shown.

Installing the STORE BASE with the SCREW , need drill two holes (φ8mm and 30mm depth) on the wall.

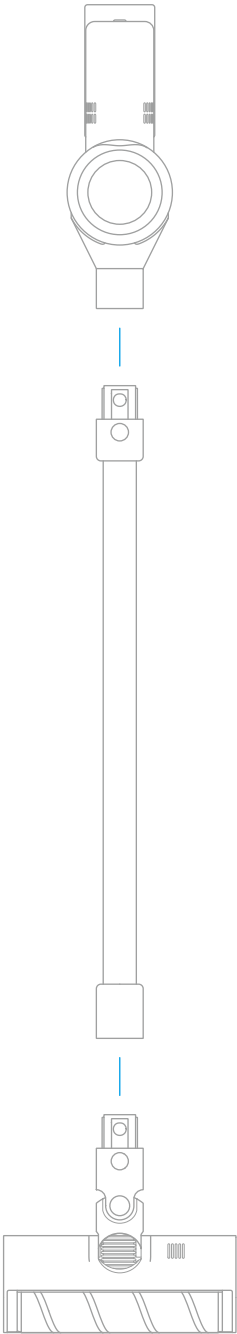

Assembly

Attaching Accessories

Assembling the accessories as picture shown.

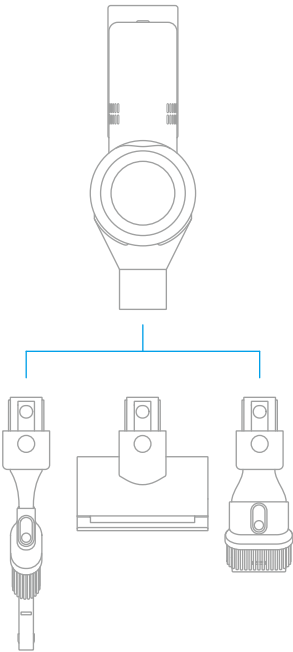

Attaching the accessories and main machine in STORE Base as picture shown

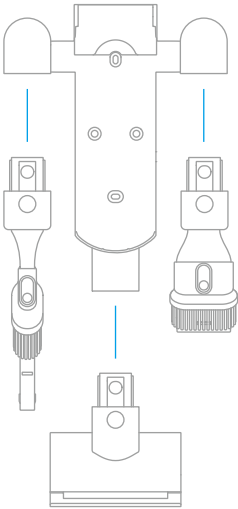

Use your cleaner

Battery charging

Battery may be not fully charged when first time used.charge the battery as below picture.

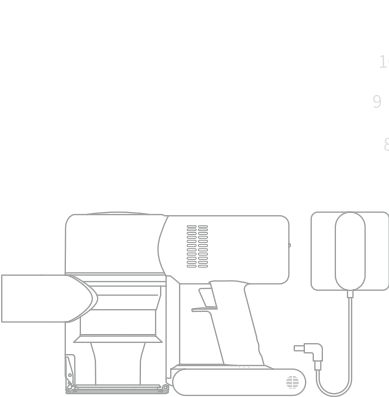

Battery Charging method 1

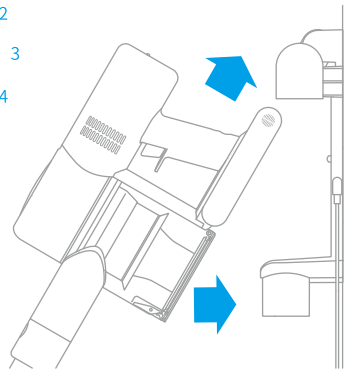

Battery Charging method 2

Indicators status

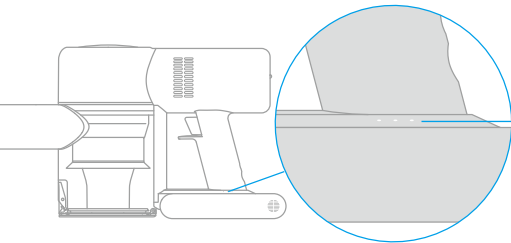

- ● ☀ Low battery
- ☀ ○ Medium battery
- ☀ ○ ○ High battery
- ○ ○ Full battery
- ● ● Full battery (sleep mode)

Use your cleaner

Operations

you can chose different suction setting from low to high mode by setting suction control switch.

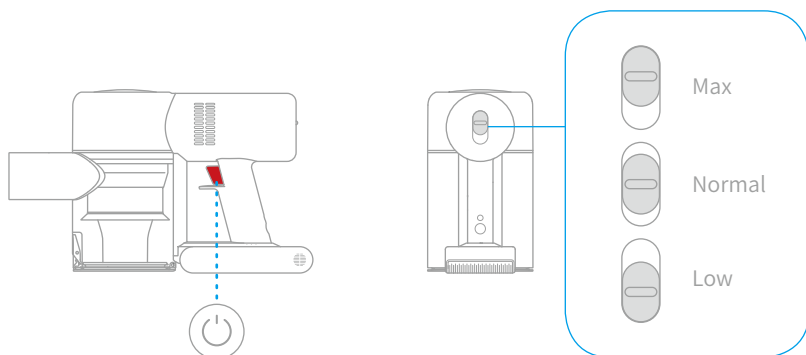

Use of soft-cloth roller

Soft -cloth roller can be used on carpet, hard wood or tile floor.

Vacuum cleaner will shut off nozzle power if nozzle was jamed.

Use of accessories

1. 2-in-1 Flat vacuuming head and anti acarids nozzle;suitable for cleaning suefaces of bed, sofa...etc.
2. 2-in-1 Brush vacuuming head;suitable for cleaning crevices corners...etc.

Maintenance

Cleaning dust cup and HEPA

Empty dust cup by dust cup release button when debris reaches the MAX fill line.

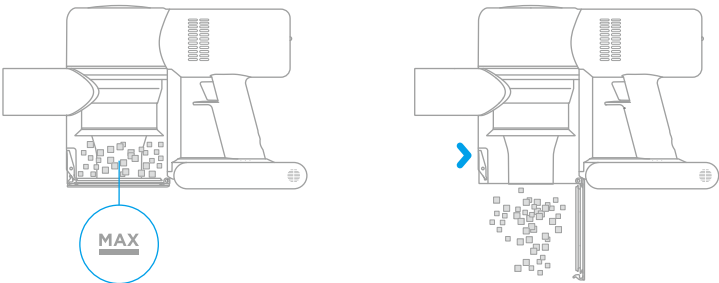

Clean the cyclone as below picture.

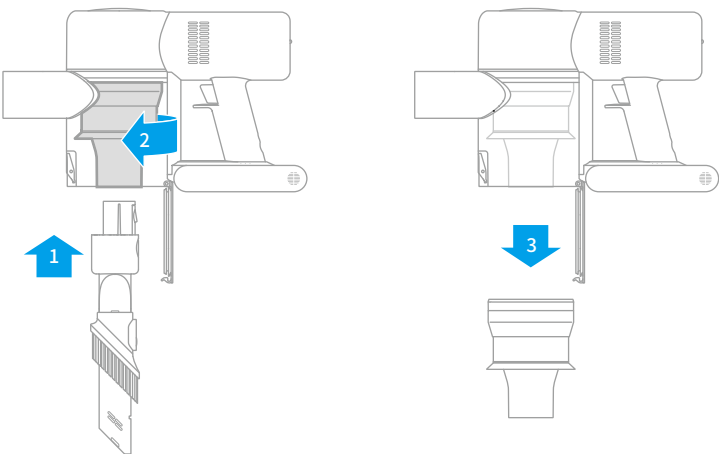

Maintenance

Cleaning dust cup and HEPA

Take off HEPA as below picture
Rinse HEPA with water. Tap loose dirt off HEPA between washes as needed. Once HEPA is completely dry, install HEPA back.

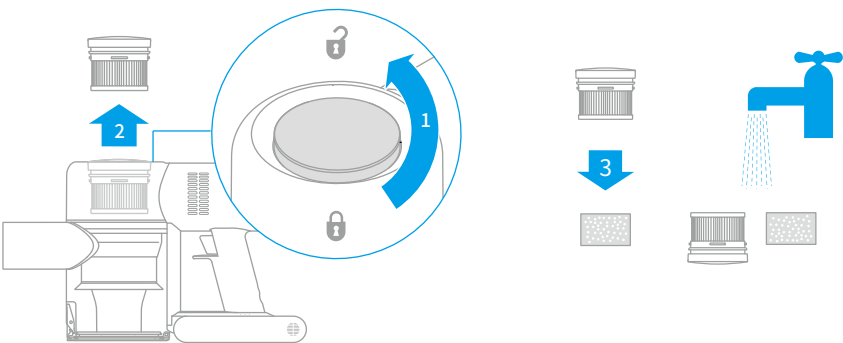

Warning

Make sure HEPA completely dry.

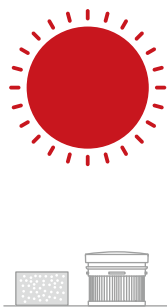

Maintenance

Cleaning sofa roller

Take off soft roller as picture.
Remove any string, hair, or debris that may be wrapped around the soft roller, wheel.

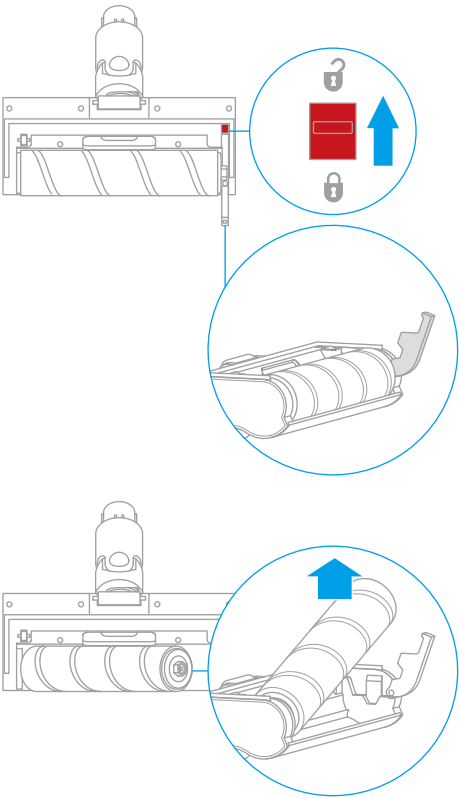

Cleaning anti acarids nozzle

Take off anti acarids nozzle cover.
Remove any string, hair, or debris that may be wrapped around the anti acarids nozzle.

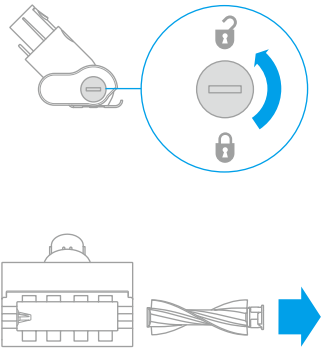

Storage

Remove wand, nozzle, anti nozzle and accessories from main machine, and storge them at room temperature .

Troubleshooting

Problem	Possible cause	Solution
cleaner does not work	Low battery	Charge battery
	No suction	Clean air path
Weak suction	Dust cup and HEPA are dirty	Cleaning cup and HEPA
	Nozzle jamed	Clean nozzle
At starting,the first lamp lights up in red	Battery error	Contact dreame for service
At starting,the first lamp blinks in red	Wrong charger	Use right charger
On startup, the first light flashes	Wrong adapter	Please select the original adapter
Failure on battery charging	Poor charger connection	Make sure of good connection
	Connection is good,but still not working	Contact dreame for service

If none of the measures solved the problem you experience with the product,please contact dreame customer service for assistance.

After-sales services

If assistance is needed in operating dreame vacuum cleaner, please contact customer Service by telephone number: 400 875 9511 ,Send email to www.dreame.tech, or postal mail to Shangjin wan Headquarters, building E3 economic garden ,2288 Wuzhong boulevard, Suzhou, Jiangsu.



Do not operate near flames



Do not rest or charge battery near a heater



Do not try to pick up water or liquid



Do not pick burning subject



Do not put hand close to vacuum head in operation

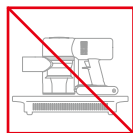

Do not place main machine on or near a stove

