

URUAV UZ85 Quick Guide Manual

1.Frame quick assembly diagram

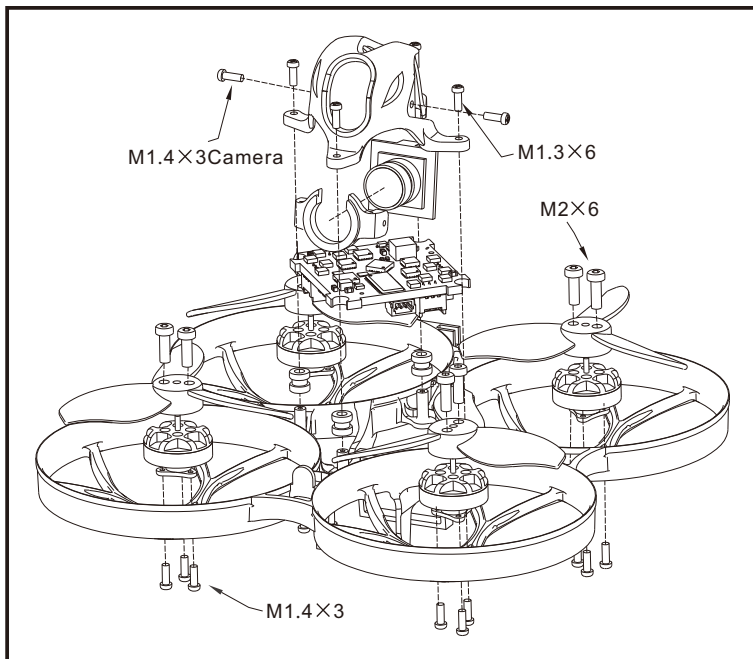

2.Camera connetion

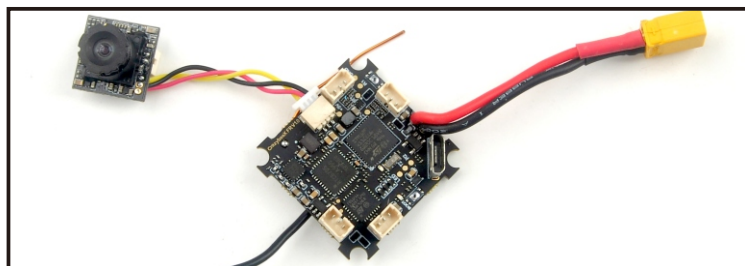

3.Flight controller connection diagram

CrazybeeX FR V2.2

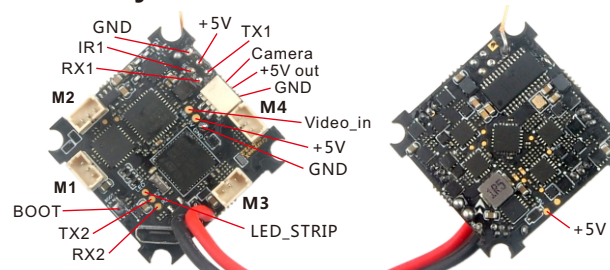

CrazybeeX FS V2.2

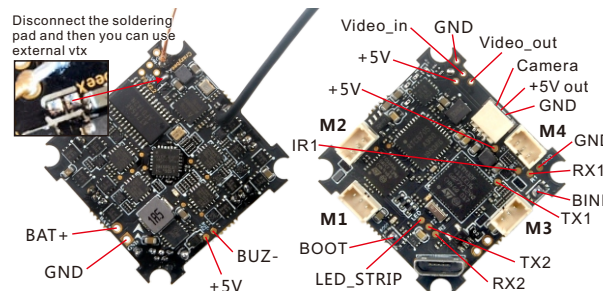

CrazybeeX PNP V2.2

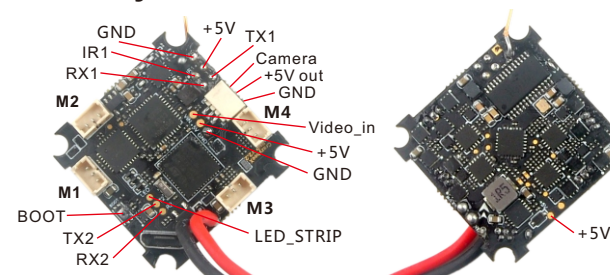

4.Receiver bind procedure

URUAV UZ85 CrazybeeX FR V2.2 Bind procedure:

Make the on board receiver get into bind mode: For 3.5.7 version firmware Plug USB and then press the bind button for 1 second , the Red LED on the top of the flight controller will getting to be solid , this indicate the receiver is in bind mode; For 4.0.x version firmware Plug USB and then connect betafight configurator and then move to CLI tab , type "bind_rx_spi" ,the Red LED on the top of the flight controller will getting to be solid , the onboard receiver is in bind mode; For 4.1.x or 4.2.x the bind code is "bind_rx"Make your Frsky transmitter get into bind mode . If bind is successful the red LED will starting to blink. The red LED wouldn't blinking when binding with some new ACCESS firmware frsky radio , but the bind is actual successful , need to go to CLI command and type "save" to finish the binding .

URUAV UZ85 CrazybeeX FS V2.2 Bind procedure:

Make the on board receiver get into bind mode: For 3.5.7 version firmware Press and hold the bind button for 1 second ,then plug USB, the Red LED at the bottom of the flight controller will blinking fast , this indicate the receiver is in bind mode; For 4.0.x version firmware Plug USB and then connect betafight configurator and then move to CLI tab , type "bind_rx_spi" ,the Red LED at the bottom of the flight controller will blinking fast , the onboard receiver is in bind mode; For 4.1.x or 4.2.x the bind code is "bind_rx"Make your Flysky transmitter get into bind mode . If bind is successful the red led will getting to be solid.

URUAV UZ85 CrazybeeX PNP version bind procedure based on different external receiver .

We already pre-solder the receiver wire for SBUS receiver .

IR1 pad is inverted serial signal used for SBUS receiver

RX1 pad is Non-inverted serial signal for ibus/dsm2/dsmx receiver