

Wireless Battery Video Doorbell

Quick Start Guideline

* Please read it carefully before using the product, and safe keeping

Packing List

After opening the package, please make sure the doorbell (hereinafter referred to as the "Equipment") is in good condition verify parts below is complete.

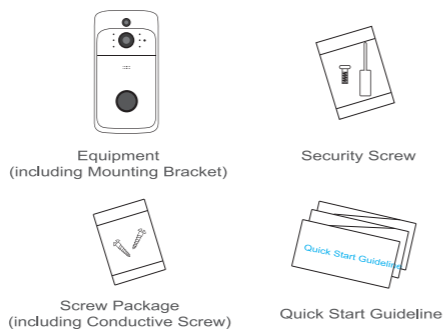

Appearance Introduction

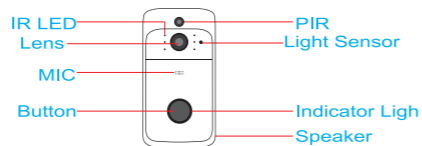

- IR LED** The ambient light is not enough, to enable the infrared light, increase the environmental brightness
- Light Sensor** Used to collect environmental brightness value, when the intensity of illumination is less than 2 Lux, enable the IR LED
- MIC** Audio capture
- Button** The doorbell button
- PIR** When human body movement in front of the equipment, the equipment could be made the notification to your mobile phone.
- Lens** Video image capture
- Indicator Light** Blinking blue: configuration status; Long red light: failed to connect wifi; Blue light is on: the device is connected successfully Red and blue light together: The device is connected to WiFi
- Speaker** Make a sound of the equipment, and voice intercom

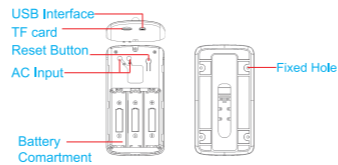

- AC Input** Power is supplied to the equipment by installing the AC input supply hole on the mounting bracket.
- Reset Button** Equipment working status, long press 5 seconds to restore factory settings
- Battery Compartment** Mounting 18650 specification battery.
- Fixed Hole** Fit the support on the wall with the mounting screws for the mounting kit.
- AC Input Hole** The power supply of the equipment can be supplied by connecting the hole and the AC power supply on the wall
- Stuck Hole** Mounting the equipment onto the bracket
- Security Screw Hole** Mounting the security screw on the fittings to prevent the equipment from being removed
- TF card** TF card maximum support 32G

Installation Guide

As shown in the figure, take back

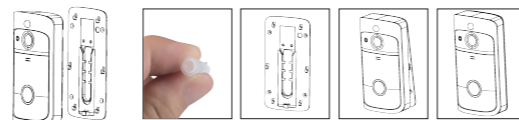

- Use the screws in the mounting kit to fit the bracket on the wall
- The Conductive Screws in the accessories pack are used to connect the AC (16-24V) wire to the AC Input hole (if no AC power is available, this step can be omitted)

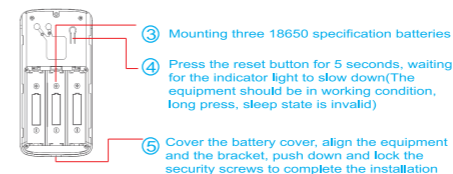

Setup Device

Thank you for choosing our products! Please follow the below instruction to setup and using your doorbell device.

1. Downloading and Installing the App

Open the App Store (for iOS) or the Google Play Store (for Android) on your mobile devices. Search for "WoWCam" scan the following QR Code to download and install to your device.



2. Setting up the App

Before you begin...

- > Make sure the "WoWCam" app is installed to your device.
- > Make sure that your device is connected to a 2.4GHz Wi-Fi network, NOT a 5GHz network.

Add the Smart doorbell

- First open wowcam and click Add device

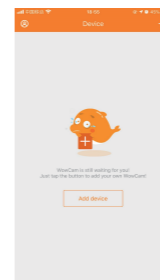

Smart doorbell

- Click Add manually -> then smart doorbell

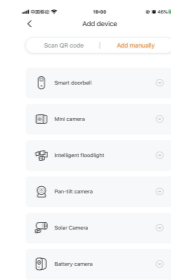

3.)Click smart doorbell DI

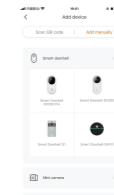

- Install the battery, then check if the blue light is flashing and hear the "Wait for connection" tone, click blue light has flashed.

- The app will automatically fill in the WiFi name, please fill in the correct WiFi password. (for example, in the second connection, under the same WiFi condition, the app will automatically fill in the WiFi password.) click next step

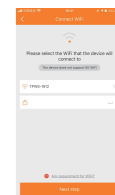

- Scan the QR code below with the camera until you hear "di", click on the next step ("Di Di" sound is heard)



- Device is connected, the prompt "networking succeeded"

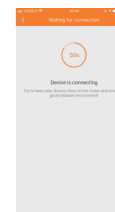

8.)Device connected successfully, click "save"

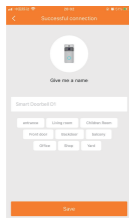

3.Sharing device,choose the way to share

- 1.)Account invitation
- 2.)QR code invitation

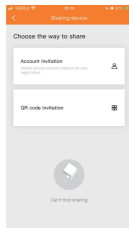
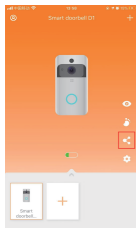

4.Alarm setting

Low -

The device will be able to wake up after device detects human for 7 seconds. Device start to take videos and call the mobile device at the same time.

Medium -

The device will be able to wake up after device detects human for 5 seconds. Device start to take videos and call the mobile device at the same time.

High -

In the state, the device will be able to detect if keep the state what be detected at least 1 second, and the device start to take videos and call to phones at the same time.

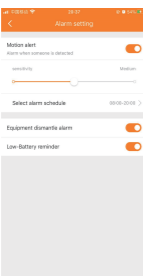

Note: In crowded environment, it is recommended to close or set the device to low sensitivity to reduce device arousal and call times to extend battery life.

6.Note for using

1.) The device is powered by rechargeable lithium batteries. With fully charged, the battery life approx be six months. The mobile device APP will be prompted while the battery voltage is low. Please charge the device after received the reminder.

2.) Keep the camera in range of your router. Make sure to pick a place within range of your network. Thick or insulated doors can greatly reduce the strength of your Wi-Fi signal even if your router is close by, so you should try streaming video before you mount your camera.

3.The device is a low power consumption intelligent products, can support remote wake up from the APP, PIR human detection, press doorbell wake up. The device will be works for 30 seconds after wake up then be in the resting state automatically and until to next waking up.

Technical Specification

| | |
|---------------------|---|
| Resolution | 1920*1080/1280*720(Matching) |
| Field of Angle View | 166° |
| IR LED | 6*850mm |
| Wi-Fi | IEEE 802.11 b/ g/ n |
| Audio | Two-way talk without noise |
| Recording | Device SD Card recording (20 seconds) |
| Storage | Support 8G/16G/32G |
| Battery | 18650 battery(LI-Ion,2600mAh) |
| Monitoring | Device Button, Motion Detection, Remote Live View |
| Notifications | Push Notifications quickly |
| Device Wakeup | Fast wake up and push notification |
| Power Consumption | Power Consumption Standby200 uA, Working170 mA |

i Two18650 specification batteries(total 6800 mAh), work regularly for 8-12 months.

Ding-dong Pairing

(Needs to be purchased separately)

Code Pairing: 1.Short press the button of Ding-dong responder, indicator light is always on

2.Press the button of doorbell to make the code successful

Reset: 1.Press the button of Ding-dong for 5 seconds.

Number of connections: 1 Ding-dong can connect with12 Doorbells;
1 Doorbell can connect with unlimited amount of Ding-dongs.

Function Introduction



LONG BATTERY LIFE:The capacity of the 18650 battery is 2600mAh,which equates to 6 months of battery life



Million HD pixels collocated with wide-angle lens



Support mobile phone remote fast wakeup device within 1 second.



2.4G Wi-Fi connection



High quality two-way talk with noise cancellation



Support PIR motion detection,when someone hovers at the door, immediately alerts push notifications to the mobile phone.



Day and night mode automatic switching, whether day or night, the image is clearly visible, for your safety and family security.

Q&A

Q:Why can't the Equipment be connected to WIFI?

- A:1. Please confirm that the WiFi connection is under the 2.4G protocol.
2. Confirm that the Red Indicator Light is blinking slowly.

3. Check whether the account name and password are correct, and whether there are excessive spaces

Q:The Equipment is online, and there is a trigger event, but the cell phone does receive any push messages

A:Check whether the app has "automatic starting" activated, and whether the "application authority" has the notification function activated

Disable "battery optimization" and "close the app when in the background and Always On Display" (depending upon the actual situations, considering different optimization modes for different cell phone manufacturers)

Q: What kinds of power supply modes are supported?

- A:1. The Equipment can use the battery independently to work.
2. AC (16-24V) may be used to charge the built-in battery.
3. USB is available to charge the Equipment.

Q: Does the Equipment support 3G?

A: 3G cell phones are not supported, only 4G is supported

NOTE
Please choose the correct 18650 battery

to use with the smart doorbell!

Flat head



Shart head



The batteries are not included!