

CREALITY

V1.0

Sprite Extruder Water Cooling Hotend User Manual

水冷散热套件使用说明书

深圳市创想三维科技股份有限公司
Shenzhen Creality Technology Co., Ltd

产品清单 Packing list

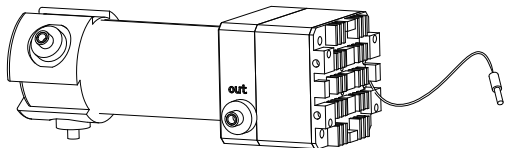

水冷泵
Water cooling pump



水冷散热块
Water cooling block

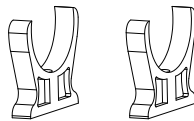

卡箍
Clamp



冷却管
Cooling tube

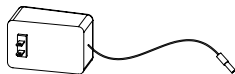

适配器
Power Adapter



M3x16螺栓
M3x16 bolts



M2x12螺栓 船型螺母
M2x12 bolts T nut

安装步骤 Installation

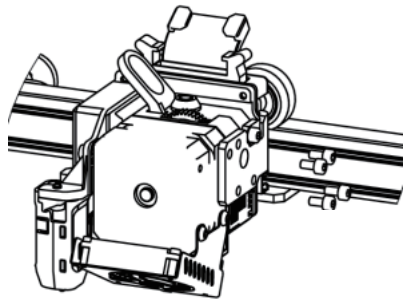

1. 拆卸原喷头上的4颗固定螺丝，拆下喷头套件。
1. Detach the Sprite Extruder by removing the 4 screws.

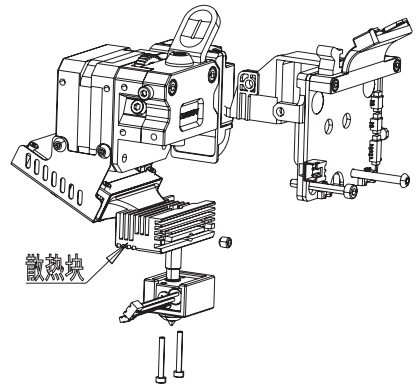

2. 拆卸原喷头套件的散热块，安装螺丝留下备用。(原鼓风机风扇拆除即可)。
2. Remove the fan cooling component(heatsink and fan) from Sprite Extruder and keep the mounting screws for the water cooling component.

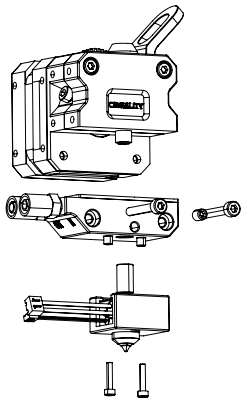

3. 如图所示，将水冷散热块安装在原散热块位置并用配件包中的M2×12螺栓连接加热块，然后将喷头套件固定在原安装支架上。

3. As shown in the figure, replace the fan cooling component with the water cooling component, then install the original heating block kit with M2×12 bolts. Remount the Sprite Extruder on the original mounting bracket.

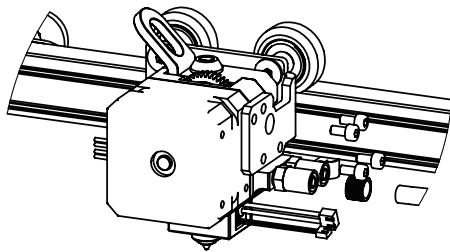

4. 将冷却水管裁成等长两段（长度可根据实际情况自行裁剪），分别将两支水管穿过固定螺母后套在散热块接口上并拧紧螺母固定。（请注意接口上的in和out标记）。

4. Cut the cooling tube into two equal lengths (the length of the cooling tube varies depending on the machine). Attach the 2 cooling tubes through the fixing nut and tighten the nut to fix it (Pay attention to the "IN" and "OUT" label).

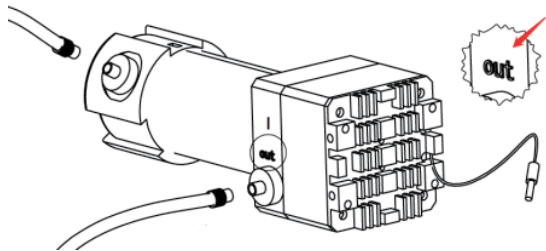

5. 用同样的方式将冷却水管另一端固定在水冷却泵接口上（请注意out标记，水泵上的out接口应与散热块上的in接口相连）。
5. Attach the other end of cooling tubes onto the water cooling pump interface in the same way (Pay attention that the "OUT" port on the water cooling pump should be connected to the "IN" port on the cooling block).

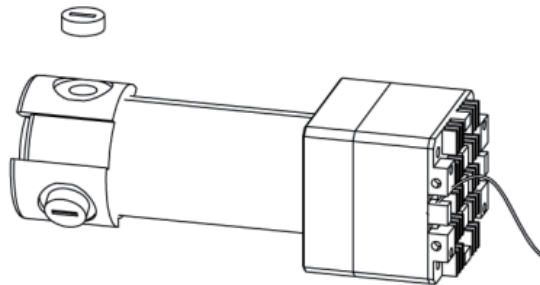

6. 用一字扳手拧开密封盖并加注满冷却液，加注完成后拧紧密封螺母；（请勿直接使用清水，以免损坏水泵，液面低于3/4时请及时补充）。
6. Use a flat head to unscrew the sealing cap and fill it with coolant, then tighten the sealing cap after filling. (DO NOT USE WATER as it will damage the pump. Replenish when the liquid level is lower than 3/4).

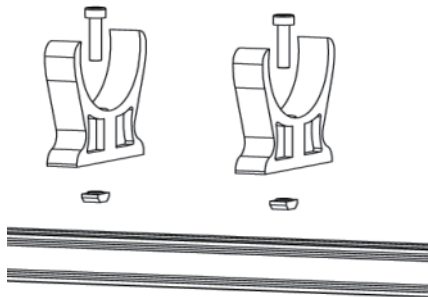

7. 用M3×16螺栓配合船型螺母将卡箍固定在打印机顶部横梁上。
7. Fix the clamp on the gantry on top of the printer with M3×16 bolts and T nuts.

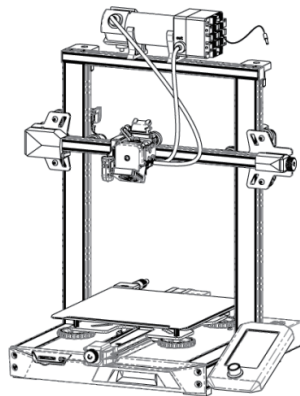

8. 将水冷泵组件自上而下按入卡箍内，调整位置后组装完成，如下图所示。
8. Mount the water cooling pump kit into the clamp. Adjust the position as shown in the following figure.

9. 连接适配器通电后即可开始打印。

9. Lastly, connect the water cooling kit to the power adapter to start printing.



深圳市创想三维科技股份有限公司
SHENZHEN CREALITY 3D TECHNOLOGY CO., LTD.

深圳市龙华区民治街道新牛社区梅龙大道锦绣鸿都大厦18F
18F, JinXiuHongDu Building, Meilong Blvd., Longhua Dist., Shenzhen, China 518131

公司网站 Official Website: www.cxsw3d.com www.creality.com
服务热线 Tel: 400 6133 882 0755-8523 4565

MADE
IN
CHINA