

**Specification**  
 Wingspan: 1600mm  
 Length: 850mm  
 Flying Weight≈450-650g

**Suggested Equipment**  
 Motor: MM2212 1100KV  
 ESC: 20A  
 Propeller: 8 inch folded propeller  
 Servos: 9g\*4  
 Battery: 3s 800-1300mAh  
 Radio≥4CH

**Accessories include**

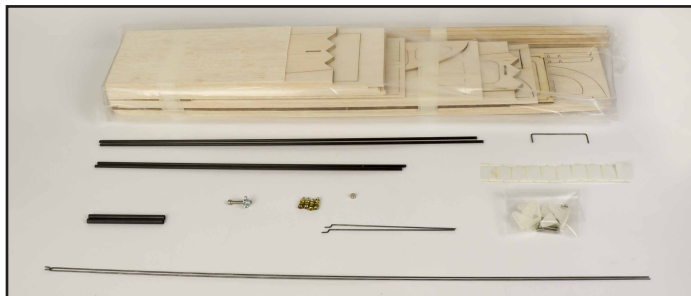

**Preparation Tool**



**1. Fuselage Assembly**

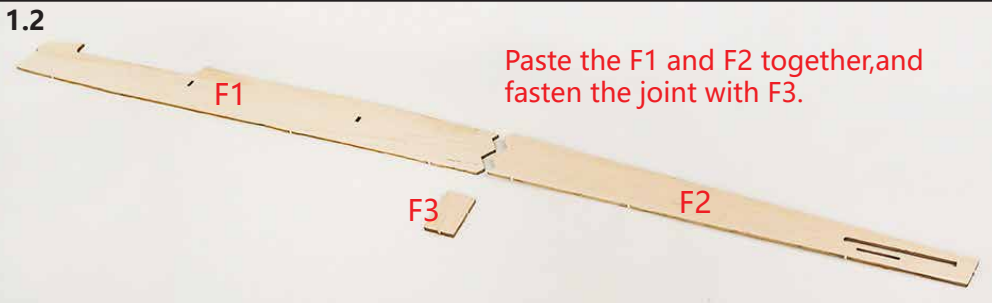

Take down and assemble the wood pieces of fuselage as per the following picture, connect the joints by 502 glue.

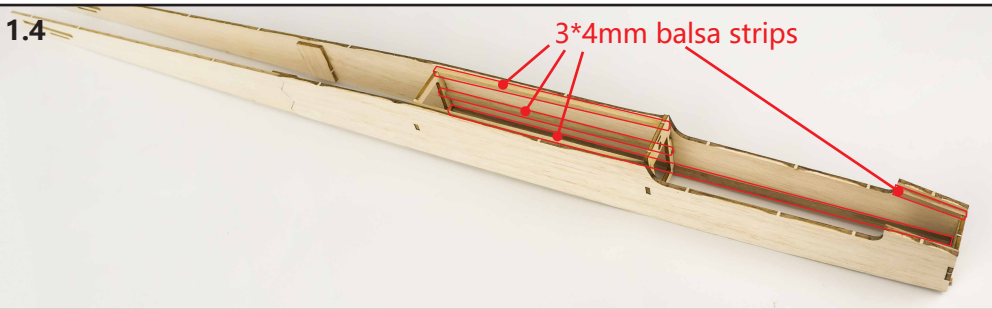
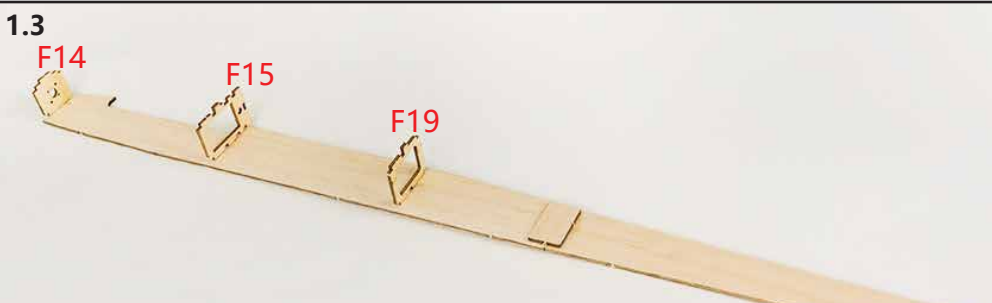

Cut the balsa strips with actual length, assemble them in place as picture shown left; Assemble in the same way the other side.





Paste the finished board (picture 1.5 above) at the bottom of the fuselage.



Assemble the cabin cover as picture shown left.

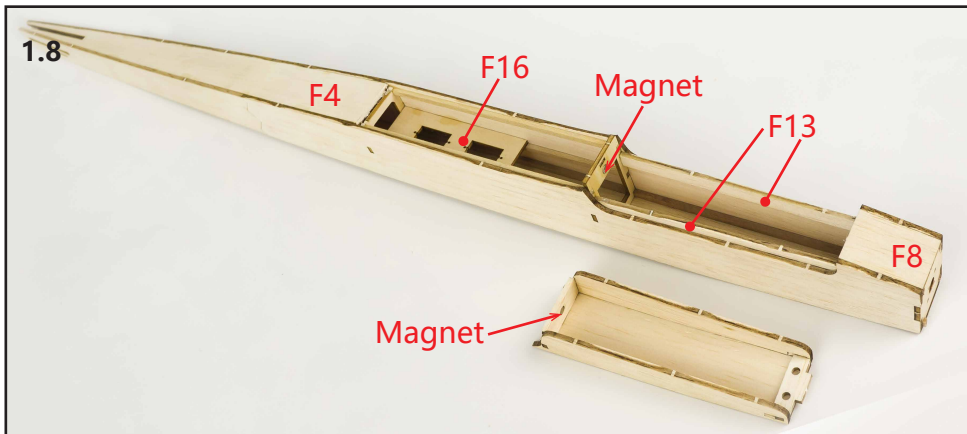

Paste the cover F4 and F8 as picture shown left, paste the servo mount base F16.

## 2. Assembly of Wing and Tail

Assemble the tail as per the 1:1 plan, and take care of the straightness of the tail.

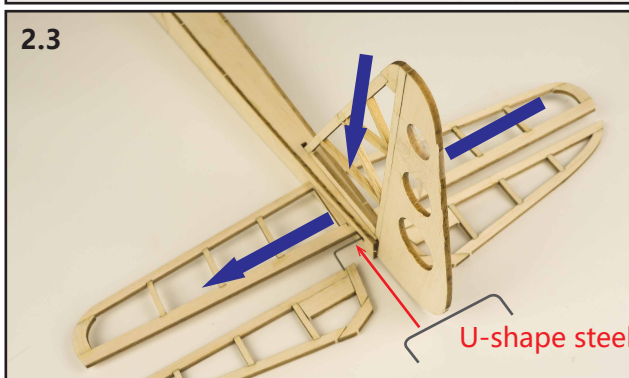
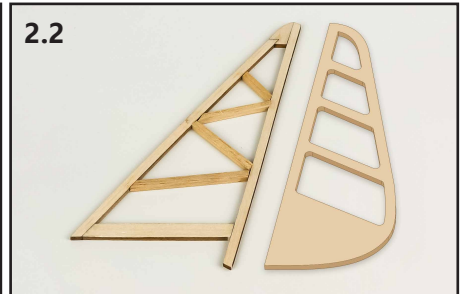

Assemble the vertical and horizontal tail at the tail of the fuselage, connect the two ailerons with U-shape steel wire.

U-shape steel wire

Assemble the wing as per the 1:1 plan, and take care of the straightness of the wing.

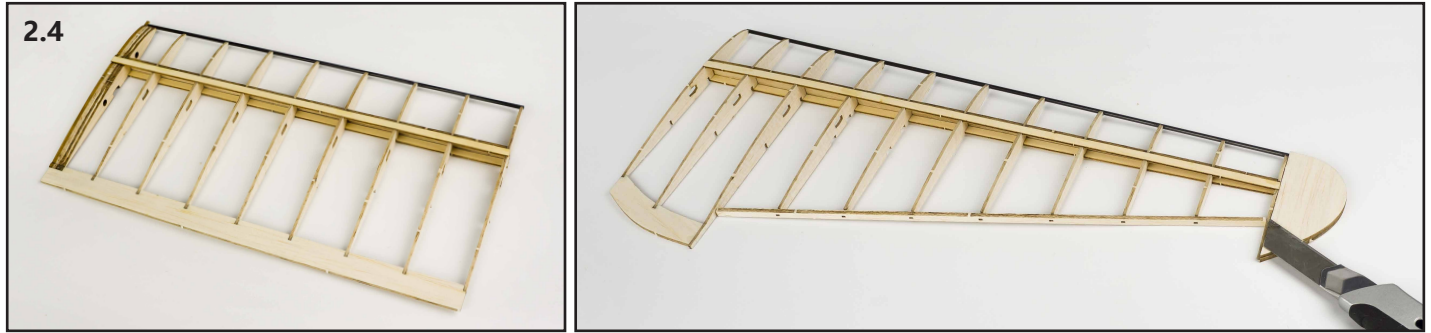

Paste the balsa cover onto the wing.



▲ Paste the W17 on the wing as picture shown, cut and polish by knife with curve.

Assemble the connection part W20, connect and glue the two parts of the wing together.

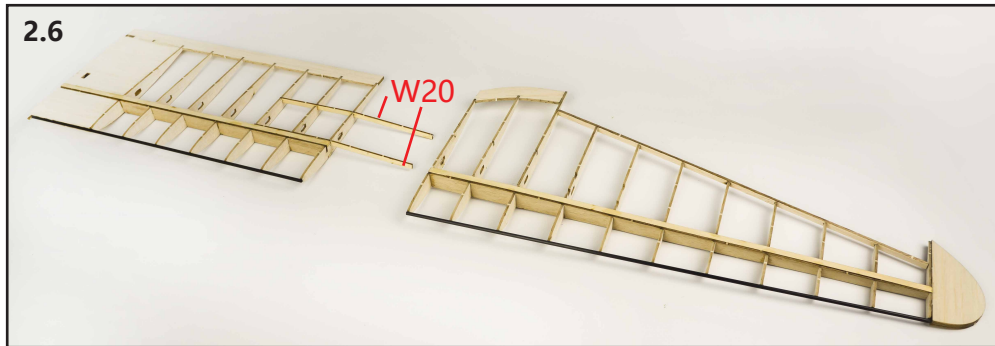

▼ Cut the balsa strips with actual length, assemble them in place as picture shown below; Assemble in same way the other wing.

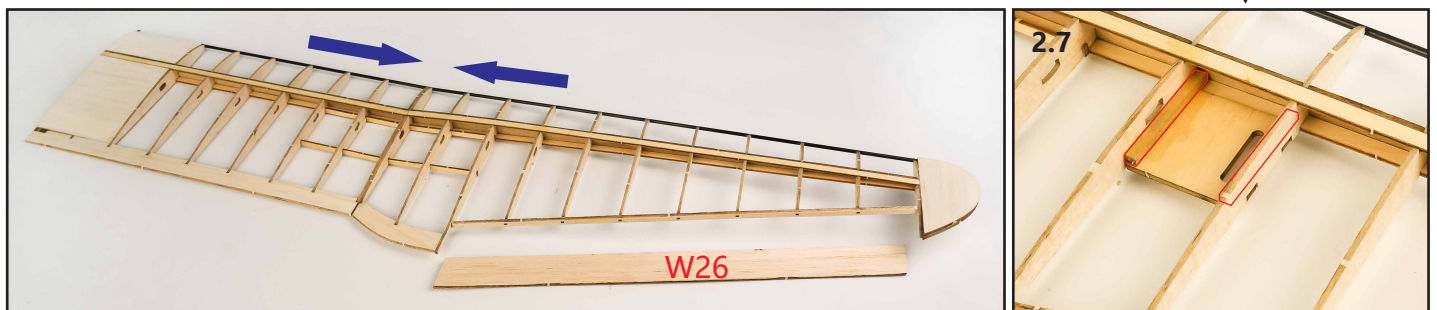

Assemble the left and right wing, connect both with the carbon tubes as picture shown below, glue at the joints.

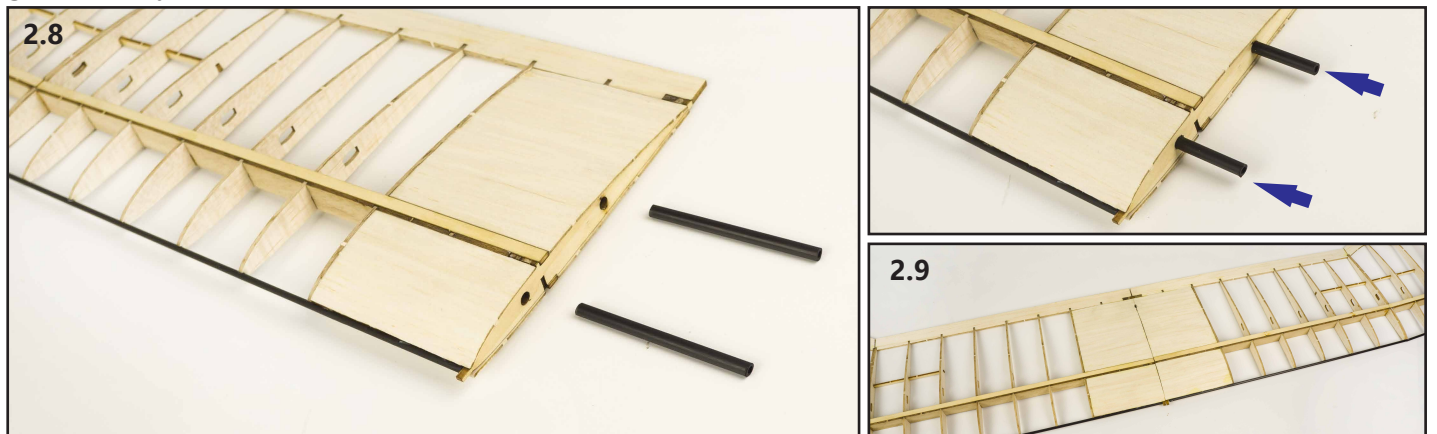



## 3. Assembly of Wing and Fuselage

Paste together the F17 and F18, assemble the nut onto the F18.

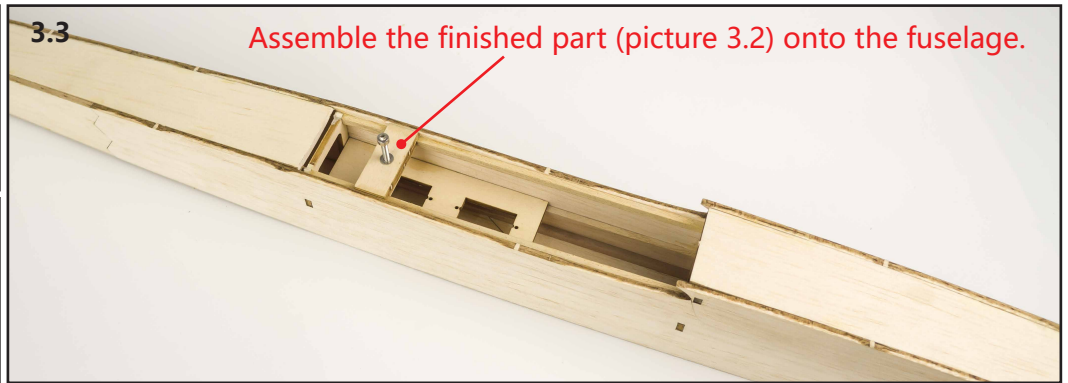

Assemble the wing onto the fuselage, drill a hole on the wing as per the F17 position, finally fasten the wing with screw.

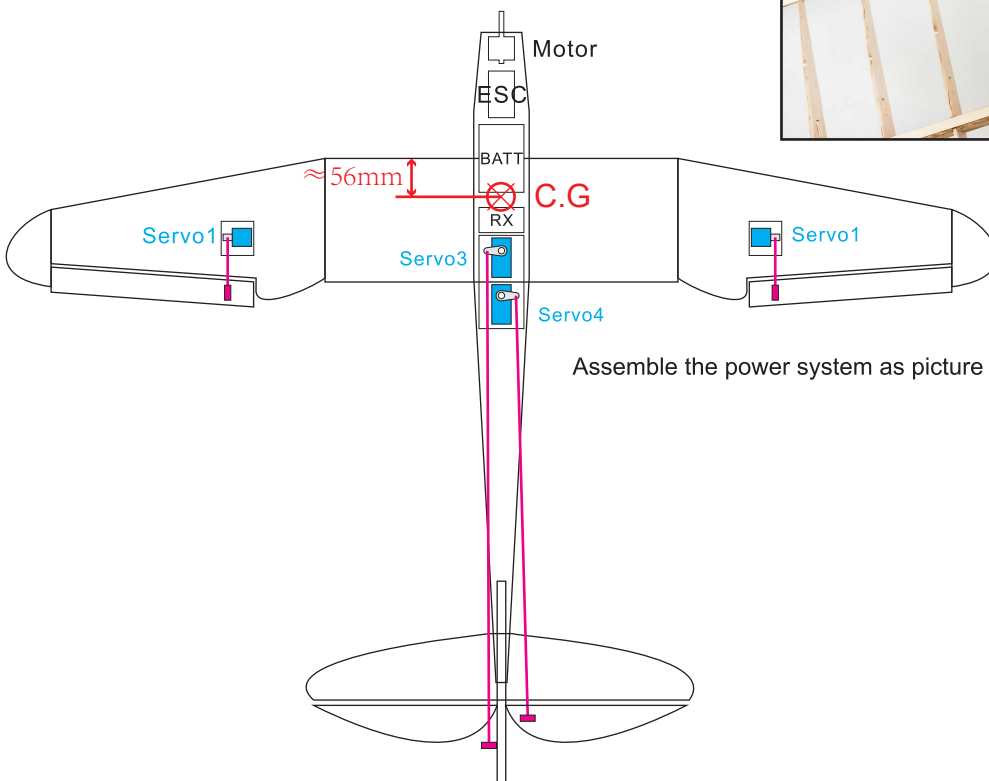

Assemble the power system as picture shows

## ADDITIONAL SAFETY PRECAUTIONS AND WARNINGS

**Age Recommendation: This is not a toy, not for children under 14 years old.**

1. Always keep a safe distance in all directions around your model to avoid collisions or injury. The model is controlled by a radio subject to interference from many sources outside your control. Interference can cause momentary loss of control.
2. Always operate your model in open spaces away from full-size vehicles, traffic and people.
3. Always carefully follow the directions and warnings for this and any optional support equipment (chargers, rechargeable battery packs, etc.).
4. Always keep all chemicals, small parts and anything electrical out of the reach of children.
5. Always avoid water exposure to all equipment not specifically designed and protected for this purpose. Moisture causes damage to electronics.
6. Never place any portion of the model in your mouth as it could cause serious injury or even death.
7. Never operate your model with low transmitter batteries.

