

LAOTIE

TI40 PRO
ELECTRIC SCOOTER

User Manual

CONTENTS

Our Story	001
Product Introduction	002
Main Part Introduction	003
Electric Scooter Packing List	003
Assembly Instructions	004
Folding Instructions	005
Charge Your Scooter	006
Remote Control Instructions	007
Display Manual	007
Specification	010
Safety Instructions	011
Maintenance	012
Contact Us	014

Dear Customer:
Thank you for choosing our company designed lithium battery e-scooter. In life with lithium battery e-scooter, you will feel the great function and excellent performance and high quality of our e-scooter which will bring you a pleasant trip.

OUR STORY

LAOTIE means building a strong and close relationship with customers in the East by using quality products as a bridge. The brand is centered on intelligent and environmentally friendly outings, providing professional electronic cycling products for people who pursue the limit and love outdoor sports.

LAOTIE provides customers with 100% power and fun, specializing in electric scooters, electric bikes & electric skateboards. Every product we sell is thoroughly tested internally and externally to meet the most stringent quality and safety standards.

OUR FACTORY

Our factory has more than 9,000 square meters, with an annual production capacity of 80,000 units. It has many R&D engineers with more than 10 years of experience, which specializes in OEM customization, ODM development, design, production and processing of various models. Our products have been obtained many certifications, such as European CE, RoHS, MSDS, UN38.3 and so on. Furthermore, our factory established three global overseas warehouses: EDA warehouse in Poland, Golden Eagle warehouse in Germany, and self-built warehouses in New York and strategically deployed overseas markets for independent sales.

Never Stop, Go Ahead!

Our future will move towards a more intelligent and modular era. LAOTIE will continue to provide better products for customers who love off-road or competition. Follow your heart and thank you for choosing LAOTIE.

PRODUCT INTRODUCTION

Product Overview



MAIN PART INTRODUCTION

- ① Front Light Button
- ② Turn Light Button
- ③ Horn Button
- ④ LCD Display
- ⑤ Accelerator
- ⑥ ECO/TURBO Switch Button
- ⑦ Single/ Dual Motor Switch Button



ELECTRIC SCOOTER PACKING LIST

E-scooter	1 PC
Charger	1 PC
Manual	1 PC
Remote Control	2 PCS
Lamp of Remote Control	1 PC
Screws & Wrench	1 SET

Please contact us with no hesitate there is any breakage or missing when you open package. We will replace it for you as soon as possible. Have a nice day!

ASSEMBLY INSTRUCTIONS

- ① Loosen the handlebar screws, secure the handlebars, and tighten the screws
- ② Handbar installation complete
- ③ Tighten the turn signal screw
- ④ Turn signal installation completed
- ⑤ Press the cover on the rear fender
- ⑥ Rear fender installed



FOLDING INSTRUCTIONS

- ① Loosen the 4 screws to dismantle the handle
- ② Pull the silver screw to the right to unlock the safety lock
- ③ Press the black button down to fold the scooter
- ④ Done



CHARGE YOUR SCOOTER



REMOTE CONTROL INSTRUCTIONS



Lock Your Scooter	Press the "Lock" button 1 time to lock the scooter. When hear a "beep" sound, the scooter will be on alert. Press the "unlock" button to remove the alert.
Unlock Your Scooter	Press the "Flash" button 2 times. When hear "beep" sounds 2 times, the Scooter will be unlocked.

DISPLAY MANUAL



ON/OFF:

Long press "Power" Button for 3 seconds to start or shut down the scooter.
Auto OFF: After five minutes of non-using any function, the scooter will be automatically power off.

Display content switch:

In power on condition, short press "Power" Button to switch TRIP/ODO/VOL on the LCD display.
Note: TRIP is Single mileage, ODO is cumulative mileage, VOL is battery voltage.
Speed Mode Switch: In power on condition, short press "Mode" Button to switch speed mode.

Parameters Settings:

Enter/Exit Settings Interface : Long press the "Mode" & "Power" Button together for 3 second.
P01-P20 Switch: Short press "Mode" button to switch code number.
Value Adjustment: Short press "Mode" or "Power" Button to adjust.

Code Number	Meaning	Detail
P01	Backlight brightness	1: Darkest 3: Brightest
P02	Mileage unit	0: KM 1: MILE
P03	Voltage level	Default: 72V
P04	Sleep time	0: no sleep Other numbers are sleep time, Range: 1-60 (minute)
P05	Invalid	/

P06	Wheel diameter	Default: 13
P07	Number of speed measuring magnets	Range: 0-255 (Default: 27)
P08	Speed limit	Range 0-100km/h (Default: 25); 100: Cancel the speed limit.
P09	Zero start, non-zero start setting	0: zero start; 1: non-zero start
P10	Invalid	/
P11	EABS switch choose	The range is 0-4 (Default: 0); 0: weakest, 4: hardest
P12	Soft and hard start strength	The range is 1-5 (Default: 3); 1: Softest, 5: Hardest
P13	Invalid	/
P14	Invalid	/
P15	Controller under voltage value	Default: 63V
P16	ODO reset setting	Press and hold the plus button for 5 seconds to reset ODO
P17	Automatic cruise optional	0: disable cruise 1: enable cruise
P18	Invalid	/
P19	Invalid	/
P20	Invalid	/

SPECIFICATION

Items	Specifications
Brand	LAOTIE
Model	TI40 Pro
Motor	Dual 4000W (peak power) Motors
Battery	72V43.2Ah Lithium Battery
Tire	13 Inches
Controller	50A Controller * 2
Brake	Front and Rear ZOOM Oil Brake & EABS
Max Speed	110 km/h
Max Range	Dual Motor 70-80 km Single Motor 150 km
Climbing Angle	50°
Max Load	200KG
Gross Weight	69.6KG
Body Size	145x30x132cm
Folding Size	153x30x53cm
Package Size	156x36x59cm

SAFETY INSTRUCTIONS

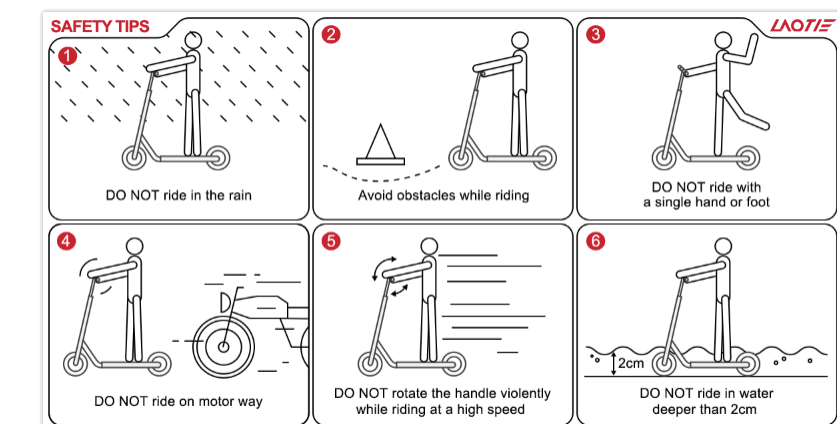

This manual has been created to help you understand the safe use and maintenance of LAOTIE TI40 Pro electric scooter.

- Please make sure the screw of the wheel tightened well and the braking system works well before driving the scooter.
- Persons without excellent vision, balance, coordination, reflex, muscle and bone strength and good decision-making capabilities should not use this product.
- The user of this product assumes ALL risks associated with its use. To minimize these RISKS, the user must wear a safety helmet, goggles, gloves, elbow and knee pads and appropriate footwear.
- This manual contains important safety information. It is your responsibility to review this information and make sure that all riders understand all warnings, cautions, instructions and safety. We're not liable for incidental damages or consequential damages due directly or indirectly to the use of this product.
- Riding the electric scooter can be a hazardous activity. Certain conditions may cause the equipment to fail without fault of the manufacturer. Like other electric products, the scooter can and is intended to move and it is therefore possible to lose control, fall off and/or get into dangerous situations that no amount of care, instruction or expertise can eliminate. If such things occur you can be seriously injured or die, even when using safety equipment and other precautions. RIDE AT YOUR OWN RISK AND USE COMMON SENSE.

ALWAYS FOLLOW THE LOCAL LAWS AND REGULATIONS.

- Understand your local laws permitting the use of Electric scooters. Never ride about safety issues.
- your scooter in conditions of poor visibility.
- Do not do stunts, wheelies or jumps. They will increase your chances of injury and damage your LAOTIE Es40 Pro.
- Never carry passengers

MAINTENANCE

Cleaning and storage

- If you see stains on the scooter's body, wipe them off with a damp cloth.
- If the stains won't scrub off, put on some toothpaste, and brush them with a toothbrush, then wipe them off with a damp cloth.
- If you see scratches on plastic parts, use sandpaper or other abrasive materials to polish them.
- Notes: do not clean the scooter with alcohol, gasoline, kerosene or other corrosive and volatile chemical solvents to prevent dire damage. Do not wash the scooter with a high-pressure water spray.
- During cleaning, make sure that the scooter's turned off, the charging cable is unplugged, and the rubber flap is closed as water leakage may result in electric shock or other major problems.
- When the scooter's not in use, keep it indoors where it is dry and cool. Do not put it outdoors for long time. Excessive sunlight, overheating and over cooling accelerate tire aging and compromise the scooter and the battery pack's lifespan.

Battery maintenance

- Use original battery packs, use of other models or brands may bring about safety issues.
- Do not touch the contacts. Do not dismantle or puncture the casing. Keep the contacts away from metal objects to prevent short circuit which may result in battery damage or even injuries and deaths.
- Use original power adapter to avoid potential damage or fire.
- Mishandling of used batteries may do tremendous harm to the environment. To protect natural environment, please follow local regulations to properly dispose used batteries.
- After every use, fully charge the battery to prolong its lifespan.
- Recommended charging time
Charging with 1 charger: 12~13 hours
Charging with 2 chargers: 6~7 hours

- Do not place the battery in an environment where the ambient temperature is higher than 50°C or lower than -20°C (e.g., do not leave the scooter or the battery pack in a car under direct sunlight for an extended time). Do not throw the battery pack into fire as it may lead to battery failure, battery overheating, and even another fire.
- If the scooter is expected to be left idle for more than 30 days, please fully charge the battery and place it in a dry and cool place. Keep in mind to recharge it every 60 days to protect the battery from potential damage which is beyond limited warranty.

- Always charge before exhausting the battery to prolong the battery's lifespan. The battery pack performs better at normal temperature, and poor when it is below 0°C. For instance, when it is below -20°C, the riding range is only half or less at normal state. When the temperature rises, the riding range restores.

CONTACT US

Technical support Team: support@laotie.zone

If you have any inquiries please feel free to contact us, we will reply within 24 hours.

TI40 PRO说明书

尺寸: 140*210mm

200g铜版纸-哑膜-骑马钉