

## T69 Car MP3 Player



### User Manual

#### Important Instructions:

1. SAVE THIS INSTRUCTION- This manual contains important safety and operating instructions for the product.
2. Before using the product, read all instructions and cautionary markings on Vehicle Battery Adapters.
3. For the best audio quality, please turn the volume of your phone and FM transmitter into the max level, and then adjust the car volume.
4. If the noise is too loud, please try another blank FM station.
5. The signal of any FM transmitter sometimes can be interfered by the surrounded radio or the similar frequency signal thus cause noise, this is normal.
6. To prevent your car battery from being drained, please unplug the product after you turn off the car.
7. Do not expose the product to rain, moisture, or snow.
8. Do not disassemble the product, incorrect reassembly may result in a risk of electric shock or fire.
9. To reduce risk of electric shock, unplug the product before attempting any maintenance. Turning off controls will not reduce this risk.

#### Features:

1. 9 light color modes: Rainbow, Breathing rainbow, Red, Green, Blue, Yellow, Purple, Cyan, White, light switch design of the outer circle creates new atmosphere to the car interior space.
2. Activate phone voice control like Siri, Bixby, Google Assistant, etc.
3. 2 of 20W PD ports for fast charge, output 5V 3A/9V 2.22A/12V 1.67A max.
4. Transmit the music/navigation of your Bluetooth enabled phone to car stereo via FM signal.
5. Bluetooth V5.0, auto connect last device.
6. Display car voltage while plug in.
7. Free your hands, answer hands-free phone calls during driving.

-01-

#### Diagram:

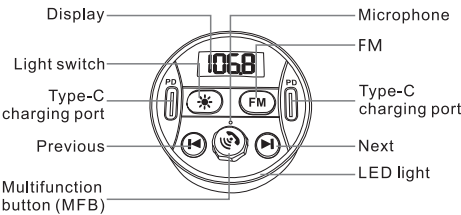

#### Operations:

Function	Operation
Power On/Off	Plug/Unplug the product into/out from your car charger port
Frequency Up/Down	Press the "FM" button, then rotate the "MFB" or press the "Next"/"Previous" button to add/reduce frequency
Play/Pause/Answer/Hang up	Press the "MFB" once
Switch call audio source	Press the "Next" or "Previous" button to switch call audio from phone or Bluetooth
Reject a call	Long press the "MFB"
Redial the last number	Press the "MFB" twice
Volume Up/Down	Rotate the "MFB"
Next/Previous Song	Press the "Next"/"Previous" button once
Switch light mode	Press the "Light switch" button
Activate phone voice control	After paired with phone, long press the "MFB" button

-02-

#### Transmit music to car stereo:

- (1). Plug the transmitter into your car charger port, the display flashes means it is in pairing mode.

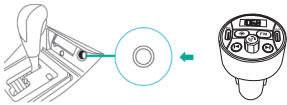

- (2). Turn on the Bluetooth function of your phone, search for Bluetooth devices and connect "T69".

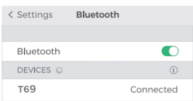

If pairing is successful, the display will stop flash and show FM frequency.

**Auto-connect:** The product will auto-connect the last connected phone when turned on next time. (Please turn on the Bluetooth function of your phone before turn on the product.)

-03-

- (3). Choose car audio output as FM radio, adjust it to a blank frequency from 87.5MHz to 108.0MHz, for example: 88.1.

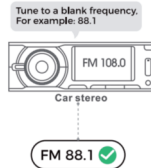

- (4). Adjust the product into the same frequency with the car FM radio.

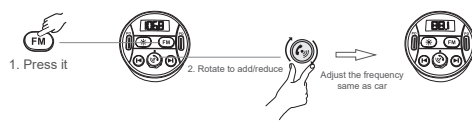

- (5). Open the music player/navigation of your phone, now it can transmit the phone calls, music or navigation to car stereo system.  
**Note:** Turn the phone volume and transmitter volume into max level first, then tune your car volume to appropriate level, to get the best sound quality.



-04-

#### Tips:

1. For the best audio quality, please turn the volume of your phone and product into the max level, and then tune your car volume to appropriate level.
2. The signal of any FM transmitter sometimes may be interfered by the surrounded radio or the similar frequency signal thus cause noise, this is normal.
3. If the noise is too loud, please try another blank FM station.
4. To prevent your car battery from being drained, please unplug the product after you turn off the car.

#### Charging:

Plug your charging cable in to the PD port, it will detect your device then output the max voltage and current that matches.

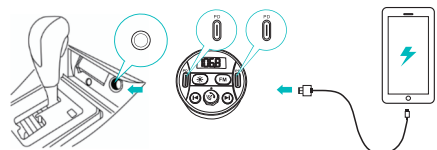

PD output 5V 3A/9V 2.22A/12V 1.67A max.

-05-

#### FCC STATEMENT:

NOTE: This equipment has been tested and found to comply with the limits for a Class B digital device, pursuant to Part 15 of the FCC Rules. These limits are designed to provide reasonable protection against harmful interference in a residential installation. This equipment generates uses and can radiate radio frequency energy and, if not installed and used in accordance with the instructions, may cause harmful interference to radio communications. However, there is no guarantee that interference will not occur in a particular installation. If this equipment does cause harmful interference to radio or television reception, which can be determined by turning the equipment off and on, the user is encouraged to try to correct the interference by one or more of the following measures:

- Reorient or relocate the receiving antenna.
- Increase the separation between the equipment and receiver.
- Connect the equipment into an outlet on a circuit different from that to which the receiver is connected.
- Consult the dealer or an experienced radio/TV technician for help

Changes or modifications not expressly approved by the party responsible for compliance could void the user's authority to operate the equipment.

This device complies with part 15 of the FCC rules. Operation is subject to the following two conditions:  
(1) this device may not cause harmful interference, and (2) this device must accept any interference received, including interference that may cause undesired operation.

-06-

#### RF Exposure Warning Statements:

This equipment complies with FCC radiation exposure limits set forth for an uncontrolled environment. This equipment shall be installed and operated with minimum distance 20cm between the radiator & body.

#### CORRECT DISPOSAL OF THIS PRODUCT:



(Waste Electrical & Electronic Equipment)  
This making shown on the product or its literature, indicates that it should not be disposed with other household wastes at the end of its working life.

To prevent possible harm to the environment or human health from uncontrolled waste disposal, please separate this from other types of wastes and recycle it responsibly to promote the sustainable reuse of material resources.  
Household user should contact either the retailer where they purchased this product or their local government office for details of where and how they can take this item for environmentally safe recycling. Business users should contact their supplier and check the terms and conditions of the purchase contract. This product should not be mixed with other commercial wastes for disposal.

-07-

## T69 车载MP3播放器



### 用户手册

#### 重要说明

- 1.保存本说明书-本手册包含产品的重要安全和操作说明。
- 2.使用本产品前，请阅读车辆蓄电池适配器上的所有说明和警示标记。
- 3.为了获得最佳音质，请将手机和调频发射器的音量调到最大音量，然后调整汽车音量。
- 4.如果噪音太大，请尝试另一个空白调频电台。
- 5.任何调频发射机的信号有时会受到周围无线电或类似频率信号的干扰而产生噪声，这是正常的。
- 6.为防止汽车电池耗尽，请在熄火后拔掉电源插头。
- 7.不要将产品暴露在雨水、湿气或雪中。
- 8.不要拆卸产品，不正确的重新组装可能导致触电或火灾的危险。为了减少触电的风险，在进行任何维护之前，请拔下产品的插头。关闭控制不会降低这种风险。

#### 特征:

1. 9种灯光颜色模式：彩灯、动态彩灯、红、绿、蓝、黄、紫、青、白，外圈的灯光开关设计为车内空间营造出新氛围。
2. 启动手机语音控制，如Siri、Bixby、Google Assistant等。
3. 2个20W PD端口，用于快速充电，最大输出5V 3A/9V 2.22A/12V 1.67A。
4. 通过调频信号将蓝牙手机的音乐/导航功能传送至车载立体声系统。
5. 蓝牙V5.0，自动连接最后一个设备。
6. 插入时显示车辆电压。
7. 驾驶过程中，可接听免电话。

-01-

#### 示意图:

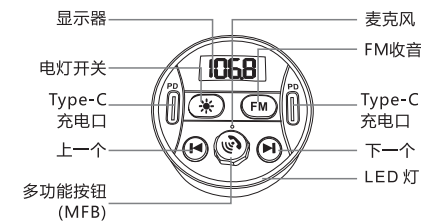

#### 操作:

功能	操作
开机/关机	将产品插入/拔出您的汽车充电器端口
频率上升/下降	按 "FM" 按钮，然后旋转 "MFB"，或按上一个/下一个按钮，以增加/减少频率
播放/暂停/接听/挂断	按下 "MFB" 一次
切换呼叫音频源	按 "下一步" 或 "上一步" 按钮，切换电话或蓝牙呼叫音频
拒绝来电	长按 "MFB"
重接最后一个号码	按两次 "MFB"
音量增大/减小	旋转 "MFB"
下一首/上一首歌	按下 "下一步" / "上一步" 按钮一次
开关灯模式	按下 "灯开关" 按钮
启动电话语音控制	手机配对后，长按 "MFB" 按钮

-02-

#### 将音乐传送到汽车音响

- (1). 将发射器插入汽车充电器端口，显示屏将首先显示汽车电压，然后闪烁表示处于配对模式。

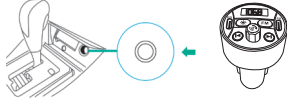

- (2). 打开手机的蓝牙功能，搜索蓝牙设备并连接 "T69"。



如果配对成功，显示屏将停止闪烁并显示FM频率。

**自动连接：**下次开机时，产品将自动连接上一个连接的手机 (请在打开产品之前打开手机的蓝牙功能。)

-03-

- (3). 选择汽车音频输出为调频收音机，将其调整为 87.5MHz至108.0MHz的空白频率，例如：88.1。



- (4). 将产品调到与车载调频收音机相同的频率。



- (5). 打开手机的音乐播放器/导航，即可将电话、音乐或导航传送至车载立体声系统。

**注意：**先将手机音量和发射器音量调到最大音量，然后将汽车音量调到合适的音量，以获得最佳音质。



-04-

#### 提示：

- 1.为了获得最佳音质，请将手机和产品的音量调到最大音量，然后将汽车音量调到适当的水平。
- 2.任何调频发射机的信号有时可能会受到周围无线电或类似频率信号的干扰而产生噪声，这是正常的。
- 3.如果噪音太大，请尝试另一个空白调频电台。
- 4.为防止汽车电池耗尽，请在熄火后拔掉电源插头。

#### 充电：

将充电电缆插入PD端口，它将检测到您的设备，然后输出匹配的最大电压和电流。

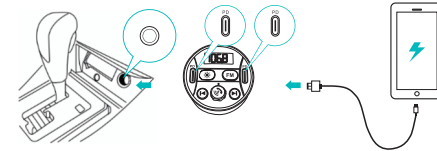

PD输出5V 3A/9V 2.22A/12V 1.67A最大值。

-05-

#### FCC声明：

注：根据FCC规则第15部分的规定，本设备已经过测试，符合B类数字设备的限制。这些限制旨在提供合理的保护，防止住宅安装中的有害干扰。本设备可产生、使用和辐射射频能量，如果不按照说明书安装和使用，可能对无线电通信造成有害干扰。但是，不能保证在特定安装中不会发生干扰。如果本设备确实对无线电或电视接收造成有害干扰（可通过关闭和打开设备来确定），则鼓励用户尝试通过以下一种或多种措施来纠正干扰：

- 重新定向或重新定位接收天线。
- 增加设备和接收器之间的间隔。
- 将设备连接到不同于接收器所连接电路的插座上。
- 请咨询经销商或有经验的无线电/电视技术人员以获取帮助未经负责合规性的一方明确批准的变更或修改可能会使用户失去操作设备的权限。

此设备符合FCC规则第15部分。

操作须符合以下两个条件：

- (1) 此设备可能不会造成有害干扰，并且
- (2) 此设备必须接受接收到的任何干扰，包括可能导致不必要的操作的干扰。

#### 射频暴露警告声明：

本设备符合FCC针对非受控环境规定的辐射暴露限值。安装和操作该设备时，散热器和主体之间的最小距离应为20cm。

-06-

#### 正确处理本产品



(废弃电气电子设备)

产品或其文献上显示的这种制造方式表明，在其使用寿命结束时，不应将其与其他生活垃圾一起处理。为防止不受控制的废物处置可能对环境或人类健康造成危害，请将其与其他类型的废物分开，并负责任地加以回收，以促进物质资源的可持续再利用。

家庭用户应联系他们购买该产品的零售商或当地政府办公室，了解他们在何处以及如何使用该产品进行环保回收的详细信息。业务用户应联系其供应商并检查采购合同的条款和条件。本产品不得与其他商业废弃物混合处置。

-07-