

# T20 Sport Scale Cessna 152 Instruction Manual



**参数**  
 翼展: 1200mm  
 机长: 870mm  
 起飞重量: ≈1000-1200kg

**推荐配置**  
 推荐马达: 2216-2814 900-1100KV  
 推荐电调: 20A-40A  
 推荐电池: 3S 2200-2800mAh  
 推荐舵机: 9g\*4pcs / 6pcs  
 推荐桨叶: 9-11寸  
 通道≥4CH

**Specification**  
 Wingspan: 1200mm  
 Length: 870mm  
 Flying Weight: ≈1000-1200g

**Suggested Equipment**  
 Electric power: 2216-2814 900-1100KV  
 ESC: 20A-40A  
 Battery: 3S 2200-2800mAh  
 Servo: 9g\*4pcs / 6pcs  
 Propeller: 9-11inch  
 Radio ≥4CH

## 工具 Tools Needed

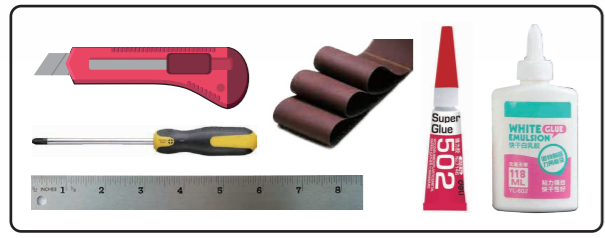

## 机身组装 Fuselage Installation

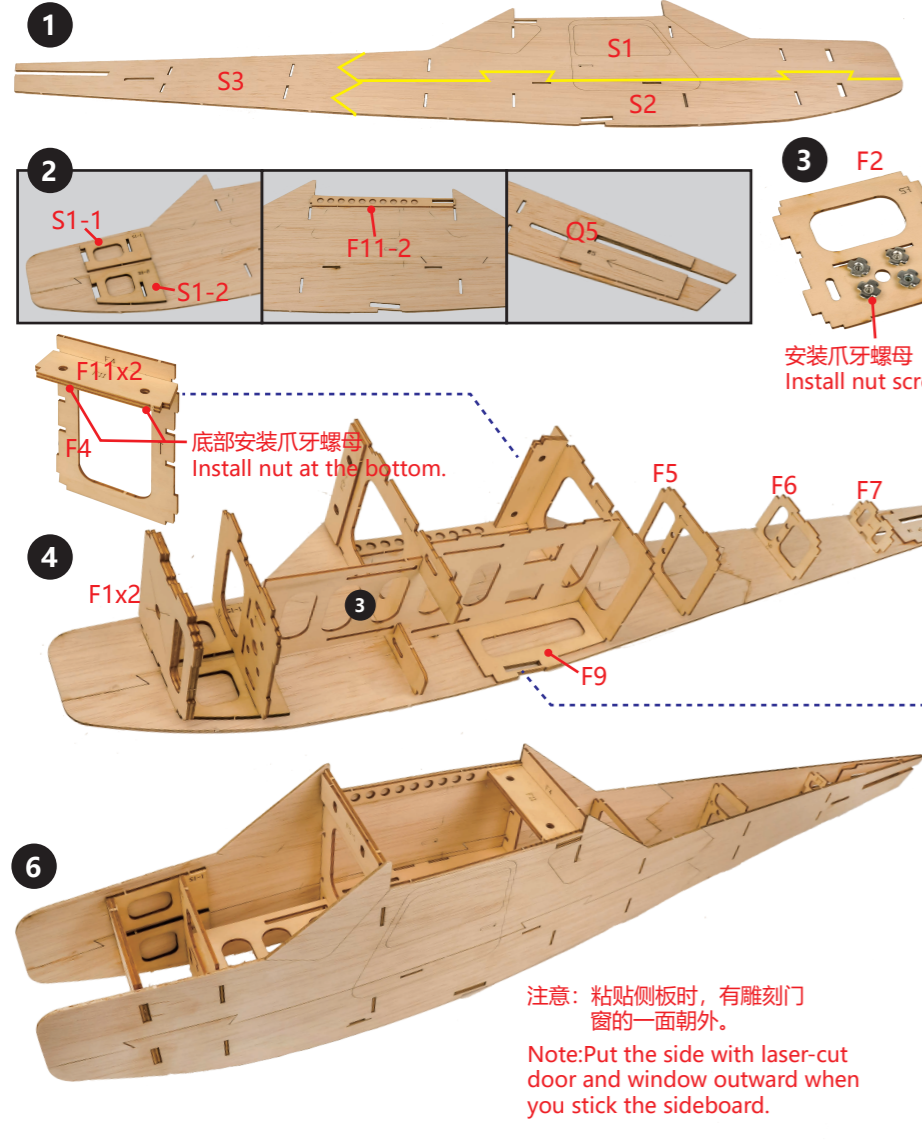

注意: 粘贴侧板时, 有雕刻门窗的一面朝外。  
 Note: Put the side with laser-cut door and window outward when you stick the sideboard.

找出S1-S3轻木条, 把他们如图粘贴在一起, 待粘合牢固后, 再进行下一步骤。

Find out S1-S3 balsawood board, stick them together as shown. Proceed next step after glueing them firmly.

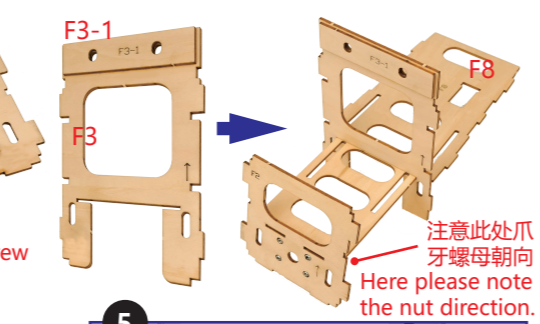

安装爪牙螺母  
Install nut screw

注意此处爪牙螺母朝向  
Here please note the nut direction.

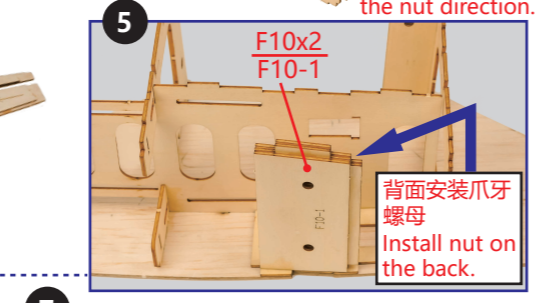

背面安装爪牙螺母  
Install nut on the back.

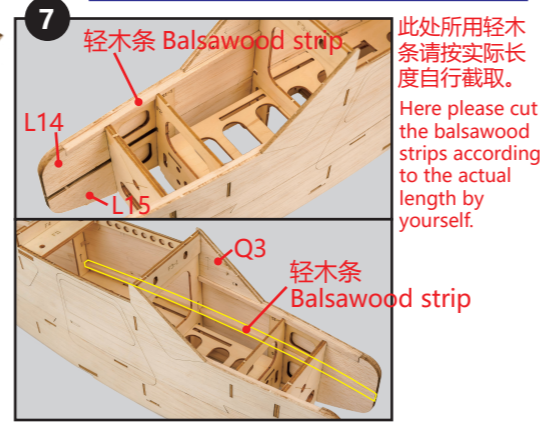

此处所用轻木条请按实际长度自行截取。  
Here please cut the balsawood strips according to the actual length by yourself.

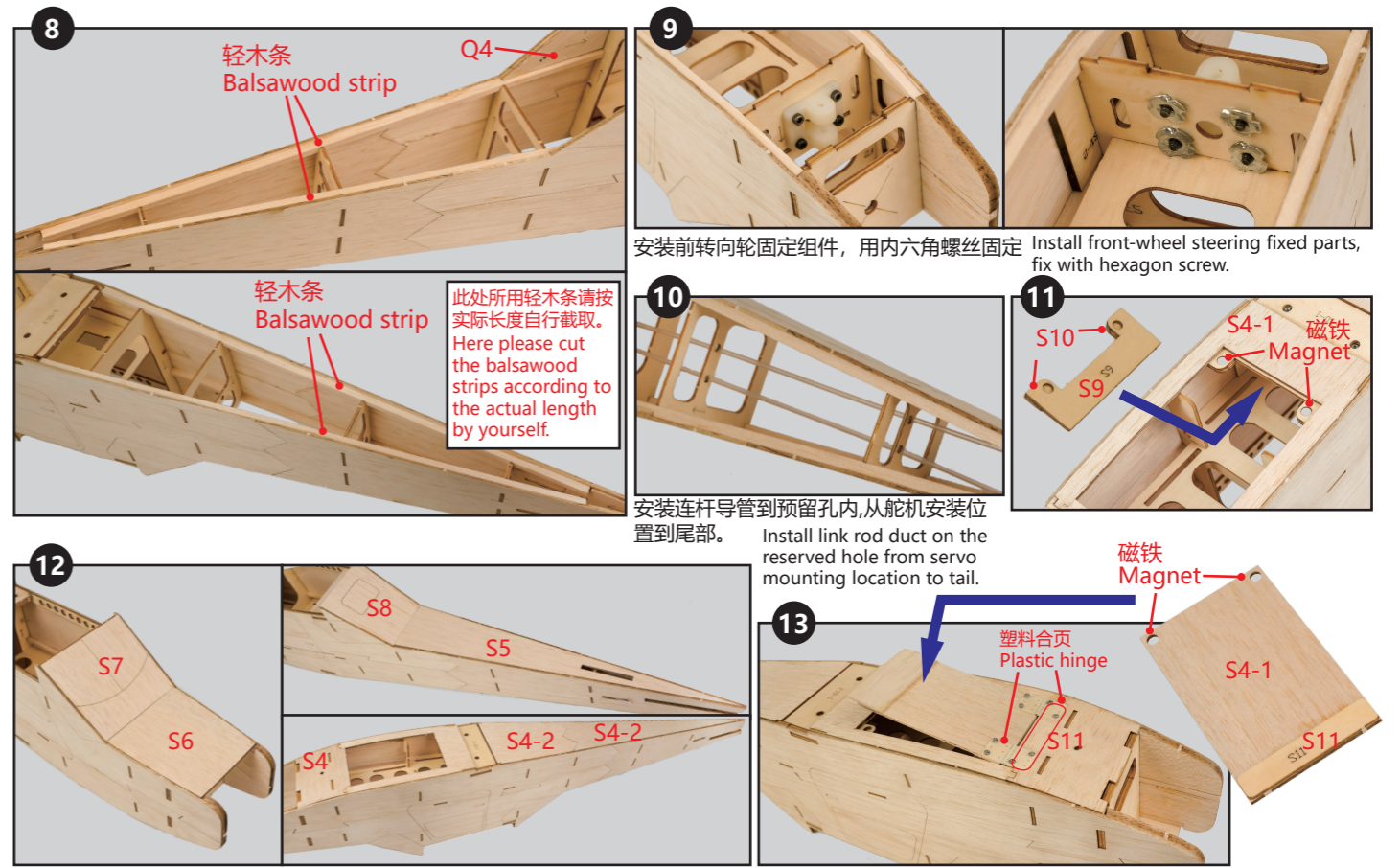

## 机翼组装 Wing Installation

机翼及尾翼请对比1:1图纸上的编号拼装, 将图纸平铺到水平工作台上进行拼装, 拼装时保持机翼平直。

Build the wing and tail wing according to 1:1 drawing plan. Put the drawing plan on horizontal workbench for building and keep the wing straightness.



拼装时注意以下细节图片  
Pay attention to below details pictures during building.



垫入第二片L7时, 需稍加打磨成斜面  
Please polish L7 to bevel when you assemble the second L7.

**细节 Detail 3**

**细节 Detail 4**

在机翼前缘粘贴L1-1, 并打磨成机翼一体的弧度。  
Stick L1-1 at the leading edge of wing, and sand it to the same radius of wing.

**细节 Detail 5**

粘贴后打磨成弧形  
Sand to arc after sticking.

**细节 Detail 6**

副翼, 襟翼拼装时在下图位置垫入轻木片, 方便安装舵角。  
Add balsawood sheet in below position when you install aileron and flap, convenient for installing control horn.

襟翼 Flap

副翼 Aileron

L8-4

L9-4

**15**

L2-1x2

完成后的两部分机翼, 通过L2-1对插在一起, 连接处大量胶水粘合。  
Plug the two finished wings into each other by L2-1, stick the joint with a lot of glue.

**起落架及各部件组装 Landing gear and other parts installation**

**16**

内六角螺丝固定  
Fasten socket head cap screw

起落架安装, 在上图所示位置安装起落架。  
Landing gear and other parts installation.

**17**

轮档固定  
Fix wheel chock

前转向轮安装, 在上图所示位置安装前转向轮。  
Front-wheel steering installation as shown.

**18**

内六角螺丝固定  
Fasten socket head cap screw

F13x2

前转向轮穿入步骤9安装的组件中, 用顶丝锁定。  
Insert front-wheel steering into the part which installed on step 9, fix with top screw.

**马达及舵机安装图示  
Motor and servo installation show**

在下图位置, 按实际长度截取轻木条粘到舵机安装位置。  
In below position, please cut the balsawood strips according to the actual length, stick it on the servo installation position.

**19**

自攻螺丝  
Self-tapping screw

自攻螺丝  
Self-tapping screw

机翼支架  
Wing bracket

**20**

**21**

自攻螺丝  
Self-tapping screw

自攻螺丝  
Self-tapping screw

D1

D1

如图安装襟翼、副翼舵机, 在襟翼和副翼安装舵角, 用Z型钢丝连杆连接舵臂和舵角, 通过快装接头锁定。  
Install servos and control horns of flap and aileron as shown, Connect rudder arm and control horn with Z-shape steel wire link rod, lock with quick mounting connectors.

**22**

安装马达时, 根据所选用的马达的大小适当的垫入M1, 使马达可以正常运转。  
Insert M1 according to the motor size you use during installing motor.

**23**

如图安装舵机, 舵角。  
Install servo and control horn as shown.

Z型钢丝连杆穿入步骤10中预装的套管中, 并连接舵臂, 舵角, 用快装接头固定。  
Insert Z-shape steel wire link rod into the drivepipe which preassembled in step 10, and connect rudder arm and control horn, fix with quick mounting connector.

**重心位置展示图示 CG position show**

**24**

54mm

C.G

调整电子设备及重心即可进行试飞。  
Adjust the electric equipment and C.G, then test the flight.

**ADDITIONAL SAFETY PRECAUTIONS AND WARNINGS**

**Age Recommendation: This is not a toy, not for children under 14 years old.**

1. Always keep a safe distance in all directions around your model to avoid collisions or injury. The model is controlled by a radio subject to interference from many sources outside your control. Interference can cause momentary loss of control.
2. Always operate your model in open spaces away from full-size vehicles, traffic and people.
3. Always carefully follow the directions and warnings for this and any optional support equipment (chargers, rechargeable battery packs, etc.).
4. Always keep all chemicals, small parts and anything electrical out of the reach of children.
5. Always avoid water exposure to all equipment not specifically designed and protected for this purpose. Moisture causes damage to electronics.
6. Never place any portion of the model in your mouth as it could cause serious injury or even death.
7. Never operate your model with low transmitter batteries.

