

ANGWATT

— **ANGWATT C1** —
ELECTRIC SCOOTER

User Manual

CONTENTS

Safe Riding Guidelines	01
Packing List	02
Installation Guide	03
Product Introduction	04
Main Parts Introduction	06
Storage And Maintenance	08
Warranty Instructions	09
FAQ	11

Dear Customer:

Thank you for choosing ANGWATT electric scooter. We are committed to creating the best quality electric scooter products. Hope ANGWATT C1 will bring you the best journey. May you have a good time.

SAFE RIDING GUIDELINES

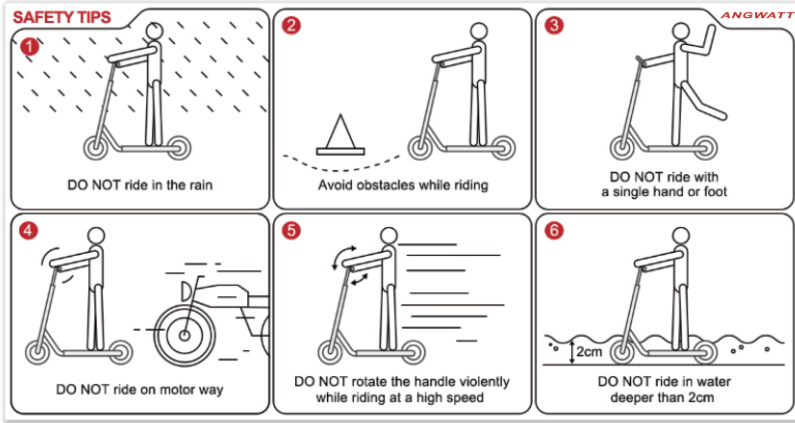

This chapter has been created to help you understand the safe use and maintenance of ANGWATT C1 electric scooter.

- Do not use the scooter on rainy days to avoid rainwater entering the battery compartment and damaging the scooter.
- Before driving the scooter, please make sure the scooter's screws are tightened and the brake system is working properly.
- Persons without excellent vision, balance, coordination, reflex, muscle and bone strength and good decision-making capabilities should not use this product.
- The user of this product assumes ALL risks associated with its use. To minimize these RISKS, the user must wear safety helmet, goggles, gloves, elbow and knee pads and appropriate footwear.
- This manual contains important safety information. It is your responsibility to review this information and make sure that all riders understand all warnings, cautions, instructions and safety. We're not liable for incidental damages or consequential damages due directly or indirectly to the use of this product.
- Riding the electric scooter can be a hazardous activity. Certain conditions may cause the equipment to fail without fault of the manufacturer. Like other electric products, the scooter can and is intended to move and it is therefore possible to lose control, fall off and/or get into dangerous situations that no amount of care, instruction or expertise can eliminate. If such things occur you can be seriously injured or die, even when using safety equipment and other precautions. RIDE AT YOUR OWN RISK AND USE COMMON SENSE.

ALWAYS FOLLOW THE LOCAL LAWS AND REGULATIONS.

- Understand your local laws permitting the use of Electric scooters, please use this product within the scope of the law.
- Never ride your scooter in conditions of poor visibility.
- Do not do stunts, wheelies or jumps. They will increase your chances of injury and damage your ANGWATT C1.
- Never carry passengers.

PACKING LIST

C1 Electric Scooter	1 Pc
Charger	2 Pcs
Installation Tool	1 Pc
User Manual	1 Pc
Key	2 Pcs
CE Certification	1 Pcs

INSTALLATION GUIDE

TURN SIGNAL INSTALLATION GUIDE

Front turn signal

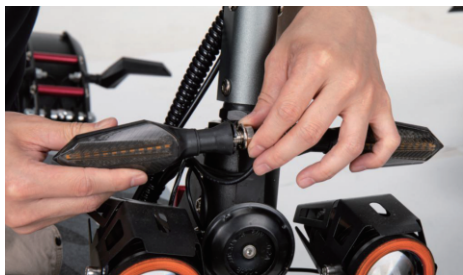

Rear turn signal

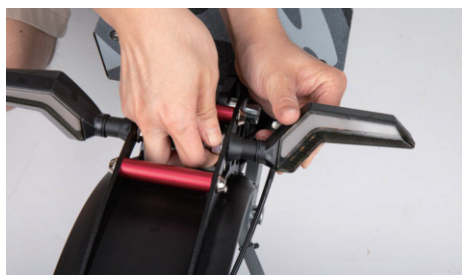

PRODUCT INTRODUCTION



Items	Specifications
Brand	ANGWATT
Model	C1
Motor	Dual 1200W (Peak Power) Motors
Battery	52V 28Ah Lithium Battery
Tire	10inch Off-Road Pneumatic Tire
Controller	28+1A Controller*2
Brake	Front and Rear Oil Brake & EABS
Max Speed	55-65 Km/h
Max Range	60-80 KM
Climbing Angle	45°
Max Load	150 KG
Gross Weight	38 KG
Unfolding Size	117*68*125-143 cm
Folding Size	117*68*48 cm
Package Size	131*26*50 cm

•Due to differences in test environments and drivers, data such as mileage, speed, and climbing will vary to a certain extent, and the performance of the scooter actually received for specific data shall prevail.

MAIN PARTS INTRODUCTION

Folding buckle introduction

Step 1 Pull down the red button.



Step 2 Pull down the silver buckle, at the same time Fold or Unfold the scooter.



Notice: After folding or unfolding the scooter, please press the red buckle tightly into the groove to avoid loosening.

Charging Port Introduction

The charging port is located in the battery compartment, there are two in total, you can choose to use it at the same time, or you can choose to use one alone.



HANDLEBAR PARTS INTRODUCTION



① Light switch button

④ Voltage display

⑦ Mode selection button

⑩ Handbrake (right)

② Turn signal light button

⑤ Key hole

⑧ Throttle

⑪ Handbrake (left)

③ Horn button

⑥ Computer switch button

⑨ Drive conversion button

COMPUTER INTRODUCTION



① Speed gear

④ Mileage

② Speed(mph,kmh)

⑤ Power

③ Start up mode

STORAGE AND MAINTENANCE

Maintenance and cleaning

If you see stains on the scooter's body, wipe them off with a damp cloth. If the stains won't scrub off, put on some toothpaste, and brush them with a toothbrush, then wipe them off with a damp cloth. If you see scratches on plastic parts, use sandpaper or other abrasive materials to polish them. Notes: do not clean the scooter with alcohol, gasoline, kerosene or other corrosive and volatile chemical solvents to prevent dire damage. Do not wash the scooter with a high-pressure water spray. During cleaning, make sure that the scooter's turned off, the charging cable is unplugged, and the rubber flap is closed as water leakage may result in electric shock or other major problems.

Storage

When not using the scooter, place it in a dry and cool indoor environment free of sundries and flammable items. Do not leave it outside for a long time. Excessive sun exposure, high and low temperatures can accelerate tire aging, and rain can damage the life of the scooter and battery.

Battery maintenance

1. Use original battery packs, use of other models or brands may bring about safety issues;
2. Do not touch the contacts. Do not dismantle or puncture the casing. Keep the contacts away from metal objects to prevent short circuit which may result in battery damage or even injuries and deaths;
3. Use original power adapter to avoid potential damage or fire;
4. Mishandling of used batteries may do tremendous harm to the environment. To protect natural environment, please follow local regulations to properly dispose used batteries.
5. After every use, fully charge the battery to prolong its lifespan.
6. Recommended charging time
Charging with 1 charger: 12~13 hours
Charging with 2 chargers: 6~7 hours
7. Please keep an eye on the scooter during charging to avoid overcharging.

Do not place the battery in an environment where the ambient temperature is higher than 50°C or lower than -20°C (e.g., do not leave the scooter or the battery pack in a car under direct sunlight for an extended time). Do not throw the battery pack into fire as it may lead to battery failure, battery overheating, and even another fire. If the scooter is expected to be left idle for more than 30 days, please fully charge the battery and place it in a dry and cool place. Keep in mind to recharge it every 60 days to protect the battery from potential damage which is beyond limited warranty.

Always charge before exhausting the battery to prolong the battery's lifespan. The battery pack performs better at normal temperature, and poor when it is below 0°C. For instance, when it is below -20°C, the riding range is only half or less at normal state. When the temperature rises, the riding range restores.

Note: The built-in intelligent chip will keep a log of its charging and discharging records. The damage caused by prolonged no charge is irreversible and is beyond limited warranty. Once the damage is done, the battery can not be recharged (non-professionals are forbidden to dismantle the battery pack, as it may cause electric shock, short circuit or even major safety accidents).

WARRANTY INSTRUCTIONS

Items	Parts Name	Warranty Period
Main Parts	Motor	12 monthes
	Battery	
	Controller	

Function Parts	The charger	3 monthes
	Front light	
	Tail light	
	Brake light	
	Brake device	
	Accelerator	
Appearance Parts	Paint Logo	No warranty
	Sticker	
	Mudguard	
	Other accessories not shown in list	

Note:

If you find that the goods are damaged due to transportation, please contact the seller within 3 days. They will send you the corresponding accessories. After more than 3 days, the seller will not be responsible for the damage caused by transportation.

If your scooter is damaged due to improper use (violent use/overload use/impact damage), this is not covered by the warranty.

If the battery capacity declines by 30% within one year, you can contact us for after-sales maintenance. (If the battery problem is caused by long-term non-charging, man-made damage, water in the battery compartment, etc., it is not covered by the warranty and needs to be repaired at your own expense).

FAQ

Q1: *Can I use this scooter product in rainy weather?*

A1: You cannot use the scooter on rainy days. If the scooter is damaged due to water entering the battery compartment, you will lose your battery warranty.

Q2: *Can I modify my scooter?*

A2: You can modify the scooter according to your personal preferences. Of course, if some parts are damaged due to modification, you will lose the corresponding warranty.

Q3: *Do you have after-sales points in Europe?*

A3: Of course, we currently have a maintenance point in the Czech Republic.

Q4: *How can I buy accessories for my scooter?*

A4: You can buy it through our partner online store. In the future, we will also develop offline stores, which will give you greater convenience.

Q5: *How can I proceed if I need warranty service?*

A5: You can directly contact the seller who sold the product, and we will urge them to provide after-sales service.

ANGWATT