

ANGWATT *C1 MAX* NFC Off-Road Electric Scooter



ANGWATT

User Manual

CONTENTS

ANGWATT C1 MAX HIGHLIGHTS.....	1
SAFE RIDING GUIDELINES.....	2
PACKING LIST.....	3
SPECIFICATION.....	4
PRODUCT STRUCTURE.....	5
HANDLEBAR STRUCTURE.....	6
METER INTRODUCTION.....	7
BASIC USAGE GUIDE.....	8
METER P VALUE SETTING INSTRUCTIONS.....	10
STORAGE AND MAINTENANCE.....	12
WARRANTY INSTRUCTIONS.....	14
FAQ.....	15

Dear customer:

Thank you for choosing ANGWATT electric scooter. We are committed to creating the best quality electric scooter products. Hope ANGWATT C1 MAX will bring you the best journey. May you have a good time.

ANGWATT C1 MAX HIGHLIGHTS

HIGH-CAPACITY BATTERY

The 60V quality battery offers an impressive range of approximately 80-105 km, allowing for extended rides.

2*3000W POWERFUL MOTOR (DRIVE MODE UPGRADE)

New sports dual-drive and economic dual-drive mode designs make the motor more durable. The maximum speed can reach about 75-85 km/h.

Note: ANGWATT C1 MAX doesn't have single drive mode, which is an upgrade.

SUPERIOR SUSPENSION

Front and rear spring suspension ensures excellent shock absorption for a comfortable ride.

DUAL HYDRAULIC BRAKES + ELECTRONIC BRAKE

Provides quick and responsive braking power for added safety.

Newly INTEGRATED NFC SCREEN

Start the scooter with a NFC card for easy operation and enhanced anti-theft protection.

11-INCH OFF-ROAD TUBELESS TIRES

Durable vacuum tires are perfect for city streets and light off-road trails, providing a smooth ride.

COMPREHENSIVE SAFETY FEATURES

Equipped with turn signals, headlights, and riding lights to enhance visibility and safety on the road.

Equipped With Steering Damper

Equipped with a steering damper, it makes you safer and more stable when driving at high speed.

Note: The above battery life and maximum speed data are obtained under the conditions of 75KG load, fully charged, flat road. The actual data may vary due to different usage conditions, which is normal.

SAFE RIDING GUIDELINES

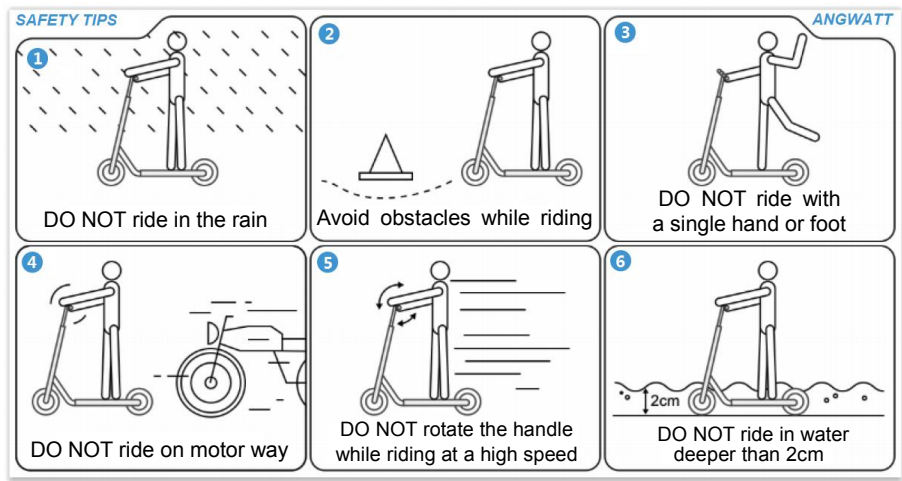

This chapter has been created to help you understand the safe use and maintenance of ANGWATT C1 MAX electric scooter.

- Do not use the scooter on rainy days to avoid rainwater entering the battery compartment and damaging the scooter.
- Before driving the scooter, please make sure the scooter's screws are tightened and the brake system is working properly.
- Persons without excellent vision, balance, coordination, reflex, muscle and bone strength and good decision-making capabilities should not use this product.
- The user of this product assumes ALL risks associated with its use. To minimize these RISKS, the user must wear safety helmet, goggles, gloves, elbow and knee pads and appropriate footwear.
- This manual contains important safety information. It is your responsibility to review this information and make sure that all riders understand all warnings, cautions, instructions and safety. We're not liable for incidental damages or consequential damages due directly or indirectly to the use of this product.

- Riding the electric scooter can be a hazardous activity. Certain conditions may cause the equipment to fail without fault of the manufacturer. Like other electric products, the scooter can and is intended to move and it is therefore possible to lose control, fall off and/or get into dangerous situations that no amount of care, instruction or expertise can eliminate. If such things occur you can be seriously injured or die, even when using safety equipment and other precautions. RIDE AT YOUR OWN RISK AND USE COMMON SENSE.

ALWAYS FOLLOW THE LOCAL LAWS AND REGULATIONS.

- Understand your local laws permitting the use of Electric scooters, please use this product within the scope of the law.
- Never ride your scooter in conditions of poor visibility.
- Do not do stunts, wheelies or jumps. They will increase your chances of injury and damage your ANGWATT C1 MAX.
- Never carry passengers.

PACKING LIST

Package Contents	1 X Electric Scooter
	1 X Manual
	2 X Chargers
	1 X Installation Tool
	2 X NFC Cards

SPECIFICATION

Brand	ANGWATT
Model	C1 MAX
Frame Material	Iron + Aluminum Alloy
Battery	60V Lithium Battery
Motor Power	2*3000W(Peak Power)
Motor Type	Brushless Hall Motor
Controller	2*45A
Charger Specifications	60V 2A
Charger Input Power	AC 110-240V 50-60HZ
Charger Output Voltage	67.2V
Charger Output Current	2A
Single Charger Charging Time	About 13-14 Hours
Dual Charger Charging Time	About 7-8 Hours
Tire	11-Inch Tubeless Tire
Max Mileage	About 80-105 Km
Max Speed	About 75-85 Km/h
Climbing Angle	≤50°
Brake	Dual Oil Brakes + Electronic Brake
Turn Signal	Front & Rear Turn Signals
Driving Lights	Headlight + Sidelight + Taillight
Shock Absorber	Front & Rear Spring Shock Absorber
Opening Method	Power Switch + NFC Card
Max Load	About 200KG
Expand Size	About 133*70*126-144cm
Folded Size	About 131*70*65cm
Net Weight	About 42.3KG
Gross Weight	About 49KG

PRODUCT STRUCTURE

- ① Meter
- ② Control Keyboard
- ③ Handbrake(Left)
- ④ Glove(Left)
- ⑤ Handbrake(Right)
- ⑥ Glove(Right)
- ⑦ Accelerator
- ⑧ Waterproof Convenient Joint
- ⑨ Headlight(With Speaker)
- ⑩ Folding Lock
- ⑪ Front Shock Absorber

- ⑫ Front Fender
- ⑬ Front Brake Light & Turn Signal
- ⑭ Side Riding Light
- ⑮ Front Wheel
- ⑯ Foot Support
- ⑰ Front Brake Disc
- ⑱ Charging Port
- ⑲ Rear Brake Light & Turn Signal
- ⑳ Rear Arm
- ㉑ Waterproof Silicone Pad
- ㉒ Carrying Handle (Can Be Stepped On)

- ㉓ Rear Riding Light
- ㉔ Rear Shock Absorber
- ㉕ Rear Fender
- ㉖ Rear Brake Disc
- ㉗ Rear Wheel
- ㉘ Rear Motor
- ㉙ Front Motor
- ㉚ Steering Damper

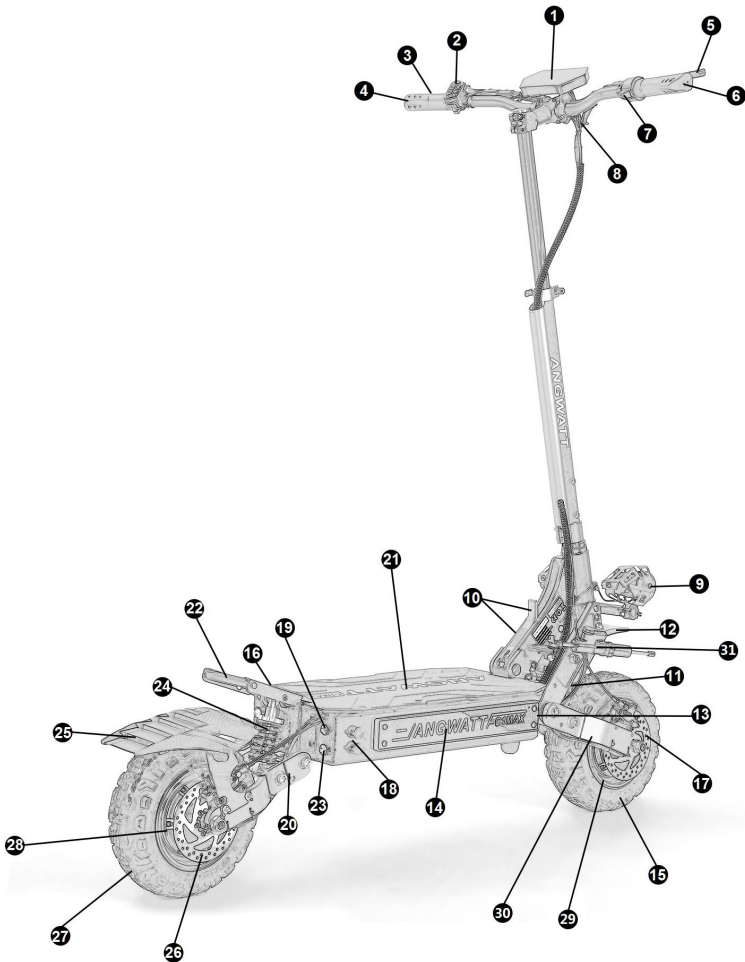

HANDLEBAR STRUCTURE

- ① Glove (Right)
- ② Glove (Left)
- ③ Handbrake (Right)
- ④ Handbrake (Left)
- ⑤ Meter
- ⑥ Accelerator
- ⑦ Horn Button
- ⑧ Upshift Button
- ⑨ Downshift Button
- ⑩ Light Switch
- ⑪ Power Switch
- ⑫ Sport Mode/ECO Mode Button
- ⑬ Turn Signal Button

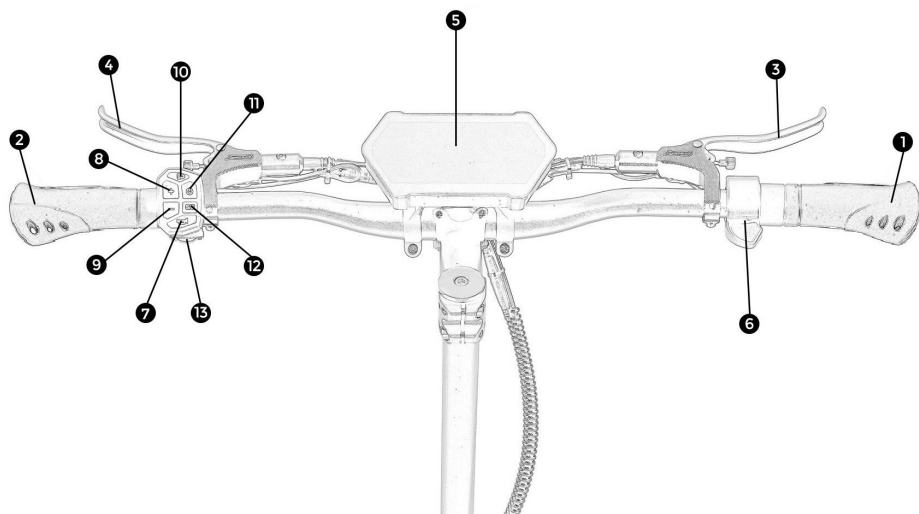

METER INTRODUCTION

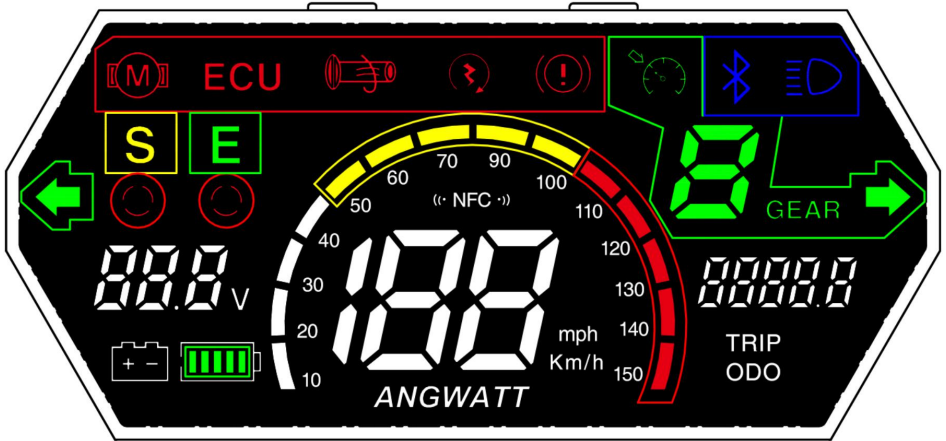

ICON	MEANING	ICON	MEANING
	Left Turn Signal		Right Turn Signal
	Battery Display		Speed Display
	Lights On		Braking
ECU	Controller Error	mph Km/h	Speed Unit (KMH/MPH)
S	Sport Mode	E	ECO Mode
	Bluetooth Display (Not Applicable)		Throttle Error
	Motor Error		Cruise Control
	Zero Star/ Non-Zero Start	TRIP ODO	TRIO: Single Mileage ODO: Total Mileage
	Total Mileage		Speed Gear

BASIC USAGE GUIDE

1. How to turn on the electric scooter: First press the "Power Switch", then touch the screen with the "NFC card", hear a beeping sound, and then the "Meter" turns on, indicating that the electric scooter has been started. (Note: The entire NFC card should tightly attached to the Meter. After successfully turning on the electric scooter, you can take it away)

2. How to turn off the electric scooter: Touch the screen with the "NFC card", hear a beeping sound, and the "Meter" turns off, indicating that the electric scooter has been turned off. (Note: There is no need to press the "Power Switch" to turn off the electric scooter.)

3. How to change the speed gear: Increase the speed gear by pressing "+", and decrease the speed gear by pressing "-".

***4. About the "S/E" button: S means sport dual drive mode, and the scooter in high performance condition. E means Economic dual drive mode, and the scooter in low performance condition. In S mode, the scooter can achieve the best speed & climbing performance. In E mode, it can achieve the best endurance.**

5. How to turn on the lights: Press "Light Switch" to turn on the headlights, side lights, and front and rear riding lights. Turn on the turn signal by pressing the "turn signal button" and turn on the brake light by pressing the "handbrake".

6. How to enter the engineering mode: After turning on the electric scooter, press "+" and "-" at the same time for 3-5 seconds to enter the engineering mode and modify the P value of the scooter.

7. How to modify the P value in engineering mode: On the engineering mode page, short press "Power Switch" to switch the P value. Short press "+" or "-" to change the parameters of P value. After selecting the parameter of the required P value, press "Power Switch" to switch to the next P value. After all, you can press "+" and "-" again for 3-5 seconds to exit engineering mode.

8. How to break/limit the maximum speed: Hold the brake and increase the throttle to the maximum without releasing it. After turning on the machine and waiting for more than 3 seconds, release the throttle and brake to switch the speed limit mode/release the speed limit mode.

9. How to switch the display of ODO, TRIP, VOL, TIME in the meter: Short press the power button after turning on the meter.

10. How to enter/exit cruise mode: If you hold down the accelerator for a long time, the scooter will enter the cruise mode. You only need to release the accelerator and then press it again to cancel the cruise mode. (You can also set the P value to turn off the cruise mode forever)

11. About the meaning of error value:

E1: Motor fault

E2: Twist handle fault

E3: Controller fault

E5: Undervoltage (Battery drain, Just charge it.)

E6: Communication fault, the instrument cannot receive the signal from the controller

E7: Communication fault, the controller cannot receive the signal from the instrument

METER P VALUE SETTING INSTRUCTIONS

P-Value	Function	Operation Method
P00	ODO(total trip) data clearing	The P value interface stays at P00. Press the "+" for 5 seconds to clear the ODO data. It cannot be restored after clearing.
P01	Mileage unit setting	The P value interface stays at P01. Press "+" or "-" to select the mileage unit, 0 is km, 1 is mile.
P02	Wheel diameter	Unchangeable, default unit is inch, precision is 0.1.
P03	Voltage level	Do not change, the default is 48V.
P04	Meter sleep time setting	The P value interface stays at P04. Press "+" or "-" to select 3 minutes/5 minutes/10 minutes of inactivity to enter the sleep state.

P05	Speed limit ratio setting	The P value interface stays at P05. In the non-speed limit state, press "+" or "-" to select a value from 0 to 100 (not the actual speed, the value is positively correlated with the actual speed).
P06	Start mode setting	The P value interface stays at P06. Press "+" or "-" to select the startup mode, 0 is zero startup, 1 is non-zero startup.
P07	Electronic brake strength setting	The P value interface stays at P07. Press "+" or "-" to select a value 1 to 5 (the value is positively correlated with the strength of the electronic brake).
P08	Cruise control setting	The P value interface stays at P08. Press "+" or "-" to select whether to turn on the cruise mode. 0 is off and 1 is on.
P09	Speed gear number setting	The P value interface stays at P09. Press "+" or "-" to select 3 or 5 speed gears.

STORAGE AND MAINTENANCE

Maintenance and cleaning

If you see stains on the scooter's body, wipe them off with a damp cloth. If the stains won't scrub off, put on some toothpaste, and brush them with a toothbrush, then wipe them off with a damp cloth. If you see scratches on plastic parts, use sandpaper or other abrasive materials to polish them. Notes: do not clean the scooter with alcohol, gasoline, kerosene or other corrosive and volatile chemical solvents to prevent dire damage. Do not wash the scooter with a high-pressure water spray. During cleaning, make sure that the scooter's turned off, the charging cable is unplugged, and the rubber flap is closed as water leakage may result in electric shock or other major problems.

Storage

When not using the scooter, place it in a dry and cool indoor environment free of sundries and flammable items. Do not leave it outside for a long time. Excessive sun exposure, high and low temperatures can accelerate tire aging, and rain can damage the life of the scooter and battery.

Battery maintenance

1. Use original battery packs, use of other models or brands may bring about safety issues;
2. Do not touch the contacts. Do not dismantle or puncture the casing. Keep the contacts away from metal objects to prevent short circuit which may result in battery damage or even injuries and deaths;
3. Use original power adapter to avoid potential damage or fire;

4. Mishandling of used batteries may do tremendous harm to the environment. To protect natural environment, please follow local regulations to properly dispose used batteries.

5. After every use, fully charge the battery to prolong its lifespan.

6. Recommended charging time, single charger charging time: about 13-14 hours, dual charger charging time: about 7-8 hours.

7. Please keep an eye on the scooter during charging to avoid overcharging.

Do not place the battery in an environment where the ambient temperature is higher than 50°C or lower than -20°C (e.g., do not leave the scooter or the battery pack in a car under direct sunlight for an extended time). Do not throw the battery pack into fire as it may lead to battery failure, battery overheating, and even another fire. If the scooter is expected to be left idle for more than 30 days, please fully charge the battery and place it in a dry and cool place. Keep in mind to recharge it every 60 days to protect the battery from potential damage which is beyond limited warranty.

Always charge before exhausting the battery to prolong the battery's lifespan. The battery pack performs better at normal temperature, and poor when it is below 0°C. For instance, when it is below -20°C, the riding range is only half or less at normal state. When the temperature rises, the riding range restores.

Note: The built-in intelligent chip will keep a log of its charging and discharging records. The damage caused by prolonged no charge is irreversible and is beyond limited warranty. Once the damage is done, the battery can not be recharged (non-professionals are forbidden to dismantle the battery pack, as it may cause electric shock, short circuit or even major safety accidents).

WARRANTY INSTRUCTIONS

Item	Parts Name	Warranty Period
Main Parts	Motor	6 months
	Battery	12 months
	Controller	6 months
Function Parts	The charger	3 months
	Front light	
	Tail light	
	Brake light	
	Brake device	
	Accelerator	
Appearance Parts	Paint Logo	No warranty
	Sticker	
	Mudguard	
	Other accessories not shown in list	

Note:

If you find that the goods are damaged due to transportation, please contact the seller within 3 days. They will send you the corresponding accessories. After more than 3 days, the seller will not be responsible for the damage caused by transportation.

If your scooter is damaged due to improper use (violent use/overload use/impact damage), this is not covered by the warranty.

If the battery capacity declines by 30% within one year, you can contact us for after-sales maintenance. (If the battery problem is caused by long-term non-charging, man-made damage, water in the battery compartment, etc., it is not covered by the warranty and needs to be repaired at your own expense).

FAQ

Q1: Can I use this scooter product in rainy weather?

A1: You cannot use the scooter on rainy days. If the scooter is damaged due to water entering the battery compartment, you will lose your battery warranty.

Q2: Can I modify my scooter?

A2: You can modify the scooter according to your personal preferences. Of course, if some parts are damaged due to modification, you will lose the corresponding warranty.

Q3: Do you have after-sales points in Europe?

A3: Of course, we currently have a maintenance point in the Czech Republic.

Q4: How can I buy accessories for my scooter?

A4: You can buy it through our partner online store. In the future, we will also develop offline stores, which will give you greater convenience.

Q5: How can I proceed if I need warranty service?

A5: You can directly contact the seller who sold the product, and we will urge them to provide after-sales service.

Q6: What should I do if I lose my NFC card?

A6: If you only lose one of the two NFC cards, you can buy a blank card and copy the information into the blank card. If both cards are lost, you can only replace the meter with a new one.

HAPPY RIDING

ANGWATT