

Thank you for purchasing a SonicModell product!



THE NEW BENCHMARK FOR FPV WINGS

Ideal for beginners and experienced pilots alike.
Tough, fast and extremely maneuverable.
Smart design for better FPV gear placement.

SPECIFICATIONS:

- Material: High Quality EPP
- Wingspan: 1000mm (39.37")
- Length: 450mm (17.71")
- Motor: 2216-1400KV
- ESC: 40A w/5V 3A BEC
- Servos: 2pcs Analog Metal Gear 9g
- Propeller: 2 blades 8x5
- Recommended Battery: Lipo 4S 3200-3500mAh
ZOHD Lionpack 18650 4S2P 7000mAh

This unit is designed to carry the DJI HD FPV System without any mods.

- Min recommended speed: 31km/h
- Max speed (with SONICMODELL power combo): 130km/h
- Cruise speed (with SONICMODELL power combo): 75/80km/h @ 5.5A
- Max speed tested without structural failure: 220km/h with no structural damage or twist on elevons
- Max recommended take off weight (with SONICMODELL power combo): 1425 grams
- Reflex on elevons: 1.5-2mm at level
- Recommended max. throws: 12mm



Thanks to Painless360 for the support during development.

Follow us on

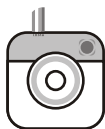

Contact us: info@sonicmodell.com
sales@sonicmodell.com
Customer service: cs@sonicmodell.com

www.sonicmodell.com

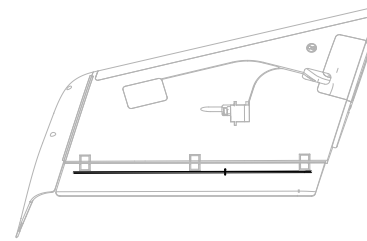

Glue the carbon fiber spar and control horn for aileron enhancement.

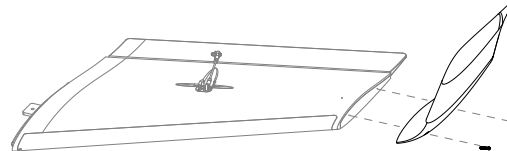

Use the 2 provided screws to fix the wingtips. Is not a bad idea to also glue them for extra strength on landings.

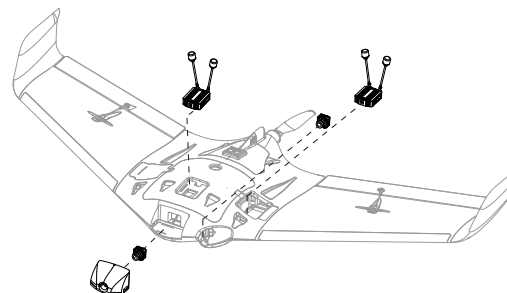
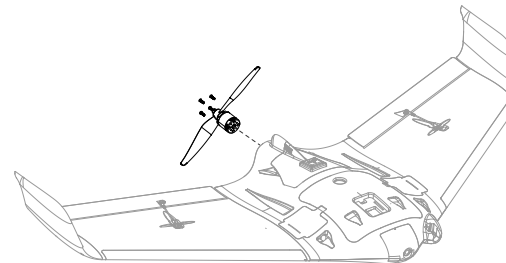

This unit is especially designed to host the DJI HD FPV system. You have a top hatch and a nose dedicated for it. You can also place the DJI system on the side bays, but we recommend you to use the central placement for better cooling and horizontal balance.

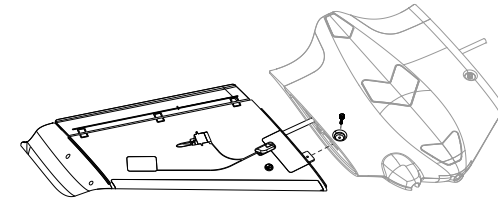

Use the thumbscrews to secure the wings for flight. After wing removal screw them back into place to avoid losing them.

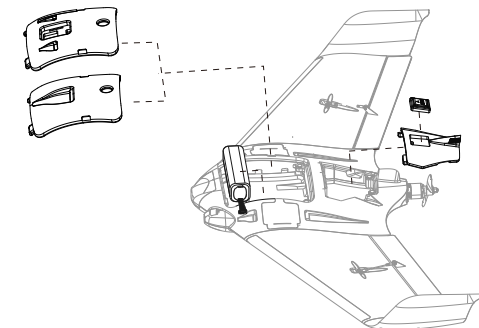
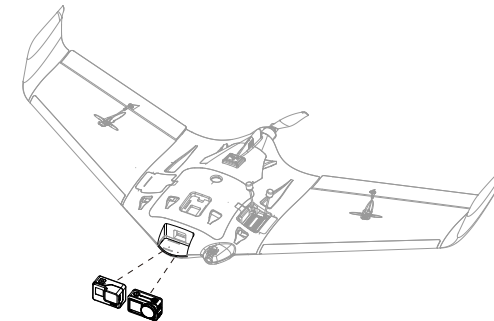

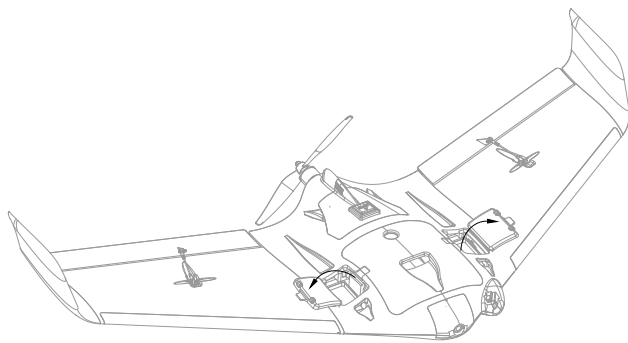

The specially air-cooled side bays open to the sides for you to place any gear you want.

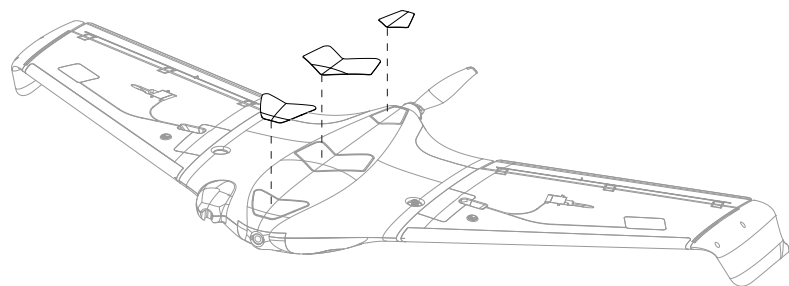

Please stick the Teflon landing skin according to the graphic.

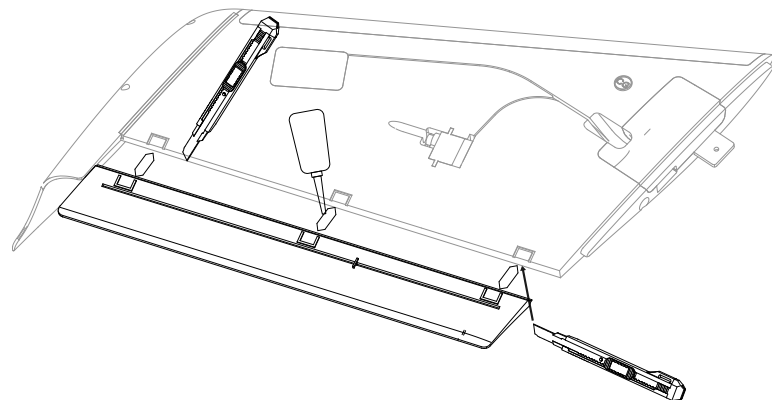

If you plan to install the provided CA hinges, please cut the EPP following the markings on wings and elevons for a proper alignment. Also make sure you leave around 1mm clearance between the elevon and the trailing edge of the wing so the control surface can move freely. Don't overdo with the glue!

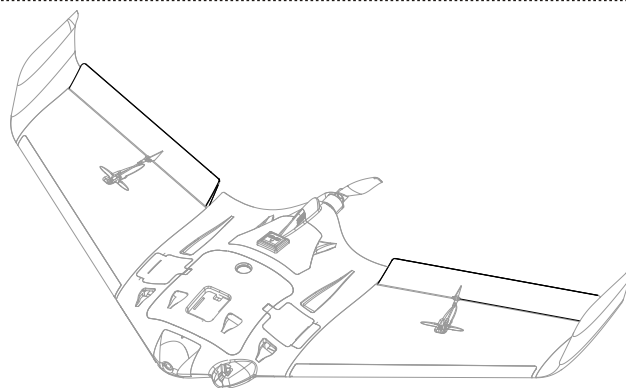
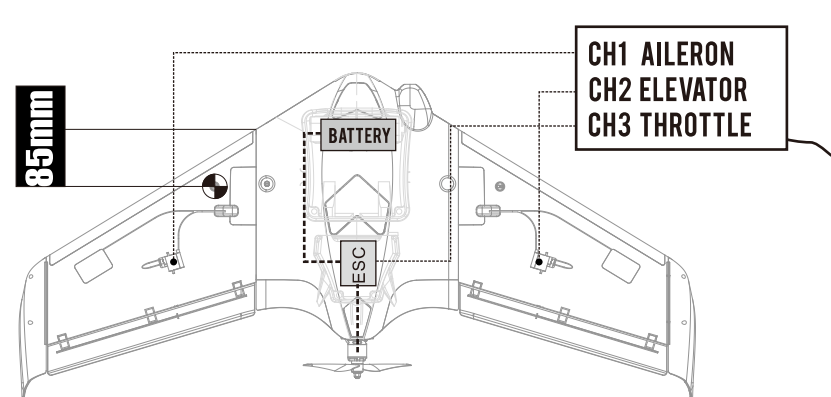

MODE 1

MODE 2

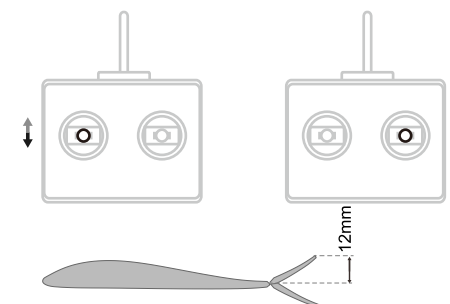

RECOMMENDED THROWS

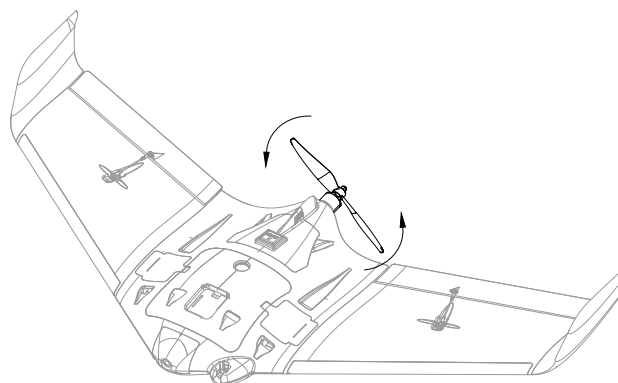

MODE 1

MODE 2

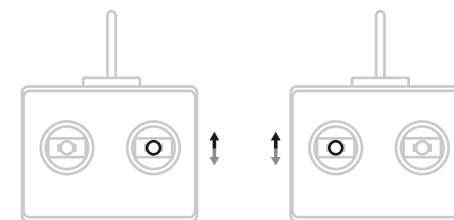

CAUTION:

- You will need EPO/EPP safe glue to assemble this unit. Please be sure you have the right type of glue testing on a scrap piece of foam from the kit.
- This product is NOT a toy. Adult supervision is required for those under 14 years old. Improper adjustments and operation will result in damage to the item and/or injuries to the operator. Experience is required prior to handling this product.