

# *ANGWATT CS1 PRO*

## NFC City Electric Scooter



***ANGWATT***

**User Manual**

# CONTENTS

ANGWATT CS1 PRO HIGHLIGHTS.....	1
SAFE RIDING GUIDELINES.....	2
PACKING LIST.....	3
SPECIFICATION.....	4
PRODUCT STRUCTURE.....	5
HANDLEBAR STRUCTURE.....	6
METER INTRODUCTION.....	7
BASIC USAGE GUIDE.....	8
METER P VALUE SETTING INSTRUCTIONS.....	10
STORAGE AND MAINTENANCE.....	12
WARRANTY INSTRUCTIONS.....	14
FAQ.....	15
START-UP INSTRUCTIONS.....	16

---

## **Dear customer:**

Thank you for choosing ANGWATT electric scooter. We are committed to creating the best quality electric scooter products. Hope ANGWATT CS1 PRO will bring you the best journey. May you have a good time.

# **ANGWATT CS1 PRO HIGHLIGHTS**

## **HIGH-CAPACITY BATTERY**

The 52V 22.5Ah battery offers an impressive range of approximately 65-85 km, allowing for extended rides.

## **POWERFUL 1500W MOTOR**

Experience with a maximum speed of around 50-60 km/h, making it ideal for both commuting and recreational use.

## **SUPERIOR SUSPENSION**

Front and rear spring suspension ensures excellent shock absorption for a comfortable ride.

## **Front Disc + Rear Hydraulic + Electronic Brake**

Provides quick and responsive braking power for added safety.

## **INTEGRATED NFC SCREEN**

Start the scooter with a NFC card for easy operation and enhanced anti-theft protection.

## **11-INCH ALL-TERRAIN TIRES**

Durable vacuum tires are perfect for city streets and light off-road trails, providing a smooth ride.

## **COMPREHENSIVE SAFETY FEATURES**

Equipped with turn signals, headlights, and riding lights to enhance visibility and safety on the road.

## **29A INTEGRATED CONTROLLER**

Offers multiple functions and easy maintenance for a reliable riding experience.

**Note:** The above battery life and maximum speed data are obtained under the conditions of 75KG load, fully charged, flat road. The actual data may vary due to different usage conditions, which is normal.

# **SAFE RIDING GUIDELINES**

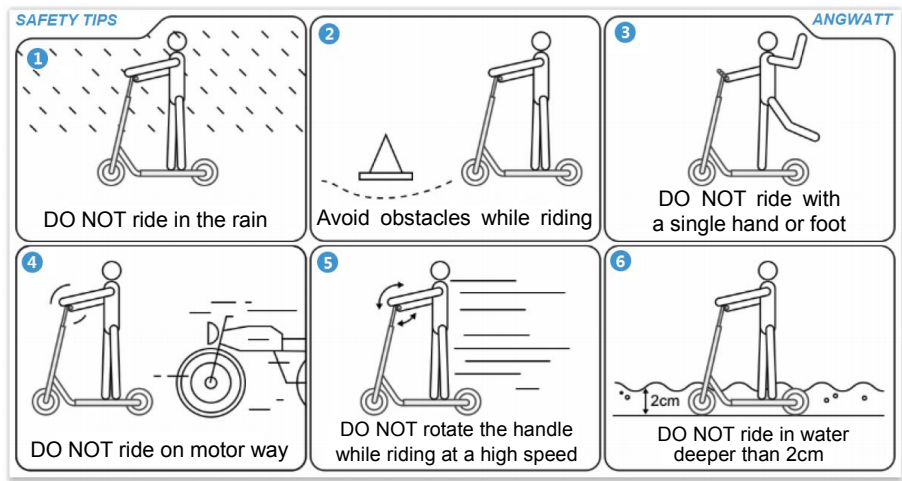

**This chapter has been created to help you understand the safe use and maintenance of ANGWATT CS1 PRO electric scooter.**

- Do not use the scooter on rainy days to avoid rainwater entering the battery compartment and damaging the scooter.
- Before driving the scooter, please make sure the scooter's screws are tightened and the brake system is working properly.
- Persons without excellent vision, balance, coordination, reflex, muscle and bone strength and good decision-making capabilities should not use this product.
- The user of this product assumes ALL risks associated with its use. To minimize these RISKS, the user must wear safety helmet, goggles, gloves, elbow and knee pads and appropriate footwear.
- This manual contains important safety information. It is your responsibility to review this information and make sure that all riders understand all warnings, cautions, instructions and safety. We're not liable for incidental damages or consequential damages due directly or indirectly to the use of this product.

- Riding the electric scooter can be a hazardous activity. Certain conditions may cause the equipment to fail without fault of the manufacturer. Like other electric products, the scooter can and is intended to move and it is therefore possible to lose control, fall off and/or get into dangerous situations that no amount of care, instruction or expertise can eliminate. If such things occur you can be seriously injured or die, even when using safety equipment and other precautions. RIDE AT YOUR OWN RISK AND USE COMMON SENSE.

**ALWAYS FOLLOW THE LOCAL LAWS AND REGULATIONS.**

- Understand your local laws permitting the use of Electric scooters, please use this product within the scope of the law.
- Never ride your scooter in conditions of poor visibility.
- Do not do stunts, wheelies or jumps. They will increase your chances of injury and damage your ANGWATT CS1 PRO.
- Never carry passengers.

**PACKING LIST**

Package Contents	1 X Electric Scooter
	1 X Manual
	1 X Charger
	1 X Installation Tool
	2 X NFC Cards

# **SPECIFICATION**

Brand	ANGWATT
Model	CS1 PRO
Frame Material	Iron + Aluminum Alloy
Battery	52V 22.5Ah Lithium Battery
Drive	1500W(Peak Power)
Drive Type	Brushless Hall Motor
Controller	29A
Charger Specifications	52V 2A
Charger Input Power	AC 110-240V 50-60HZ
Charger Output Voltage	58.8V
Charger Output Current	2A
Charger Charging Time	About 10 Hours
Tire	11-Inch Tubeless Tire
Max Mileage	About 65-85 Km
Max Speed	About 50-60 Km/h
Climbing Angle	≤30°
Brake	Front Disc + Rear Hydraulic + Electronic Brake
Turn Signal	Rear Turn Signals
Driving Lights	Headlight + Sidelight + Taillight
Shock Absorber	Front & Rear Spring Shock Absorber
Opening Method	Power Switch + NFC Card /Password
Max Load	About 120KG
Expand Size	About 132*68*130cm
Folded Size	About 132*68*60cm
Net Weight	About 30KG
Gross Weight	About 37kg

# PRODUCT STRUCTURE

- |                               |                             |   |
|-------------------------------|-----------------------------|---|
| ① Control Keyboard            | ⑫ Front Fender              | ⑳ Hook Slot                                     |
| ② Glove(Left)                 | ⑬ Front Shock Absorber      | ㉑ Footboard                                     |
| ③ Handbrake(Left)             | ⑭ Front Brake Disc          | ㉒ Brake Light & Turn Signal & Riding Rear Light |
| ④ Meter                       | ⑮ Front Arm(Left)           | ㉓ Rear Shock Absorber                           |
| ⑤ Handbrake(Right)            | ⑯ Front Wheel               | ㉔ Rear Fender                                   |
| ⑥ Accelerator                 | ⑰ Front Riding Light        | ㉕ Rear Wheel                                    |
| ⑦ Glove(Right)                | ⑱ Foot Support              | ㉖ Rear Motor                                    |
| ⑧ Waterproof Convenient Joint | ㉗ Side Light                | ㉘ Rear Brake Disc                               |
| ⑨ Hook                        | ㉙ Safety Reflective Sticker | ㉚ Rear Arm(Left)                                |
| ⑩ Folding Lock                | ㉛ Charging Port             | ㉜ Riding Rear Light                             |
| ⑪ Headlight                   | ㉝ Waterproof Silicone Pad   |   |

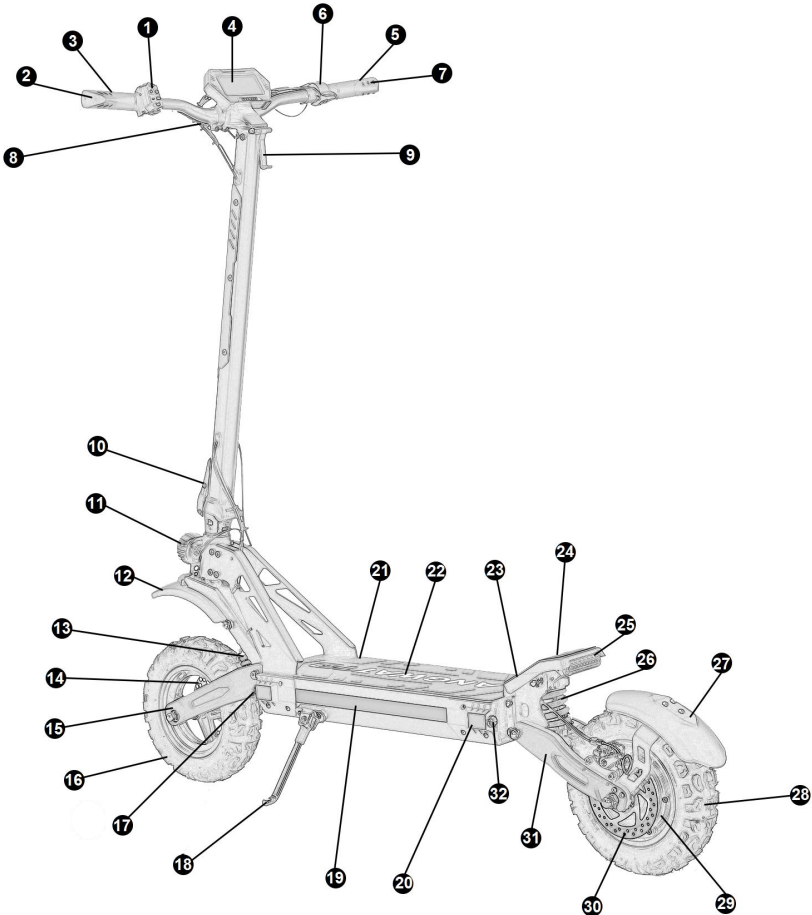

# HANDLEBAR STRUCTURE

- |   |  |
|---|--|
| <ul style="list-style-type: none"><li>❶ Glove (Right)</li><li>❷ Glove (Left)</li><li>❸ Handbrake (Right)</li><li>❹ Handbrake (Left)</li><li>❺ Meter</li><li>❻ Accelerator</li><li>❼ Horn Button</li></ul> | <ul style="list-style-type: none"><li>❽ Upshift Button</li><li>❾ Downshift Button</li><li>❿ Light Switch</li><li>⓫ Power Switch</li><li>⓬ Do Not Move/Sport Mode Switch</li><li>⓭ Turn Signal Button</li></ul> |
|---|--|

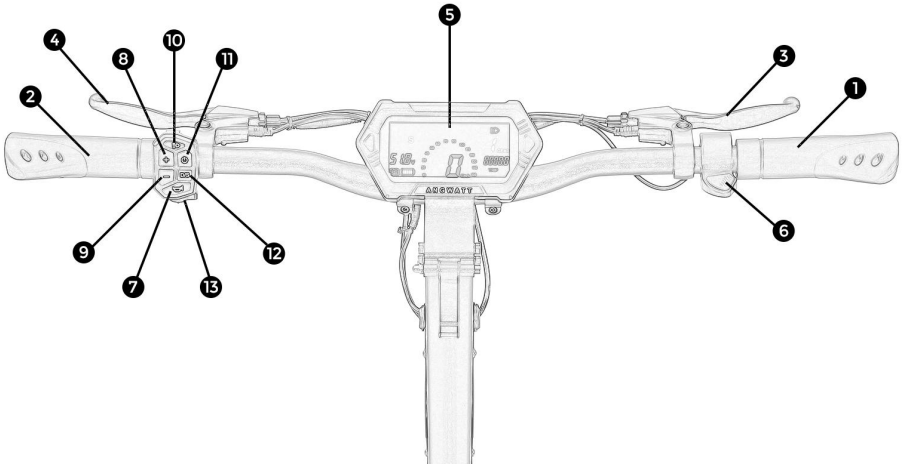

# METER INTRODUCTION

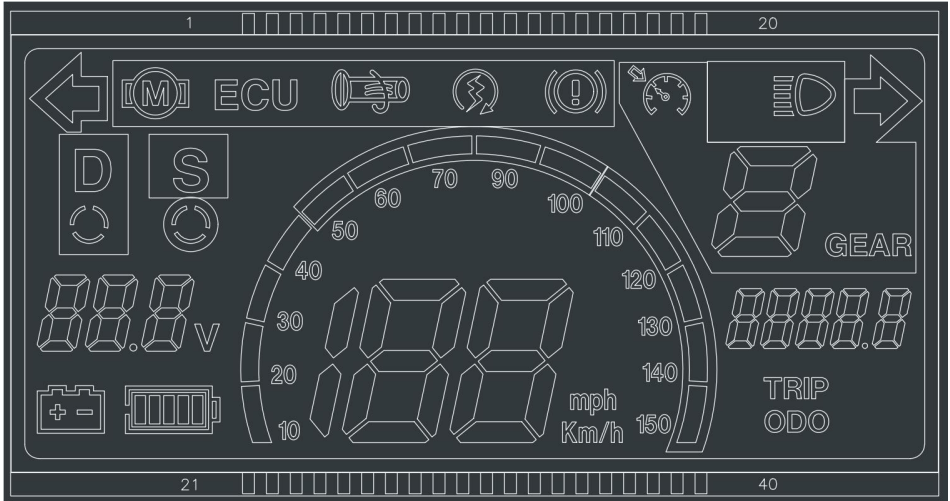

ICON	MEANING	ICON	MEANING
	Left Turn Signal		Right Turn Signal
	Battery Display		Speed Display
	Lights On		Braking
ECU	Controller Error	mph Km/h	Speed Unit (KMH/MPH)
D	Parking Mode	S	Sport Mode
	Bluetooth Display (Not Applicable)		Throttle Error
	Motor Error		Cruise Control
	Zero Star/ Non-Zero Start	TRIP ODO	TRIO: Single Mileage ODO: Total Mileage
TRIP ODO	Total Mileage		Speed Gear

# **BASIC USAGE GUIDE**

**1. How to turn on the electric scooter:** First press the "Power Switch", then touch the screen with the "NFC card", hear a beeping sound, and then the "Meter" turns on, indicating that the electric scooter has been started. (Note: The entire NFC card should tightly attached to the Meter. After successfully turning on the electric scooter, you can take it away)

**2. How to turn off the electric scooter:** Touch the screen with the "NFC card", hear a beeping sound, and the "Meter" turns off, indicating that the electric scooter has been turned off. (Note: There is no need to press the "Power Switch" to turn off the electric scooter.)

**3. How to change the speed gear:** Increase the speed gear by pressing "+", and decrease the speed gear by pressing "-".

**4. About the "D/S" button:** D means the scooter cannot move and is in parking mode, and S means sports mode. If you need to push the scooter for a short time, you can switch the scooter to D mode (parking mode). **If you press the parking mode during riding, the scooter will not be able to accelerate and will slowly stop. You can immediately press it again to enter the sports mode to accelerate.**

**5. How to turn on the lights:** Press "Light Switch" to turn on the headlights, side lights, and front and rear riding lights. Turn on the turn signal by pressing the "turn signal button" and turn on the brake light by pressing the "handbrake".

**6. How to enter the engineering mode:** After turning on the electric scooter, press "+" and "-" at the same time for 3-5 seconds to enter the engineering mode and modify the P value of the scooter.

**7. How to modify the P value in engineering mode:** On the engineering mode page, short press "Power Switch" to switch the P value. Short press "+" or "-" to change the parameters of P value. After selecting the parameter of the required P value, press "Power Switch" to switch to the next P value. After all, you can press "+" and "-" again for 3-5 seconds to exit engineering mode.

**8. How to break/limit the maximum speed:** Hold the brake and increase the throttle to the maximum without releasing it. After turning on the machine and waiting for more than 3 seconds, release the throttle and brake to switch the speed limit mode/release the speed limit mode.

**9. How to switch the display of ODO, TRIP, VOL, TIME in the meter:** Short press the power button after turning on the meter.

**10. How to enter/exit cruise mode:** If you hold down the accelerator for a long time, the scooter will enter the cruise mode. You only need to release the accelerator and then press it again to cancel the cruise mode. (You can also set the P value to turn off the cruise mode forever)

**11. About the meaning of error value:**

E1: Motor fault

E2: Twist handle fault

E3: Controller fault

E5: Undervoltage fault (Battery drain, Just charge it.)

E6: Communication fault, the instrument cannot receive the signal from the controller

E7: Communication fault, the controller cannot receive the signal from the instrument

# **METER P VALUE SETTING INSTRUCTIONS**

<b>P-Value</b>	<b>Function</b>	<b>Operation Method</b>
P00	ODO(total trip) data clearing	The P value interface stays at P00. Press the "+" for 5 seconds to clear the ODO data. It cannot be restored after clearing.
P01	Mileage unit setting	The P value interface stays at P01. Press "+" or "-" to select the mileage unit, 0 is km, 1 is mile.
P02	Wheel diameter	Unchangeable, default unit is inch, precision is 0.1.
P03	Voltage level	Do not change, the default is 48V.
P04	Meter sleep time setting	The P value interface stays at P04. Press "+" or "-" to select 3 minutes/5 minutes/10 minutes of inactivity to enter the sleep state.

P05	Speed limit ratio setting	The P value interface stays at P05. In the non-speed limit state, press "+" or "-" to select a value from 0 to 100 (not the actual speed, the value is positively correlated with the actual speed).
P06	Start mode setting	The P value interface stays at P06. Press "+" or "-" to select the startup mode, 0 is zero startup, 1 is non-zero startup.
P07	Electronic brake strength setting	The P value interface stays at P07. Press "+" or "-" to select a value 1 to 5 (the value is positively correlated with the strength of the electronic brake).
P08	Cruise control setting	The P value interface stays at P08. Press "+" or "-" to select whether to turn on the cruise mode. 0 is off and 1 is on.
P09	Speed gear number setting	The P value interface stays at P09. Press "+" or "-" to select 3 or 5 speed gears.

# **STORAGE AND MAINTENANCE**

## **Maintenance and cleaning**

If you see stains on the scooter's body, wipe them off with a damp cloth. If the stains won't scrub off, put on some toothpaste, and brush them with a toothbrush, then wipe them off with a damp cloth. If you see scratches on plastic parts, use sandpaper or other abrasive materials to polish them. Notes: do not clean the scooter with alcohol, gasoline, kerosene or other corrosive and volatile chemical solvents to prevent dire damage. Do not wash the scooter with a high-pressure water spray. During cleaning, make sure that the scooter's turned off, the charging cable is unplugged, and the rubber flap is closed as water leakage may result in electric shock or other major problems.

## **Storage**

When not using the scooter, place it in a dry and cool indoor environment free of sundries and flammable items. Do not leave it outside for a long time. Excessive sun exposure, high and low temperatures can accelerate tire aging, and rain can damage the life of the scooter and battery.

## **Battery maintenance**

1. Use original battery packs, use of other models or brands may bring about safety issues;
2. Do not touch the contacts. Do not dismantle or puncture the casing. Keep the contacts away from metal objects to prevent short circuit which may result in battery damage or even injuries and deaths;
3. Use original power adapter to avoid potential damage or fire;

**4.**Mishandling of used batteries may do tremendous harm to the environment. To protect natural environment, please follow local regulations to properly dispose used batteries.

**5.**After every use, fully charge the battery to prolong its lifespan.

**6.**Recommended charging time: About 10 hours.

**7.**Please keep an eye on the scooter during charging to avoid overcharging.

Do not place the battery in an environment where the ambient temperature is higher than 50°C or lower than -20°C (e.g., do not leave the scooter or the battery pack in a car under direct sunlight for an extended time). Do not throw the battery pack into fire as it may lead to battery failure, battery overheating, and even another fire. If the scooter is expected to be left idle for more than 30 days, please fully charge the battery and place it in a dry and cool place. Keep in mind to recharge it every 60 days to protect the battery from potential damage which is beyond limited warranty.

Always charge before exhausting the battery to prolong the battery's lifespan. The battery pack performs better at normal temperature, and poor when it is below 0°C. For instance, when it is below -20°C, the riding range is only half or less at normal state. When the temperature rises, the riding range restores.

Note:The built-in intelligent chip will keep a log of its charging and discharging records. The damage caused by prolonged no charge is irreversible and is beyond limited warranty. Once the damage is done, the battery can not be recharged (non-professionals are forbidden to dismantle the battery pack, as it may cause electric shock, short circuit or even major safety accidents).

# WARRANTY INSTRUCTIONS

Item	Parts Name	Warranty Period
Main Parts	Motor	6 months
	Battery	12 months
	Controller	6 months
Function Parts	The charger	3 months
	Front light	
	Tail light	
	Brake light	
	Brake device	
	Accelerator	
Appearance Parts	Paint Logo	No warranty
	Sticker	
	Mudguard	
	Other accessories not shown in list	

**Note:**

If you find that the goods are damaged due to transportation, please contact the seller within 3 days. They will send you the corresponding accessories. After more than 3 days, the seller will not be responsible for the damage caused by transportation.

If your scooter is damaged due to improper use (violent use/overload use/impact damage), this is not covered by the warranty.

If the battery capacity declines by 30% within one year, you can contact us for after-sales maintenance. (If the battery problem is caused by long-term non-charging, man-made damage, water in the battery compartment, etc., it is not covered by the warranty and needs to be repaired at your own expense).

# **FAQ**

## **Q1: Can I use this scooter product in rainy weather?**

A1: You cannot use the scooter on rainy days. If the scooter is damaged due to water entering the battery compartment, you will lose your battery warranty.

## **Q2: Can I modify my scooter?**

A2: You can modify the scooter according to your personal preferences. Of course, if some parts are damaged due to modification, you will lose the corresponding warranty.

## **Q3: Do you have after-sales points in Europe?**

A3: Of course, we currently have a maintenance point in the Czech Republic.

## **Q4: How can I buy accessories for my scooter?**

A4: You can buy it through our partner online store. In the future, we will also develop offline stores, which will give you greater convenience.

## **Q5: How can I proceed if I need warranty service?**

A5: You can directly contact the seller who sold the product, and we will urge them to provide after-sales service.

## **Q6: What should I do if I lose my NFC card?**

A6: If you only lose one of the two NFC cards, you can buy a blank card and copy the information into the blank card. If both cards are lost, you can only replace the meter with a new one.

# Power ON/OFF Manual

## (English)

### 1.Power ON/OFF By Using NFC Card:

- ①Power ON: Short press the power button, then touch the screen with the NFC card to start the scooter.
- ②Power OFF: The scooter can be turned off by touching the screen with the NFC card, or by long pressing the power button.

### 2.Power ON/OFF By Using Password:

- ①Power ON: Press and hold the power button for at least 5 seconds, and the screen will show F0 R0000. The 4 digits after R are the password. Press "+" or "-" to adjust the password, and press the power button to confirm the value of each password. After entering the correct value, you can turn on the scooter.
- ②Power OFF: Long press the power button to turn the scooter off.
- ③Change Password: When the scooter is turned on, long press "+" and "-" at the same time to enter the setting mode, short press the power button, and switch the P value to 10, 11, 12, 13 to set a 1, 2, 3, 4-digit password respectively. Under the corresponding P value, press "+" or "-" to change the password value, press the power button to confirm, and after modifying the 4 password values, it will automatically exit the setting mode and the password will take effect.

# Manuel de mise sous/hors tension (français)

## 1. Mise sous/hors tension à l'aide de la carte NFC :

- ① Mise sous tension : appuyez brièvement sur le bouton d'alimentation, puis touchez l'écran avec la carte NFC pour démarrer la trottinette.
- ② Mise hors tension : la trottinette peut être éteinte en touchant l'écran avec la carte NFC ou en appuyant longuement sur le bouton d'alimentation.

## 2. Mise sous/hors tension à l'aide du mot de passe :

- ① Mise sous tension : appuyez sur le bouton d'alimentation et maintenez-le enfoncé pendant au moins 5 secondes, et l'écran affichera F0 R0000. Les 4 chiffres après R sont le mot de passe. Appuyez sur « + » ou « - » pour régler le mot de passe, et appuyez sur le bouton d'alimentation pour confirmer la valeur de chaque mot de passe. Après avoir saisi la valeur correcte, vous pouvez allumer la trottinette.
- ② Mise hors tension : appuyez longuement sur le bouton d'alimentation pour éteindre la trottinette.
- ③ Modifier le mot de passe : lorsque le scooter est allumé, appuyez longuement sur « + » et « - » en même temps pour accéder au mode de réglage, appuyez brièvement sur le bouton d'alimentation et changez la valeur P sur 10, 11, 12, 13 pour définir respectivement un mot de passe à 1, 2, 3, 4 chiffres. Sous la valeur P correspondante, appuyez sur « + » ou « - » pour modifier la valeur du mot de passe, appuyez sur le bouton d'alimentation pour confirmer, et après avoir modifié les 4 valeurs de mot de passe, il quittera automatiquement le mode de réglage et le mot de passe prendra effet.

# Accensione/Spengimento Manuale (ITALIANO)

## 1. Accensione/Spengimento tramite scheda NFC:

① Accensione: premere brevemente il pulsante di accensione, quindi toccare lo schermo con la scheda NFC per avviare lo scooter.

② Spengimento: lo scooter può essere spento toccando lo schermo con la scheda NFC o premendo a lungo il pulsante di accensione.

## 2. Accensione/Spengimento tramite password:

① Accensione: tenere premuto il pulsante di accensione per almeno 5 secondi e sullo schermo verrà visualizzato F0 R0000. Le 4 cifre dopo R sono la password. Premere "+" o "-" per regolare la password e premere il pulsante di accensione per confermare il valore di ciascuna password. Dopo aver inserito il valore corretto, è possibile accendere lo scooter.

② Spengimento: premere a lungo il pulsante di accensione per spegnere lo scooter.

③ Cambia password: quando lo scooter è acceso, premi a lungo "+" e "-" contemporaneamente per entrare nella modalità di impostazione, premi brevemente il pulsante di accensione e cambia il valore P su 10, 11, 12, 13 per impostare rispettivamente una password di 1, 2, 3, 4 cifre. Sotto il valore P corrispondente, premi "+" o "-" per cambiare il valore della password, premi il pulsante di accensione per confermare e dopo aver modificato i 4 valori della password, uscirà automaticamente dalla modalità di impostazione e la password avrà effetto.

# Ein-/Ausschaltanleitung (Deutsch)

## 1. Ein-/Ausschalten mit NFC-Karte:

①Einschalten: Drücken Sie kurz die Einschalttaste und berühren Sie dann den Bildschirm mit der NFC-Karte, um den Roller zu starten.

②Ausschalten: Der Roller kann ausgeschaltet werden, indem Sie den Bildschirm mit der NFC-Karte berühren oder die Einschalttaste lange drücken.

## 2. Ein-/Ausschalten mit Passwort:

①Einschalten: Halten Sie die Einschalttaste mindestens 5 Sekunden lang gedrückt, und auf dem Bildschirm wird F0 R0000 angezeigt. Die 4 Ziffern nach R sind das Passwort. Drücken Sie „+“ oder „-“, um das Passwort anzupassen, und drücken Sie die Einschalttaste, um den Wert jedes Passworts zu bestätigen. Nachdem Sie den richtigen Wert eingegeben haben, können Sie den Roller einschalten.

②Ausschalten: Drücken Sie lange die Einschalttaste, um den Roller auszuschalten.

③Passwort ändern: Wenn der Roller eingeschaltet ist, drücken Sie gleichzeitig lange auf „+“ und „-“, um in den Einstellungsmodus zu gelangen, drücken Sie kurz die Einschalttaste und ändern Sie den P-Wert auf 10, 11, 12, 13, um ein 1-, 2-, 3- oder 4-stelliges Passwort festzulegen. Drücken Sie unter dem entsprechenden P-Wert „+“ oder „-“, um den Passwortwert zu ändern, drücken Sie zur Bestätigung die Einschalttaste. Nach der Änderung der 4 Passwortwerte wird der Einstellungsmodus automatisch verlassen und das Passwort wird wirksam.

# Manual de encendido y apagado (España)

## 1. Encendido y apagado mediante tarjeta NFC:

- ① Encendido: pulsa brevemente el botón de encendido y, a continuación, toca la pantalla con la tarjeta NFC para poner en marcha el patinete.
- ② Apagado: el patinete se puede apagar tocando la pantalla con la tarjeta NFC o manteniendo pulsado el botón de encendido.

## 2. Encendido y apagado mediante contraseña:

- ① Encendido: pulsa y mantén pulsado el botón de encendido durante al menos 5 segundos y la pantalla mostrará F0 R0000. Los 4 dígitos después de R son la contraseña. Pulsa "+" o "-" para ajustar la contraseña y pulsa el botón de encendido para confirmar el valor de cada contraseña. Después de introducir el valor correcto, puedes encender el patinete.
- ② Apagado: pulsa durante un tiempo el botón de encendido para apagar el patinete.
- ③ Cambiar contraseña: Cuando el patinete esté encendido, mantenga presionados los botones "+" y "-" al mismo tiempo para ingresar al modo de configuración, presione brevemente el botón de encendido y cambie el valor P a 10, 11, 12, 13 para configurar una contraseña de 1, 2, 3 o 4 dígitos respectivamente. Debajo del valor P correspondiente, presione "+" o "-" para cambiar el valor de la contraseña, presione el botón de encendido para confirmar y, después de modificar los 4 valores de la contraseña, saldrá automáticamente del modo de configuración y la contraseña entrará en vigencia.

*HAPPY RIDING*

***ANGWATT***